

NEW MEXICO OIL CONSERVATION COMMISSION
Santa Fe, New Mexico

NOTICE OF INTENTION TO DRILL OR RECOMPLETE

Notice must be given to the District Office of the Oil Conservation Commission and approval obtained before drilling or recompleting begins. If changes in the proposed plan are considered advisable, a copy of this notice showing such changes will be returned to the sender. Submit this notice in **QUINTUPLICATE**. One copy will be returned following approval. See additional instructions in Rules and Regulations of the Commission.

Midland, Texas

(Place)

March 28, 1955

(Date)

OIL CONSERVATION COMMISSION
SANTA FE, NEW MEXICO

Gentlemen:

You are hereby notified that it is our intention to commence the (Drilling) (~~Recompletion~~) of a well to be known as

The Superior Oil Company

(Company or Operator)

State "335"

(Lease)

2-335

0

(Unit)

located **2310** feet from the **East** line and **660** feet from the

South

line of Section **19**

T. **13-S**

R. **32-E**, NMPM.

(GIVE LOCATION FROM SECTION LINE)

Undesignated

Pool,

Lea

County

If State Land the Oil and Gas Lease is No. **E-8005-1**

If patented land the owner is **-----**

Address **Rotary Rig**

We propose to drill well with drilling equipment as follows: **Rotary Rig**

The status of plugging bond is **active**

Drilling Contractor **Unknown at this time**

We intend to complete this well in the **Open End** formation at an approximate depth of **3050'** feet.

CASING PROGRAM

We propose to use the following strings of Casing and to cement them as indicated:

Size of Hole	Size of Casing	Weight per Foot	New or Second Hand	Depth	Sacks Cement
12-1/4"	9-5/8"	32#	New	350'	Will circulate
8-3/4"	7"	20#	New	3050'	150 sax

If changes in the above plans become advisable we will notify you immediately.

ADDITIONAL INFORMATION (If recompleting give full details of proposed plan of work.)

Approved _____, 19_____
Except as follows:

OIL CONSERVATION COMMISSION

By **J. G. Stanley**
Title _____

Sincerely yours,

THE SUPERIOR OIL COMPANY

(Company or Operator)

By **L. J. Willis (L.J. Willis)**

Position **Petroleum Engineer**
Send Communications regarding well to

Name **J. E. Beakey**

Address **The Superior Oil Company**

Midland, Texas

W. W. STUDDERT
MEMBER
AMERICAN SOCIETY OF
CIVIL ENGINEERS

REGISTERED ENGINEERS
& LAND SURVEYORS

ARIZONA
COLORADO
IDAHO
LOUISIANA
MONTANA
NEVADA
NEW MEXICO
OKLAHOMA
TEXAS
UTAH
WYOMING

STUDDERT ENGINEERING CO.

CIVIL ENGINEERS

TELEPHONES 4-8692 & 2-1373

221 SOUTH COLORADO
MIDLAND, TEXAS

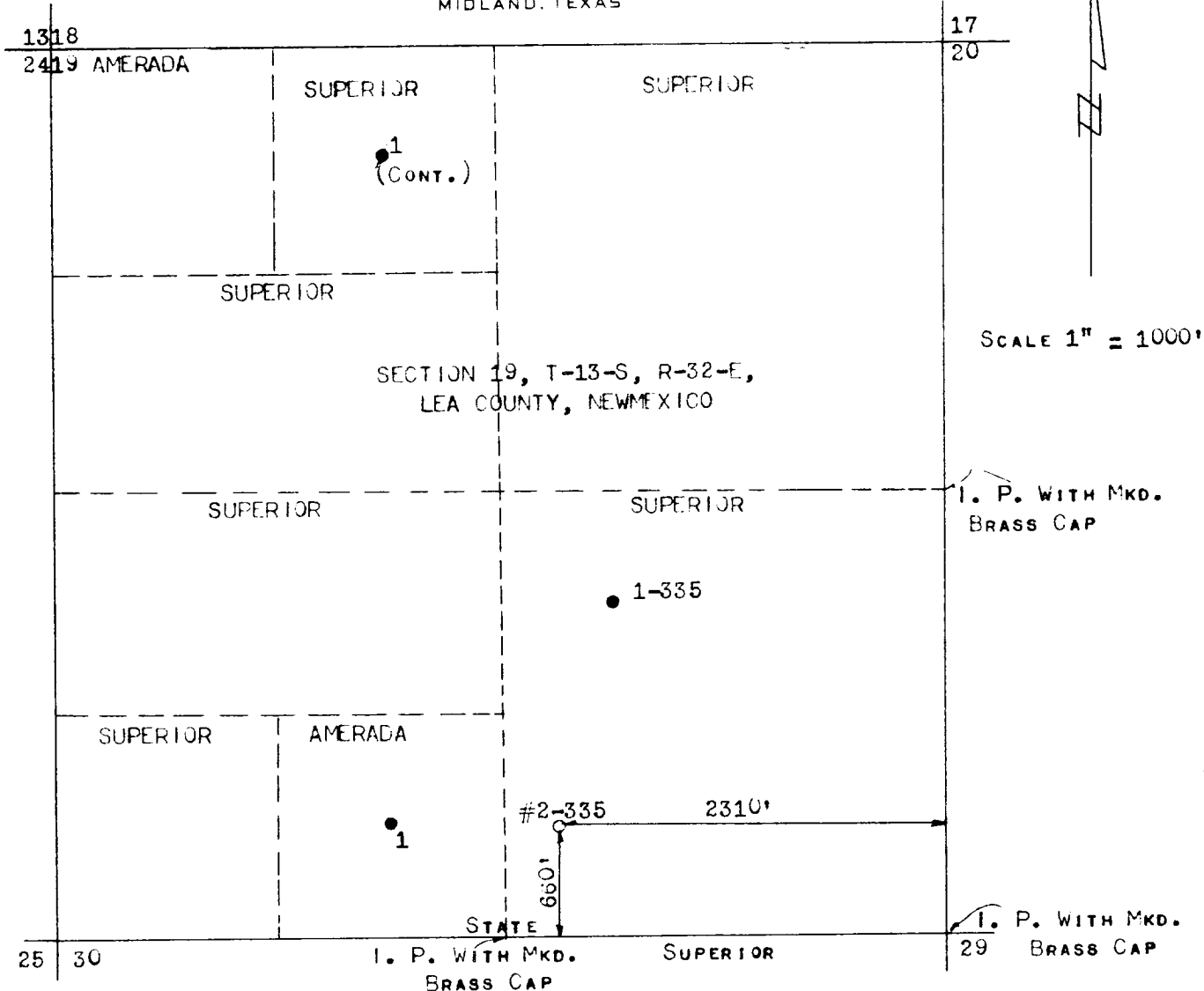

I, EARL K. MONTEITH, LICENSED LAND SURVEYOR # 1317, STATE OF NEW MEXICO,
HEREBY CERTIFY THAT THIS WELL LOCATION: SUPERIOR-STATE #2-335, 2310' FROM
THE EAST LINE, 660' FROM THE SOUTH LINE, SECTION 19, T-13-S, R-32-E, LEA
COUNTY, NEW MEXICO, WAS STAKED ON THE GROUND UNDER MY SUPERVISION AND
THAT THIS PLAT IS TRUE AND CORRECT. MARCH 27, 1955

EARL K. MONTEITH