

NEW MEXICO OIL CONSERVATION COMMISSION

Santa Fe, New Mexico

NOTICE OF INTENTION TO DRILL OR RECOMPLETE

Notice must be given to the District Office of the Oil Conservation Commission and approval obtained before drilling or recompletion begins. If changes in the proposed plan are considered advisable, a copy of this notice showing such changes will be returned to the sender. Submit this notice in **QUINTUPLICATE**. One copy will be returned following approval. See additional instructions in Rules and Regulations of the Commission.

Midland, Texas

(Place)

May 18, 1956

(Date)

OIL CONSERVATION COMMISSION
SANTA FE, NEW MEXICO

Gentlemen:

You are hereby notified that it is our intention to commence the (Drilling) (~~Recompletion~~) of a well to be known as

The Superior Oil Company

(Company or Operator)

State "315"

(Lease)

Well No. **3-315**, in **A** The well is

(Unit)

located **990** feet from the **East** line and **660** feet from the

North

line of Section **30**, T. **13-S**, R. **32-E**, NMPM.

(GIVE LOCATION FROM SECTION LINE) **Caprock (Queen)** Pool, **Lea** County

If State Land the Oil and Gas Lease is No. **E-7494**

If patented land the owner is **-----**

Address **-----**

We propose to drill well with drilling equipment as follows: **Rotary Rig**

The status of plugging bond is **Active**

Drilling Contractor **Western Drilling Company**

P. O. Box 1428

Odessa, Texas

We intend to complete this well in the **Queen sand** formation at an approximate depth of **3100** feet.

CASING PROGRAM

We propose to use the following strings of Casing and to cement them as indicated:

Size of Hole	Size of Casing	Weight per Foot	New or Second Hand	Depth	Sacks Cement
12-1/4"	9-5/8"	32#	New	375'	250
8-3/4"	7"	20#	New	3070'	150

If changes in the above plans become advisable we will notify you immediately.

ADDITIONAL INFORMATION (If recompletion give full details of proposed plan of work.)

Approved **MAY 22 1956**, 19.....
Except as follows:

Sincerely yours,

The Superior Oil Company
(Company or Operator)

By **L. J. Willis (L.J. Willis)**

Position **Petroleum Engineer**

Send Communications regarding well to

Name **J. E. Beakey**

Address **Midland, Texas**

OIL CONSERVATION COMMISSION

By **[Signature]**

Title **Engineer District I**

NEW MEXICO
OIL CONSERVATION COMMISSION

Form C-128

Well Location and/or Gas Proration Plat

Date May 19, 1956

Operator The Superior Oil Company Lease State #315

Well No STATE #3-315 Section 30 Township 13 SOUTH Range 32 EAST NMPM

Located 660 Feet From NORTH Line, 990 Feet From EAST Line,

LEA County, New Mexico. G. L. Elevation 4375' KB (Estimated)

Name of Producing Formation Queen sand Pool Caprock / (Queen) Dedicated Acreage 40

(Note: All distances must be from outer boundaries of Section)

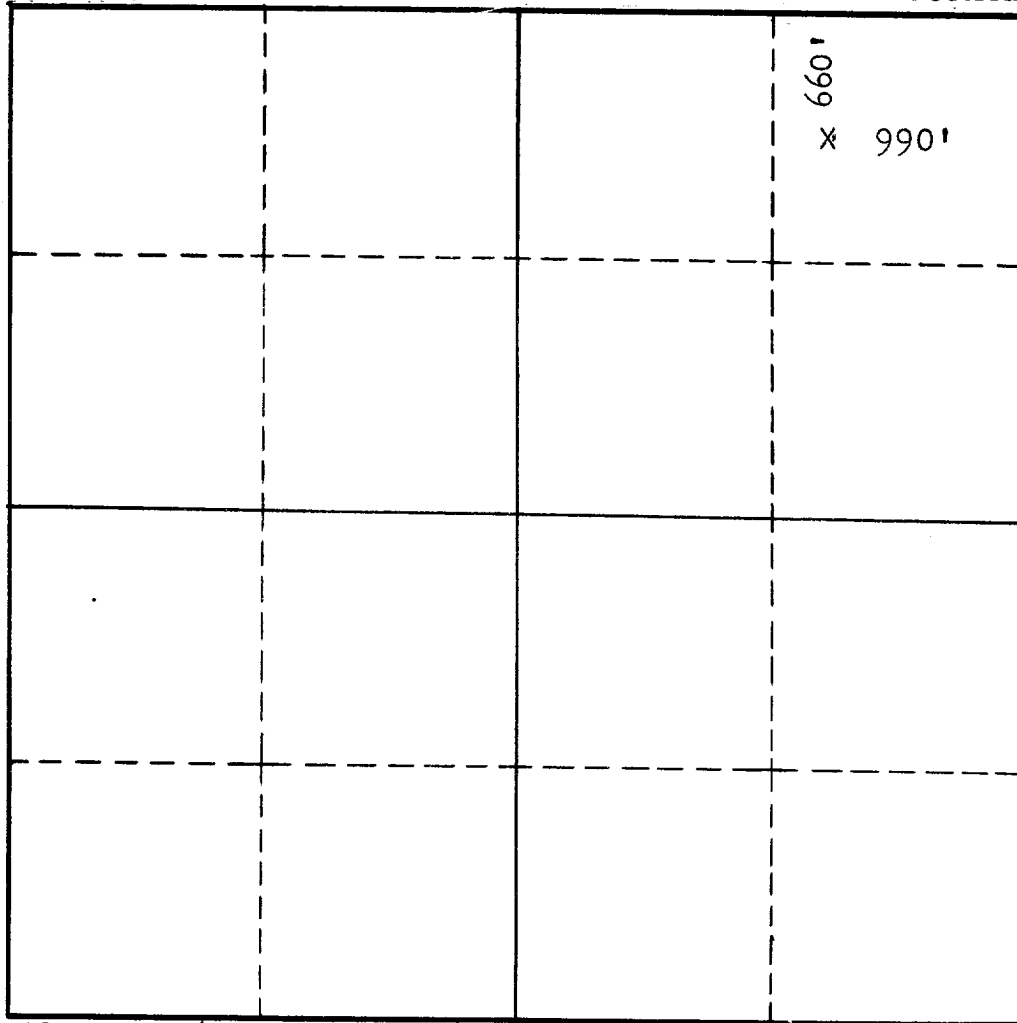

SCALE: 1"=1000'

1. Is this Well a Dual Comp.? Yes No X.
2. If the answer to Question 1 is yes, are there any other dually completed wells within the dedicated acreage? Yes No .

This is to certify that the above plat was prepared from field notes of actual surveys made by me or under my supervision and that the same are true and correct to the best of my knowledge and belief.

Name L. J. Willis (L.J. Willis)
Position Petroleum Engineer
Representing The Superior Oil Company
Address Midland, Texas

Date Surveyed MAY 18, 1956
[Signature]
Registered Professional Engineer and/or
Land Surveyor

W. W. STUDDERT
MEMBER
AMERICAN SOCIETY OF
CIVIL ENGINEERS

MUTUAL
TELEPHONES 4-8682 & 2-1373

STUDDERT ENGINEERING CO.
CIVIL ENGINEERS
221 SOUTH COLORADO
MIDLAND, TEXAS

REGISTERED ENGINEERS
& LAND SURVEYORS

ARIZONA
COLORADO
IDAHO
LOUISIANA
MONTANA
NEVADA
NEW MEXICO
OKLAHOMA
TEXAS
UTAH
WYOMING

HOBBS OFFICE OCC
MAY 22 AM 9:55

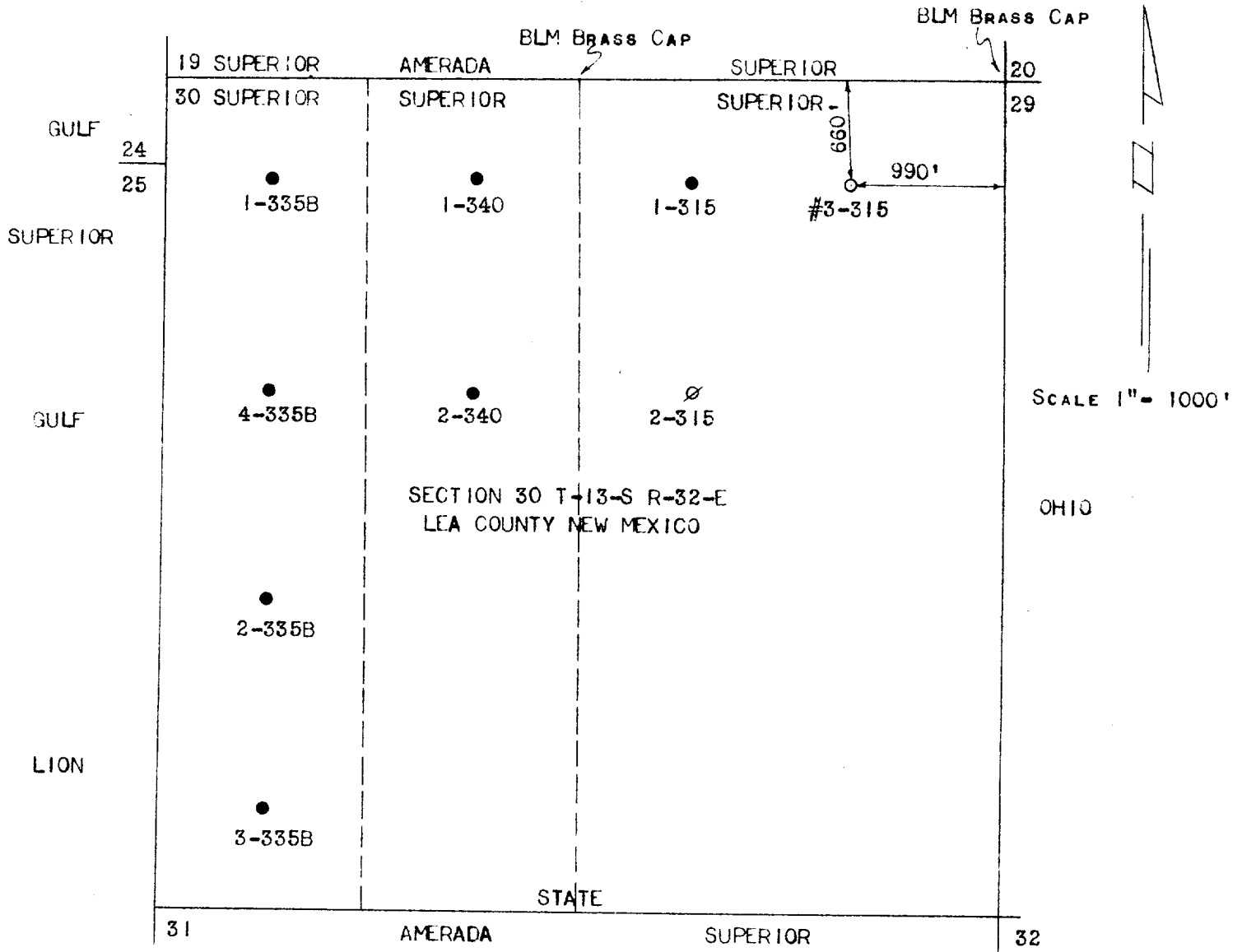

W W STUDDERT, REGISTERED LAND SURVEYOR # 388 STATE OF NEW MEXICO HEREBY CERTIFIES THAT THIS WELL LOCATION WAS STAKED ON THE GROUND UNDER HIS SUPERVISION AND THAT THIS PLAT IS TRUE AND CORRECT.

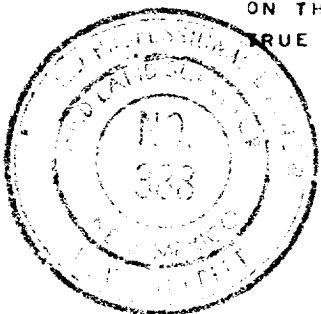

W. W. Studdert
W. W. STUDDERT

MAY 18, 1956