

DUPLICATE

NEW MEXICO OIL CONSERVATION COMMISSION
Santa Fe, New Mexico

NOTICE OF INTENTION TO DRILL OR RECOMPLETE

Notice must be given to the District Office of the Oil Conservation Commission and approval obtained before drilling or recompletion begins. If changes in the proposed plan are considered advisable, a copy of this notice showing such changes will be returned to the sender. Submit this notice in **QUINTUPLICATE**. One copy will be returned following approval. See additional instructions in Rules and Regulations of the Commission.

Midland, Texas

(Place)

January 23, 1956

(Date)

OIL CONSERVATION COMMISSION
SANTA FE, NEW MEXICO

Gentlemen:

You are hereby notified that it is our intention to commence the (Drilling) ~~0300000000~~ of a well to be known as

United States Smelting Refining and Mining Company

(Company or Operator)

Superior-State

(Lease)

Well No. **1**, in **"T"** The well is

(Unit)

located **2310** feet from the **North** line and **2310** feet from the

West

line of Section **34**, T **-13-S**, R **-32-E**, NMPM.

(GIVE LOCATION FROM SECTION LINE) **Wildcat** Pool, **Lee** County

If State Land the Oil and Gas Lease is No. **E-7831-1**

If patented land the owner is **-**

Address **-**

We propose to drill well with drilling equipment as follows: **Rotary**

The status of plugging bond is **Blanket Drilling Bond on file.**

Policy No. SY-203543, American Employers Insurance Co.

Drilling Contractor **Lee Brown Drilling Company**

Fort Worth, Texas

We intend to complete this well in the **Devonian**

formation at an approximate depth of **12,600** feet.

CASING PROGRAM

We propose to use the following strings of Casing and to cement them as indicated:

Size of Hole	Size of Casing	Weight per Foot	New or Second Hand	Depth	Sacks Cement
17-1/2"	13-3/8"	48#	New	400'	500
12-1/4"	9-5/8"	36# & 40#	New	4000'	2000
8-3/4"	5-1/2"	17# & 20#	New	12600'	750

If changes in the above plans become advisable we will notify you immediately.

ADDITIONAL INFORMATION (If recompletion give full details of proposed plan of work.)

Note: Mr. Glenn Staley will furnish location plate to your office.

Approved **JAN 26 1956**, 19.....
Except as follows:

OIL CONSERVATION COMMISSION

By **P. M. Kelly**

Title **Engineer District**

Sincerely yours,

United States Smelting Refining & Mining Co.
(Company or Operator)

By **George J. Erickson**

Position **Assistant to Manager**
Send Communications regarding well to

Name **United States Smelting Refining & Mining Co.**

Address **P. O. Box 1877**

Midland, Texas

NEW MEXICO
OIL CONSERVATION COMMISSION

Form C-128

Well Location and/or Gas Proration Plat

United States Smelting, Refining & Mining Co.

Date 1/26/56

Operator _____ Lease Superior State

Well No. 1 Section 34 Township 13 S Range 32 E NMPM

Located 2310' Feet From N Line, 2310' Feet From W Line,

Lea County, New Mexico. G. L. Elevation _____

Name of Producing Formation _____ Pool _____ Dedicated Acreage _____

(Note: All distances must be from outer boundaries of Section)

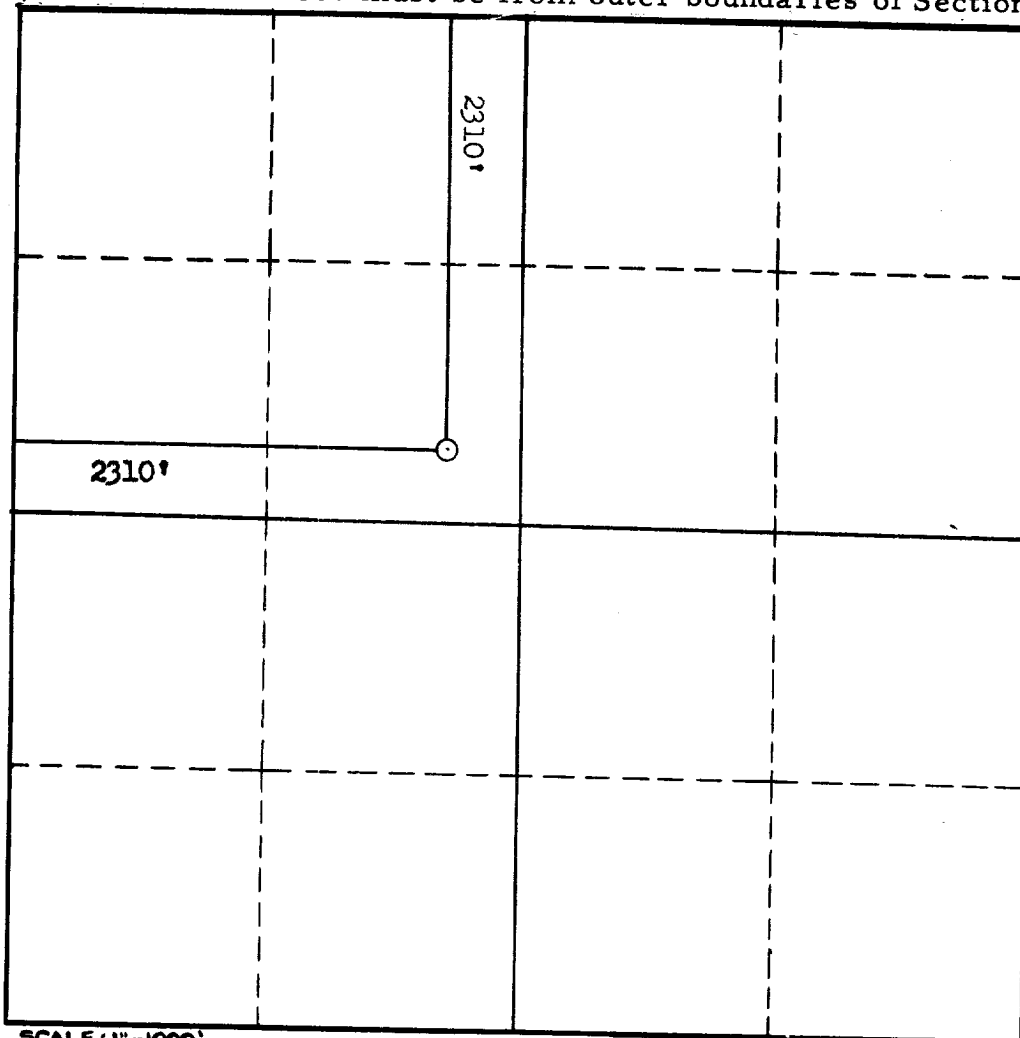

SCALE: 1"=1000'

1. Is this Well a Dual Comp. ? Yes No .
2. If the answer to Question 1 is yes, are there any other dually completed wells within the dedicated acreage? Yes No .

This is to certify that the above plat was prepared from field notes of actual surveys made by me or under my supervision and that the same are true and correct to the best of my knowledge and belief.

Name _____
Position _____
Representing _____
Address _____

Date Surveyed 1/26/56
Glenn Staty
Registered Professional Engineer and/or
Land Surveyor