

NEW MEXICO OIL CONSERVATION COMMISSION
Santa Fe, New Mexico

Form O-101
Revised (12/1/55)

NOTICE OF INTENTION TO DRILL

Notice must be given to the District Office of the Oil Conservation Commission and approval obtained before drilling or recompletion begins. If changes in the proposed plan are considered advisable, a copy of this notice showing such changes will be returned to the sender. Submit this notice in QUINTUPPLICATE. One copy will be returned following approval. See additional instructions in Rules and Regulations of the Commission. If State Land submit 6 Copies Attach Form O-128 in triplicate to first 3 copies of form O-101

Midland, Texas

(Place)

December 28, 1959

(Date)

OIL CONSERVATION COMMISSION
SANTA FE, NEW MEXICO

Humble Lse. No. None

Gentlemen:

You are hereby notified that it is our intention to commence the Drilling of a well to be known as

Humble Oil & Refining Company

(Company or Operator)

New Mexico State "BD"

(Lease)

Well No. 1, in N The well is

(Unit)

located 1980 feet from the West line and 660 feet from the

South line of Section 34, T. 13-S, R. 32-E, NMPM.

(GIVE LOCATION FROM SECTION LINE) Gross Wildcat Pool, Lea County

If State Land the Oil and Gas Lease is No. E-7831

If patented land the owner is

Address

We propose to drill well with drilling equipment as follows: rotary

The status of plugging bond is on file w/Commission

Drilling Contractor unknown

We intend to complete this well in the Devonian

formation at an approximate depth of 12,100 feet

D	C	B	A
E	F	G	H
L	K	J	I
M	N XXX	O	P

See attached plat

CASING PROGRAM

We propose to use the following strings of Casing and to cement them as indicated:

Size of Hole	Size of Casing	Weight per Foot	New or Second Hand	Depth	Sacks Cement
17 1/2"	13-3/8	48#	New	350	200 sks *
12 1/4"	9-5/8	36-40#	New	4400	700 sks **
8-3/4"	5 1/2" or 7"	17# or 29 & 32#	New	12,100	200 sks ***

If changes in the above plans become advisable we will notify you immediately.

ADDITIONAL INFORMATION (If recompletion give full details of proposed plan of work.)

*Circulate to surface.

HOWCO method of cementing to be used.

**Circulate to 13-3/8" csg.

Estimated TD 12,100 to test the Devonian formation.

***Circulate to approximately 600' above top of uppermost pay zone.

Approved: 1959, 19

Except as follows:

Sincerely yours,

HUMBLE OIL & REFINING COMPANY

(Company or Operator)

By

Position Div. Adm.

Send Communications regarding well to

Name Humble Oil & Refining Co.

Address Box 1600, Midland, Texas

OIL CONSERVATION COMMISSION

By

NEW MEXICO OIL CONSERVATION COMMISSION

Well Location and Acreage Dedication Plat

Section A.

Date 12-23-59

Operator HUMBLE OIL & REFG. CO Lease New Mexico State "BD"
Well No. "I" Unit Letter "N" Section 34 Township 13S Range 32E4 NMPM
located 1980 Feet From West Line, 660 Feet From 50 Line
County Lea G. L. Elevation Later Dedicated Acreage 40 Acres
Name of Producing Formation Devonian Pool Gross Field

1. Is the Operator the only owner* in the dedicated acreage outlined on the plat below?
Yes ☒ No ☐.
2. If the answer to question one is "no," have the interests of all the owners been consolidated by communitization agreement or otherwise? Yes ☐ No ☐. If answer is "yes," Type of Consolidation _____
3. If the answer to question two is "no," list all the owners and their respective interests below:

Owner

Land Description

Section B

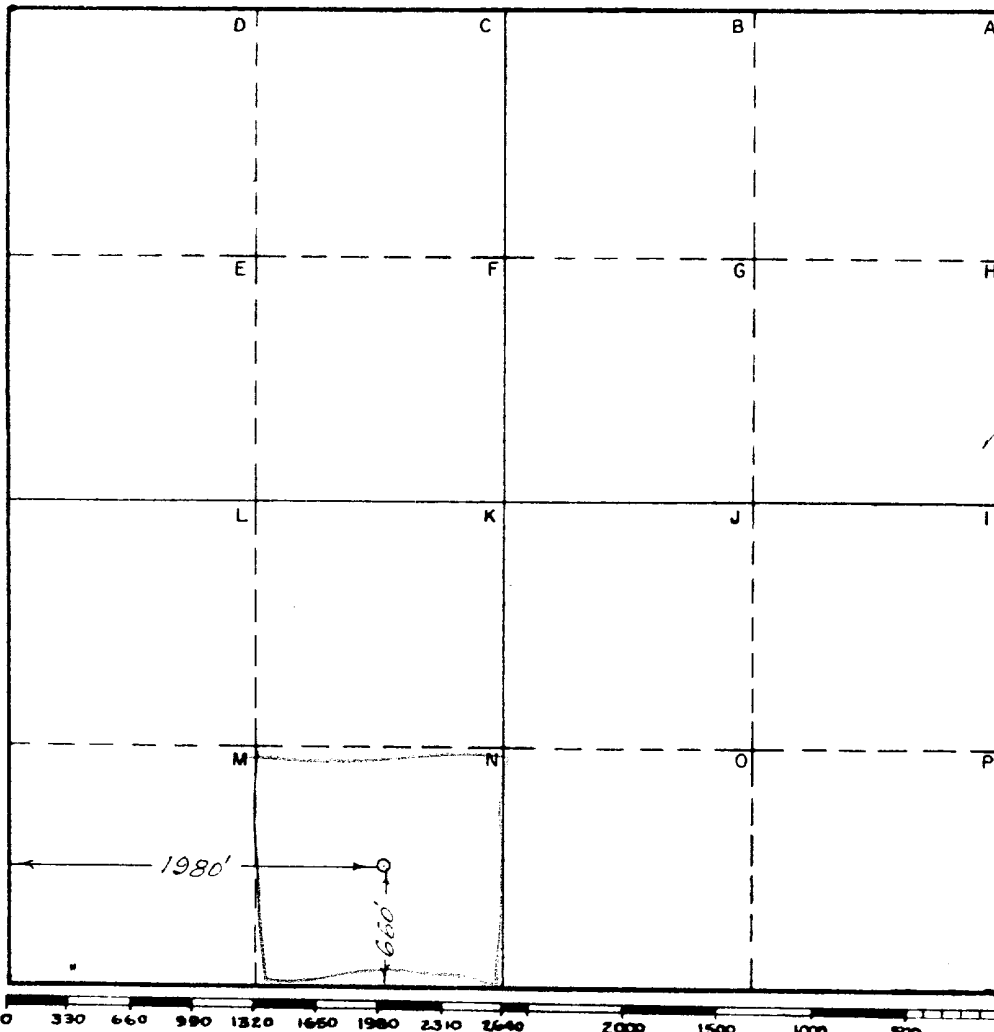

This is to certify that the information in Section A above is true and complete to the best of my knowledge and belief.

HUMBLE OIL & REFG. CO
(Operator)

W. S. Borchardt
(Representative)

Box 1600 Midland, Texas
Address

This is to certify that the well location shown on the plat in Section B was plotted from field notes of actual surveys made by me or under my supervision and that the same is true and correct to the best of my knowledge and belief.

Date Surveyed 12-23-59

W. S. Borchardt
Registered Professional
Engineer and/or Land Surveyor.

Certificate No. 1388

FILE NO. W-A - 2816

LEASE NO. E-7831

Champlin Ref.

U S Smelting

Seaboard &
Sunray
Mid-Cont.

State 28

State

27 26 State

Phillips 33

Humble
St. Lse. No. E-7831
"BD"
640 Ac Lse

34 35
Magnolia

Humble

U S Smelting -
Superior

T-13-S

R-32-E

Atlantic

UNIT "N" 40 Ac.

1980'

660'

State

State

State

Humble 4

Humble

3 2 Champlin

State

State

State

THIS APPLICATION FOR WELL NO. 1

NEW MEXICO STATE "BD" LSE NO. E-7831
(State)

SEC. 35, T-13-S, R-32-E, LEA CO. NEW MEXICO

HUMBLE OIL & REFINING COMPANY

PRODUCTION DEPARTMENT
MIDLAND, TEXAS

CIVIL ENG. DIV.

SCALE 1"=1000'

PRIMARY DESIGN BY

DATE 12-21-59

DRAWN BY

H. M. Selby

CHECKED BY

D. K. Moffatt

APPROVED BY

CIVIL ENG. DIV.
FILE NO.

REVISED

W-A2816

Gross Field

Loc. in ACME Map - 100' x 100' = 1" = 1000'



© Copyrighted Reproduction Prohibited

STATE NM

API MN 00320

MAP

CO-ORD

7-1-8 NM

REPD 11-19-80 REP 2-11-81

WELL CLASS: INIT UD FIN U LSE. CODE

FORMATION	DATUM	FORMATION
-----------	-------	-----------

P8D

(Devonian) OH 12,450-837; WATER DISPOSAL WELL

OPRSELEV 4328 GL, 4343 KB sub-s 14

COMPLETION ISSUED

IC 30-025-70429-80