

NEW MEXICO OIL CONSERVATION COMMISSION

Santa Fe, New Mexico

NOTICE OF INTENTION TO DRILL

Notice must be given to the Oil Conservation Commission or its proper agent and approval obtained before drilling begins. If changes in the proposed plan are considered advisable, a copy of this notice showing such changes will be returned to the sender. Submit this notice in triplicate. One copy will be returned following approval. See additional instructions in Rules and Regulations of the Commission.

Midland, Texas

December 3, 1951

Place

Date

OIL CONSERVATION COMMISSION,
Santa Fe, New Mexico,

Gentlemen:

You are hereby notified that it is our intention to commence the drilling of a well to be known as The

Atlantic Refining Company

State NMWell No. 1in NW 1/4 of SE 1/4

Company or Operator

Lease

of Sec. 10, T. 14S, R. 33E, N. M., P. M., Saunders Field, Lea County.

N

The well is 1980 feet (N.) 75 of the South line and 1980 feet
(E.) (W.) of the East line of Section 10

(Give location from section or other legal subdivision lines. Cross out wrong directions.)

If state land the oil and gas lease is No. B-9471 Assignment No. _____

If patented land the owner is _____

Address _____

If government land the permittee is _____

Address _____

The lessee is _____

Address _____

AREA 640 ACRES

LOCATE WELL CORRECTLY

from surface to total depth of 10,000 feet.

We propose to drill well with drilling equipment as follows: rotary tools

The status of a bond for this well in conformance with Rule 39 of the General Rules and Regulations of the Commission is as follows: Bond No. 44120 (General Casualty Co. of America) in effect.

We propose to use the following strings of casing and to land or cement them as indicated:

Size of Hole	Size of Casing	Weight Per Foot	New or Second Hand	Depth	Landed or Cemented	Sacks Cement
17 1/2"	13 3/8"	48#	New	350'	cemented	circulate
12 1/2"	9 5/8"	36# and 40#	New	4200'	cemented	2,000
8 3/4"	7"	23#, 26# & 29#	New	10,000'	cemented	850

If changes in the above plan become advisable we will notify you before cementing or landing casing. We estimate that the first productive oil or gas sand should occur at a depth of about 9800 feet.

Additional information: See plat attached.

Approved _____, 19____
except as follows:

Sincerely yours,

The Atlantic Refining Company
Company or Operator

By J. C. Frick
T. C. Frick

Position Division Operations Supervisor

Send communications regarding well to

Name The Atlantic Refining Company

Address Box 871, Midland, Texas

OIL CONSERVATION COMMISSION,

By Roy Yorkrough

Title Oil & Gas Inspector

R-33-~~W~~E

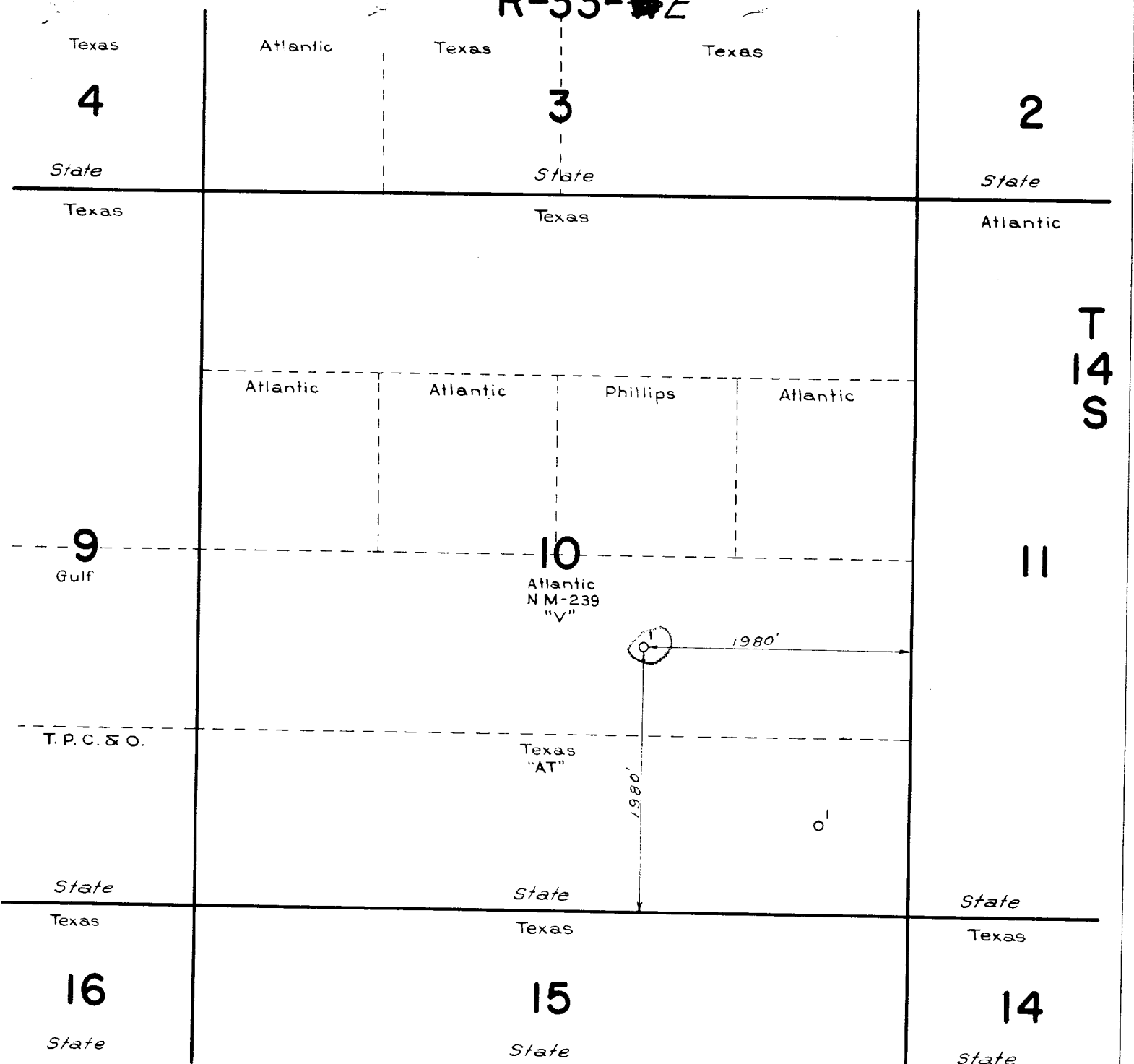

Operator

THE ATLANTIC REFINING COMPANY

Lease

STATE OF NEW MEXICO "V" NO.B-9471

Field

SAUNDERS POOL

Description N/2 of S/2 Sec.10, T-14-S, R-33-~~W~~E, Lea Co., New Mexico

Date

Nov. 29, 1951

NM-239

Scale: 1"=1000'

THE ATLANTIC REFINING COMPANY SURVEYING DEPARTMENT DALLAS, TEXAS	SUR: DRN: J.E.E.	APPROVED: 111 R L L	DATE: 11-29-51 REV:
--	---------------------	------------------------	------------------------