

NOTICE OF INTENTION TO DRILL

Notice must be given to the Chief Office of the Oil Conservation Commission and a survey obtained before drilling or recompletion begins. If changes in the plan become advisable we will notify you immediately. Submit this notice in triplicate. One copy will be retained until approved. See instructions in Rules and Regulations of the Commission. To submit 3 copies of form C-101

November 22, 1961

OIL CONSERVATION COMMISSION
SANTA FE, NEW MEXICO

Gentlemen:

You are hereby notified of our intention to commence the drilling of a well to be known as

TEXACO Inc.

(Company or Operator)

State of New Mexico "B" 100-2, Well No. 1, in (Unit) The well is

located 990 feet from the North line and 983 feet from the East line of Section 18, T. 14-S, R. 33-E, NMPM.

(GIVE LOCATION FROM SECTION LINE) Saunders Wolfcamp Pool, Lea County

If State Land the Oil and Gas Lease is No. B-9560

If patented land the owner is

Address

We propose to drill well with drilling equipment as follows: Rotary

The status of bonding bond \$20,000 blanket surety bond of Maryland Casualty Co. has been filed with State Geologist

Drilling Contractor Not known at present

We intend to complete this well in the Wolfcamp formation at an approximate depth of 10,100 feet.

Oil and Gas Production

We propose to use the following strings of Casing and to cement them as indicated:

Size of Hole	Size of Casing	Weight per Foot	New or Second Hand	Depth	Sacks Cement
13-3/4"	10-3/4"	28.52#	New	370'	300
9-7/8"	7-1/8"	26.40#	New	4150'	850
6-3/4"	4 1/2" liner	11.60#	New	4050' to 10,100'	450*

If changes in the above plans become advisable we will notify you immediately.

*Cement bottom of liner w/250 sx Incor neat & squeeze top of liner w/200 sx Incor neat.

ADDITIONAL INFORMATION (If recompletion give full details of proposed plan of work.) FORMATIONS EXPECTED:

Top of Anhydrite 1642'
" " Yates 2630'
" " San Andres 4100'

Top of Glen Rose 2045'
" " Tubbs 5970'
" " Abo 7770'
" " Wolfcamp 9770'
Total Depth 10,100'

Sincerely yours,

Approved _____, 19____
Except as follows:

TEXACO Inc.
(Company or Operator)
By J. J. Volten
Petroleum Division Civil Engineer
Send Communications regarding well to
Name TEXACO Inc.
Address P. O. Box 3109, Midland, Texas

OIL CONSERVATION COMMISSION

By _____

NEW MEXICO OIL CONSERVATION COMMISSION
WELL LOCATION AND ACREAGE DEDICATION PLAT

FORM C-128
Revised 5/1/57

SEE INSTRUCTIONS FOR COMPLETING THIS FORM ON THE REVERSE SIDE

SECTION A

Operator TEXACO Inc.			Lease State of New Mexico "BG" NCT-2		Well No. 1
Unit Letter A	Section 16	Township 14 South	Range 33 East	County Lea	
Actual Footage Location of Well: 990' feet from the North line and 988' feet from the East line Sec. 16					
Ground Level Elev. 4224'	Producing Formation Wolfcamp		Pool Saunders Wolfcamp	Dedicated Acreage: 40 Acres	

1. Is the Operator the only owner in the dedicated acreage outlined on the plat below? YES ☒ NO ☐ ("Owner" means the person who has the right to drill into and to produce from any pool and to appropriate the production either for himself or for himself and another. (65-3-29 (e) NMSA 1935 Comp.)
2. If the answer to question one is "no," have the interests of all the owners been consolidated by communitization agreement or otherwise? YES ☐ NO ☐ If answer is "yes," Type of Consolidation _____
3. If the answer to question two is "no," list all the owners and their respective interests below:

Owner	Land Description

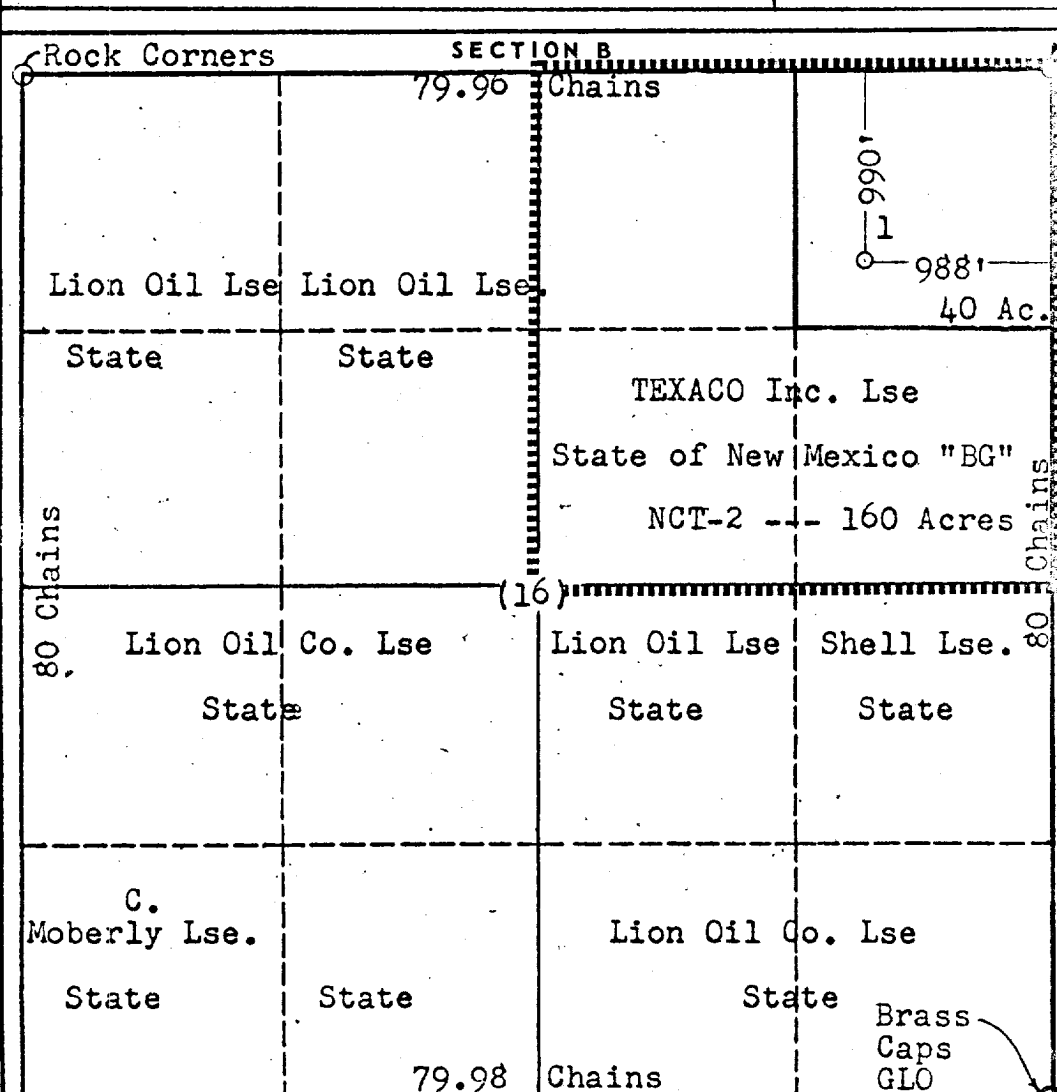

Rock Corners
CERTIFICATION

I hereby certify that the information in SECTION A above is true and complete to the best of my knowledge and belief.

Name J. J. Velten
Position Division Civil Engineer
Company TEXACO Inc.
Date 11/22/61

I hereby certify that the well location shown on the plat in SECTION B was plotted from field notes of actual surveys made by me or under my supervision, and that the same is true and correct to the best of my knowledge and belief.

Date Surveyed 11/21/61
Registered Professional Engineer and/or Land Surveyor J. J. Velten
Certificate No. 8174

0 330 660 990 1320 1650 1980 2310 2640 2000 1500 1000 500 0