

NEW MEXICO OIL CONSERVATION COMMISSION

Well Location and Acreage Dedication Plat

Section A.

Date September 30, 1957

Operator The Texas Company Lease State of New Mexico "AN" 45  
Well No. 3 Unit Letter K Section 22 Township 14-South Range 33 East N.M.P.M.  
Located 1980 Feet From South Line, 1978 Feet From West Line  
County Lea G. L. Elevation 4204.05 Dedicated Acreage 40 Acres  
Name of Producing Formation Lower Wolfcamp Pool Saunders

1. Is the Operator the only owner\* in the dedicated acreage outlined on the plat below?  
Yes X No       .
2. If the answer to question one is "no," have the interests of all the owners been consolidated by communitization agreement or otherwise? Yes        No       . If answer is "yes," Type of Consolidation
3. If the answer to question two is "no," list all the owners and their respective interests below:

Owner

Land Description

Section B

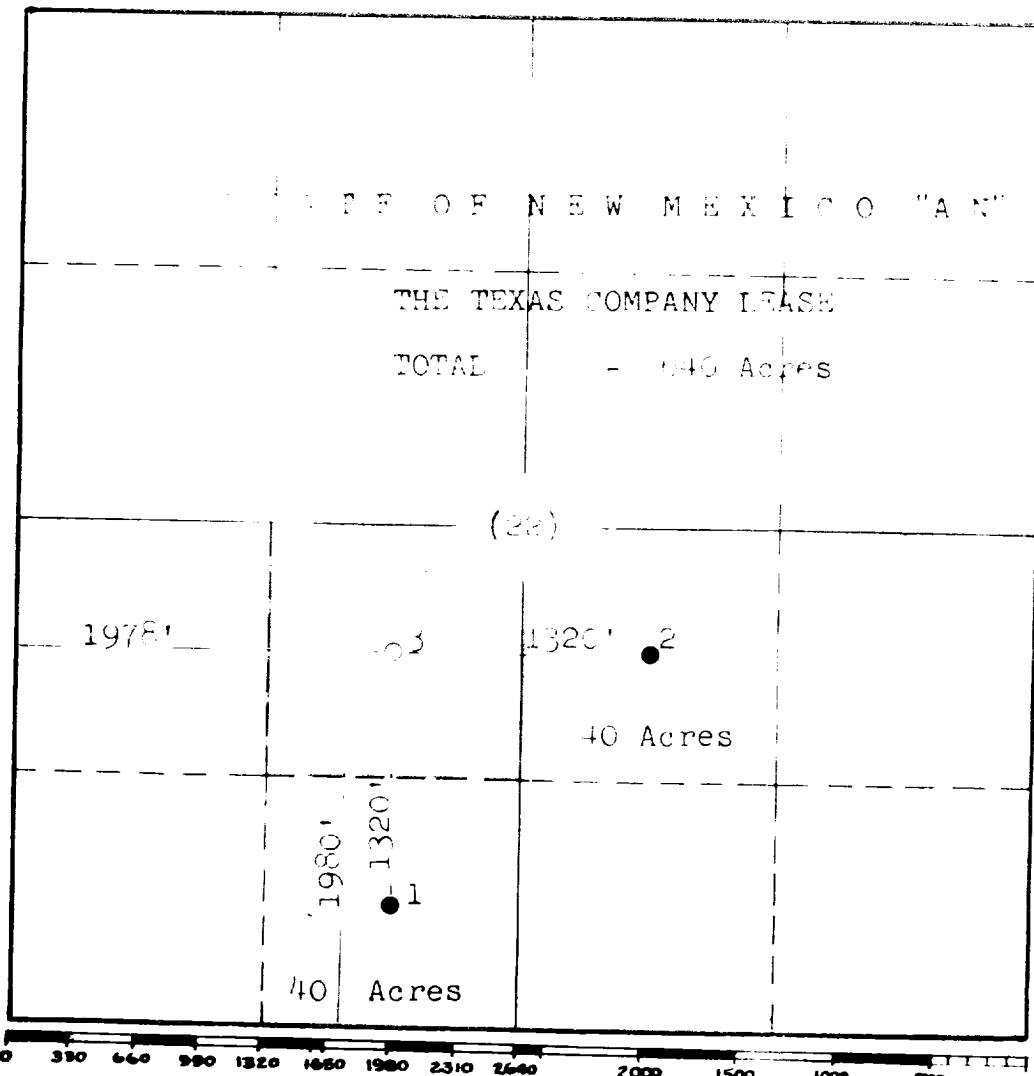

This is to certify that the information in Section A above is true and complete to the best of my knowledge and belief.

THE TEXAS COMPANY

(Operator)

(Representative)

Division Civil Engineer  
P.O. Box 1720; Fort Worth,  
Address Texas

This is to certify that the well location shown on the plat in Section B was plotted from field notes of actual surveys made by me or under my supervision and that the same is true and correct to the best of my knowledge and belief.

Date Surveyed 10/2/57

Registered Professional  
Engineer and/or Land Surveyor.

Certificate No. 2115

(See instructions for completing this plat)