

Lease No. 89019

NEW MEXICO OIL CONSERVATION COMMISSION
Santa Fe, New Mexico

NOTICE OF INTENTION TO DRILL OR RECOMPLETE

Notice must be given to the District Office of the Oil Conservation Commission and approval obtained before drilling or recompletion begins. If changes in the proposed plan are considered advisable, a copy of this notice showing such changes will be returned to the sender. Submit this notice in QUINTUPLICATE. One copy will be returned following approval. See additional instructions in Rules and Regulations of the Commission.

If State Land submit 6 Copies

Fort Worth, Texas

(Place)

August 5, 1958

(Date)

OIL CONSERVATION COMMISSION
SANTA FE, NEW MEXICO

Gentlemen:

You are hereby notified that it is our intention to commence the (Drilling) ~~(Recompletion)~~ of a well to be known as

The Texas Company

(Company or Operator)

State of New Mexico "AN"

(Lease)

Well No. 5

"I"

The well is

located 1980 feet from the South line and 660 feet from the East

East line of Section 22, T. 14-South, R. 330 East, NMPM.

(GIVE LOCATION FROM SECTION LINE)

Saunders

Lea

Pool,

County

If State Land the Oil and Gas Lease is No. B-9385

If patented land the owner is

Address

We propose to drill well with drilling equipment as follows: Rotary

The status of plugging bond is \$10,000 blanket surety bond of Maryland Casualty Co. has been filed with State Geologist.

Drilling Contractor Not known at present

We intend to complete this well in the Lower Wolfcamp formation at an approximate depth of 10,000 feet.

CASING PROGRAM

We propose to use the following strings of Casing and to cement them as indicated:

Size of Hole	Size of Casing	Weight per Foot	New or Second Hand	Depth	Sacks Cement
17-1/2"	13-3/8"	48#	New	350'	350 sx.
11"	8-5/8"	24# & 32#	New	4,170'	2,200 sx.
7-7/8"	5-1/2"	17#	New	10,000'	400 sx.

If changes in the above plans become advisable we will notify you immediately.

ADDITIONAL INFORMATION (If recompletion give full details of proposed plan of work.)

FORMATIONS EXPECTED:

Top of Anhydrite 1,600'	Top of Glorieta 5,620'	Top of Wolfcamp 9,340'
Top of Yates 2,660'	Top of Tubb 7,020'	Total Depth 10,000'
Top of San Andres 4,130'	Top of Abo 7,750'	

Approved....., 19.....
Except as follows:

Sincerely yours,

THE TEXAS COMPANY

(Company or Operator)

By..... J.J. Velten

Position..... Division Civil Engineer

Send Communications regarding well to

Name..... The Texas Company

Address..... P.O. Box 1720, Fort Worth, Texas

OIL CONSERVATION COMMISSION

By..... amm

NE MEXICO OIL CONSERVATION COMMISSION

Well Location and Acreage Dedication Plat

Section A.

Date August 4, 1958

Operator THE TEXAS COMPANY Lease State of New Mexico "AN"
Well No. 5 Unit Letter I Section 22 Township 14 South Range 33 East NMPM
Located 1980 Feet From South Line, 660 Feet From East Line
County Lea G. L. Elevation 4197.8 Dedicated Acreage 40 Acres
Name of Producing Formation Lower Wolfcamp Pool Saunders

1. Is the Operator the only owner* in the dedicated acreage outlined on the plat below?
Yes X No .
2. If the answer to question one is "no," have the interests of all the owners been consolidated by communitization agreement or otherwise? Yes No . If answer is "yes," Type of Consolidation
3. If the answer to question two is "no," list all the owners and their respective interests below:

Owner

Land Description

Section B

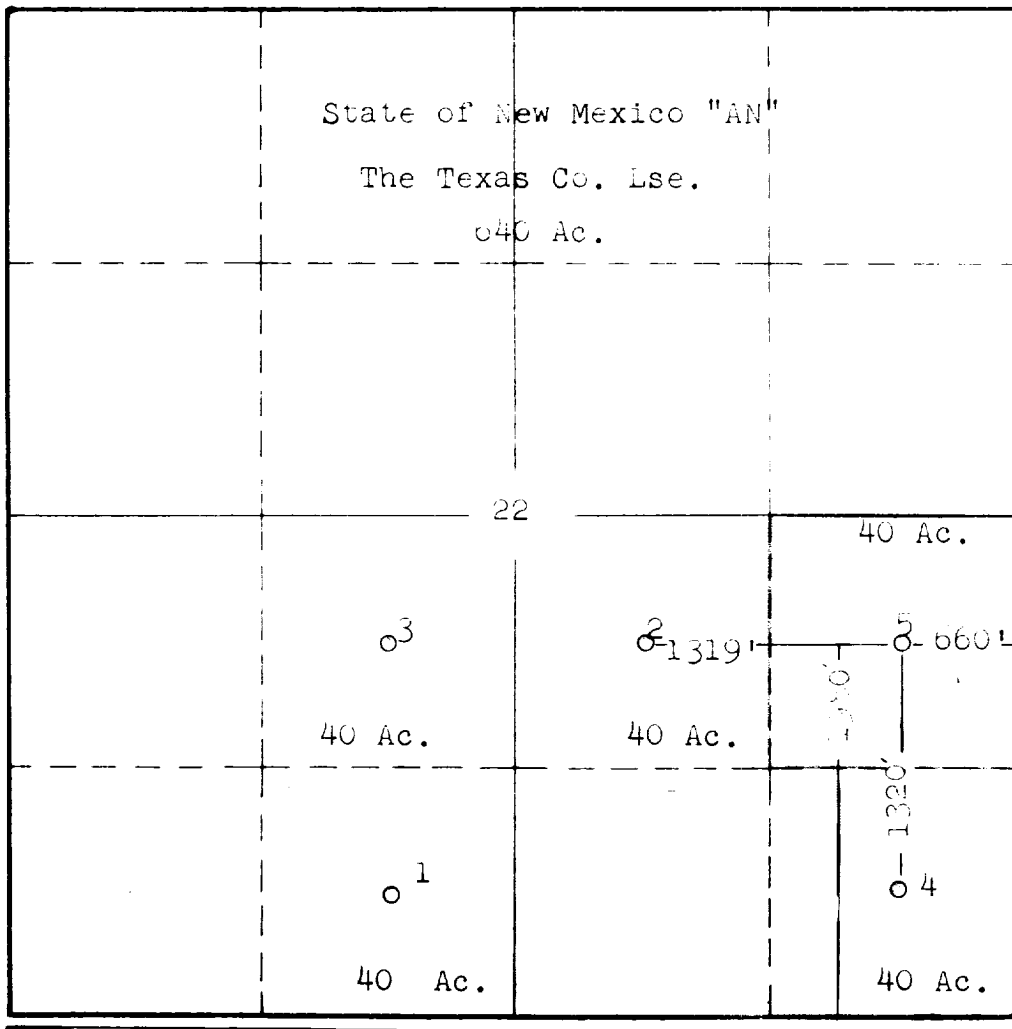

This is to certify that the information in Section A above is true and complete to the best of my knowledge and belief.

THE TEXAS COMPANY

(Operator)

(Representative)

P.O. Box 1720
Fort Worth 1, Texas

Address

This is to certify that the well location shown on the plat in Section B was plotted from field notes of actual surveys made by me or under my supervision and that the same is true and correct to the best of my knowledge and belief.

Date Surveyed

Registered Professional Engineer and/or Land Surveyor.

Certificate No.

(See instructions for completing this form on the reverse side)