

DUPLICATE

NEW MEXICO OIL CONSERVATION COMMISSION

NOTICE OF INTENTION TO DRILL

See Rules 101 and 1104.

If changes in the proposed plan are considered advisable, a copy of this notice showing such changes will be returned to the sender. Submit this notice in triplicate. One copy will be returned following approval.

Hobbs, New Mexico

Place

RECEIVED
OIL CONSERVATION COMMISSION
June 20, 1952
Date

Notice hereby is given that it is our intention to commence the drilling of a well to be known as

Gulf Oil Corporation **Maud Saunders** well No. **3** in **NE SW**
Company or Operator Lease
of Sec. **34**, T. **14-S**, R. **33-E** N. M. P. M. **Saunders** Pool, **Lea** County.

The well is **1980** feet from (**X**) (S.) line and **1980** feet from
(**X**) (W.) line of the above section.

(Give location from section lines. Cross out wrong directions.)

If state land the oil and gas lease is No. Assignment No.

If patented land the owner is **Mrs. Maud Saunders Smith**

Address **Midland, Texas**

If government land the permittee is

Address

The lessee is **Gulf Oil Corporation - Fort Worth Production Div.**

Address **Box 1290, Fort Worth, Texas**

We propose to drill well with drilling equipment as follows:

Rotary Tools - Loffland Brothers Drilling Co.

The status of a bond for this well in conformance with Rule 101 of the General Rules and Regulations of the Commission is as follows:

We propose to use the following strings of casing and to land or cement them as indicated:

| Size of Hole | Size of Casing | Weight Per Foot | New or Second Hand | Depth | Landed or Cemented | Sacks Cement |
|--------------|----------------|-----------------|--------------------|---------|--------------------|--------------|
| 17-1/2" | 13-3/8" | 48# | New | 300' | Cemented | 350 |
| 12-1/4" | 9-5/8" | 40# | New | 4200' | Cemented | 1800 |
| 8-3/4" | 7" | 23-26-29# | New | 10,000' | Cemented | 900 |

If changes in the above plans become advisable, we will notify you before cementing or landing casing. We estimate that the first productive oil or gas sand should occur at a depth of about **9865'** feet.

Additional information:

Approved _____ 1952

except as follows:

OIL CONSERVATION COMMISSION
By **Ray Yarbrough**
Title **Oil & Gas Inspector**

Gulf Oil Corporation

Company or Operator

By **Area Prod. Supt.**

Position **Area Prod. Supt.**

Send communications regarding well to:

Name **Gulf Oil Corporation**

Address **Box 2167, Hobbs, New Mexico**

SECTION PLAT

GULF FW 636

SCALE 1 IN. = 800 FT.

This Plat exhibits the exact location of Gulf Oil Corporation's No. No. 3
Maud Saunders in Sec. 34 Twnsp T-14-S Range R-33-E

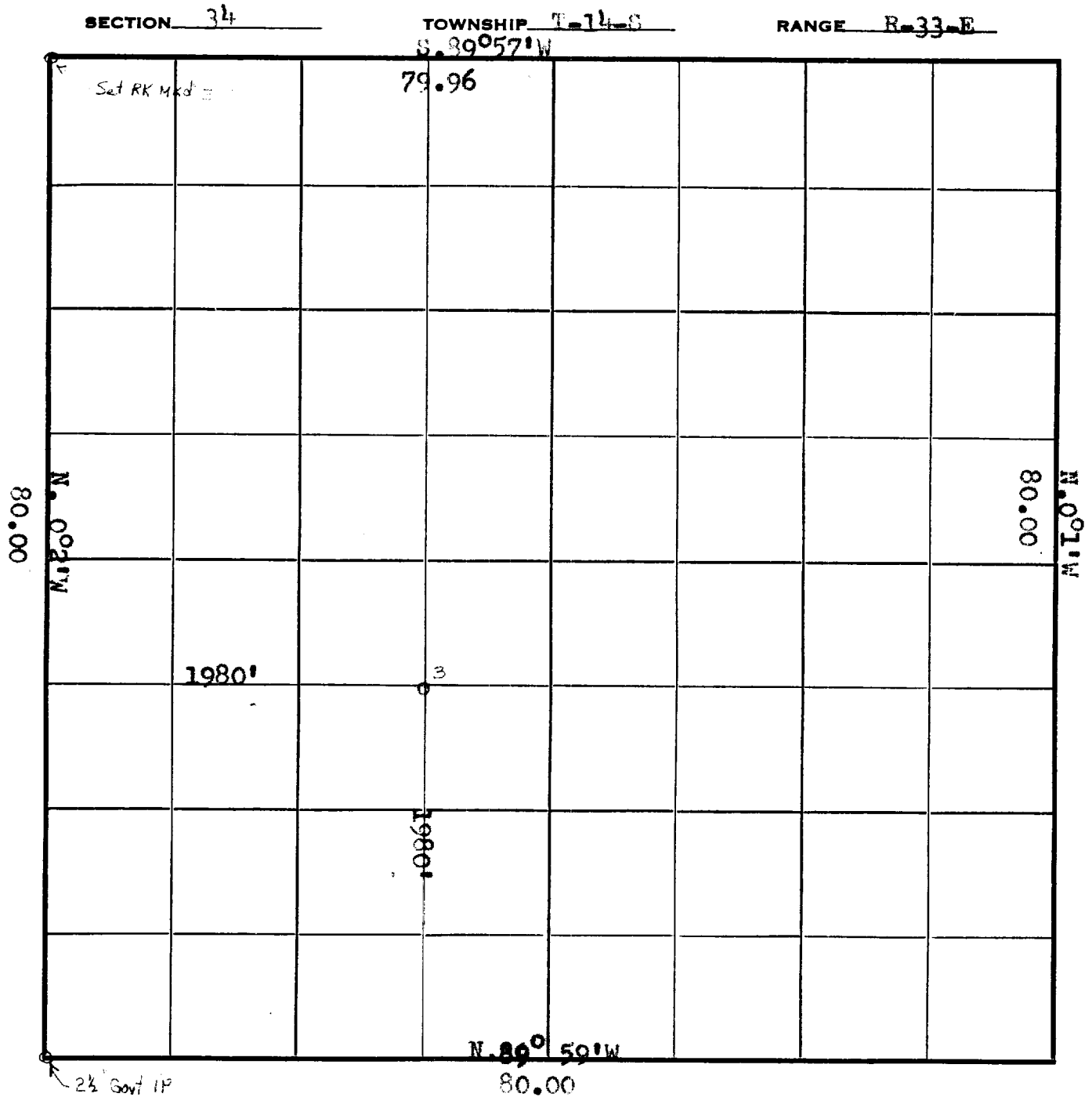

This is to certify that I am a Registered Land Surveyor, that the above plat was prepared under my direction and that the same is true and correct to the best of my knowledge and belief.

J. A. League
 J. A. League

_____ 1900 _____
_____ 1900 _____

_____ 1900 _____
_____ 1900 _____