

COUNTY	LEA	FIELD	Four Lakes	STATE	NM MN 01832
OPR	HUMBLE OIL & REFG. CO.			MAP	
	2 South Four Lakes Unit				
	Sec 2, T-12-S, R-34-E			CO-ORD	
	1980' FNL, 1980' FEL of Sec.				
Re-Cmp 7-18-69		CLASS <i>OWDF</i> EL <span style="background-color: black; color: black;">XXXXXXXXXX</span>			
		FORMATION	DATUM	FORMATION	DATUM
CSG & SX - TUBING					
13 3/8" at 326' w/325 sx					
9 5/8" at 4200' w/2300 sx					
5 1/2" at 12,924' w/1925 sx					
LOGS EL GR RA IND HC A					
		TD 12,924'; PBD 10,350'			
IP (Penn) Perfs 9840-64' F 633 BOPD. Pot based on 24 hr test thru 20/48" chk, TP 125#					
Distribution limited and publication prohibited by subscribers' agreement. Reproduction rights reserved by Williams & Lee Scouting Service, Inc.					
CONT.	PROP DEPTH		9864'	TYPE WO	
DATE					

	F.R.C. 8-21-69
	PD 9864' WO (Penn)
	(Orig. comp. 10-8-56 thru perfs 12,809-859',
	OTD 12,924', OPB 12,881')
8-18-69	TD 12,924'; PBD 10,350'; COMPLETE
	Set BP @ 10,350'
	Perf 9840-64' w/1 SPF
	Acid (9840-64') 1000 gals
8-21-69	COMPLETION REPORTED

Humble Lse. No. 96404  
E-2064, E-2013, E-596, E-677  
State Lse. No. E-937

NEW MEXICO OIL CONSERVATION COMMISSION  
WELL LOCATION AND ACREAGE DEDICATION PLAT

Form C-102  
Supersedes C-128  
Effective 1-1-65

Federal Lse. No. \_\_\_\_\_ All distances must be from the outer boundaries of the Section.

Operator Humble Oil & Refining Co.		Lease South Four Lakes Unit		Well No. 2
Unit Letter G	Section 2	Township 12-S	Range 34-E	County Lea
Actual Footage Location of Well: 1980 feet from the North line and 1980 feet from the East line				
Ground Level Elev. 4156 DF	Producing Formation Pennsylvanian	Pool Four Lakes Penn.	Dedicated Acreage: 80 Acres	

1. Outline the acreage dedicated to the subject well by colored pencil or hachure marks on the plat below.
2. If more than one lease is dedicated to the well, outline each and identify the ownership thereof (both as to working interest and royalty).
3. If more than one lease of different ownership is dedicated to the well, have the interests of all owners been consolidated by communitization, unitization, force-pooling, etc?

☐ Yes ☐ No If answer is "yes," type of consolidation \_\_\_\_\_

If answer is "no," list the owners and tract descriptions which have actually been consolidated. (Use reverse side of this form if necessary.) \_\_\_\_\_

No allowable will be assigned to the well until all interests have been consolidated (by communitization, unitization, forced-pooling, or otherwise) or until a non-standard unit, eliminating such interests, has been approved by the Commission.

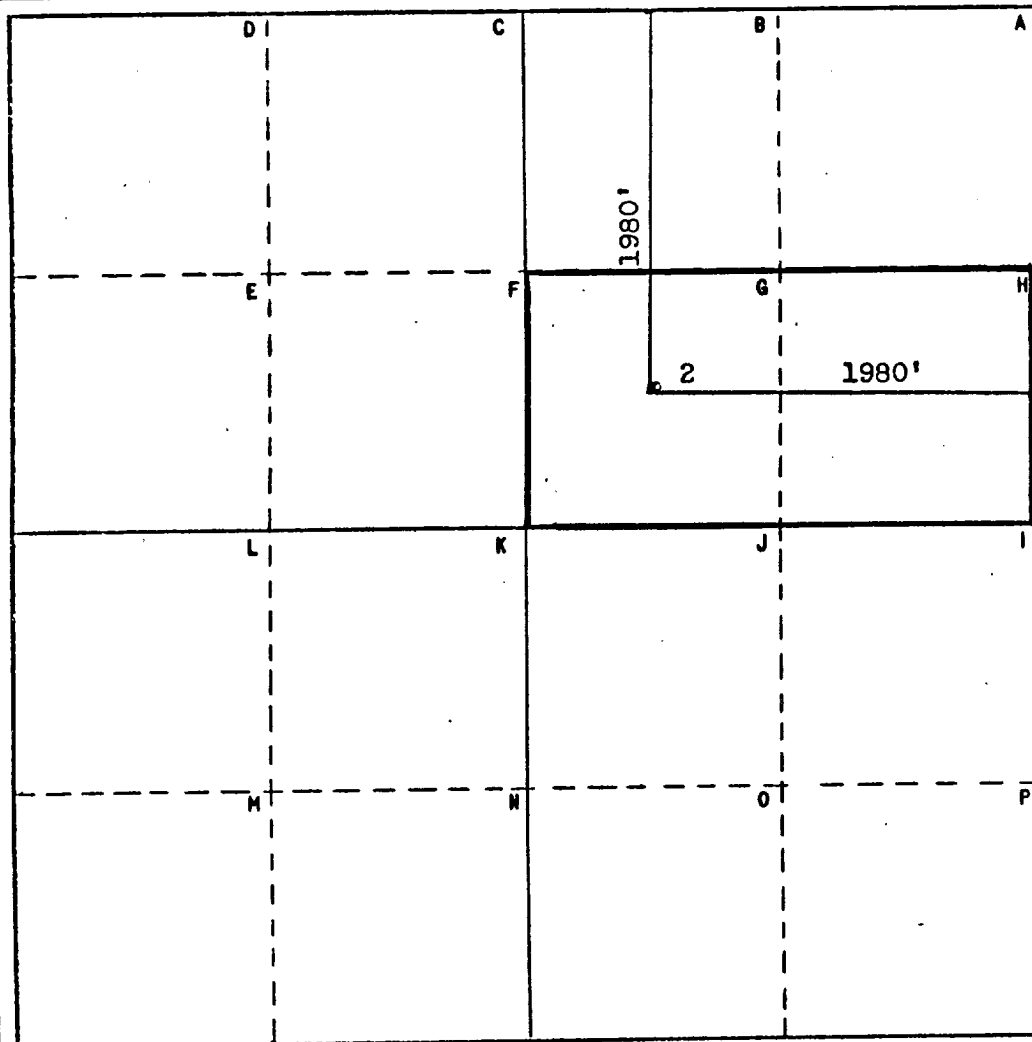

CERTIFICATION

I hereby certify that the information contained herein is true and complete to the best of my knowledge and belief.

*Ch. Edwards*

Name

Position

Proration Supervisor

Company Humble Oil & Refining Co.  
Box 1600 Midland, Texas

Date

7-18-69

I hereby certify that the well location shown on this plat was plotted from field notes of actual surveys made by me or under my supervision, and that the same is true and correct to the best of my knowledge and belief.

Date Surveyed

Registered Professional Engineer  
and/or Land Surveyor

Certificate No.

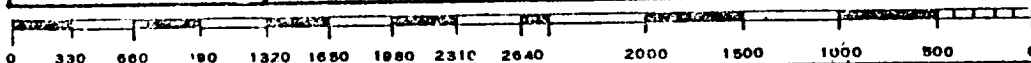

NEW MEXICO OIL CONSERVATION COMMISSION  
Well Location and Acreage Dedication Plat

Section A.

Date April 24, 1959

Operator HUMBLE OIL & REFG. CO Lease South Four Lakes Unit  
Well No. 2 Unit Letter "G" Section 2 Township 12-S Range 34-E NMP  
Located 1980' Feet From North Line, 1980 Feet From East Line  
County Lea G. L. Elevation \_\_\_\_\_ Dedicated Acreage 160 Acre  
Name of Producing Formation Devonian Pool Four Lakes

1. Is the Operator the only owner\* in the dedicated acreage outlined on the plat below?  
Yes \_\_\_\_\_ No \_\_\_\_\_.
2. If the answer to question one is "no," have the interests of all the owners been consolidated by communitization agreement or otherwise? Yes \_\_\_\_\_ No \_\_\_\_\_. If answer is "yes," Type of Consolidation \_\_\_\_\_.
3. If the answer to question two is "no," list all the owners and their respective interests below:

Owner

Land Description

Section B

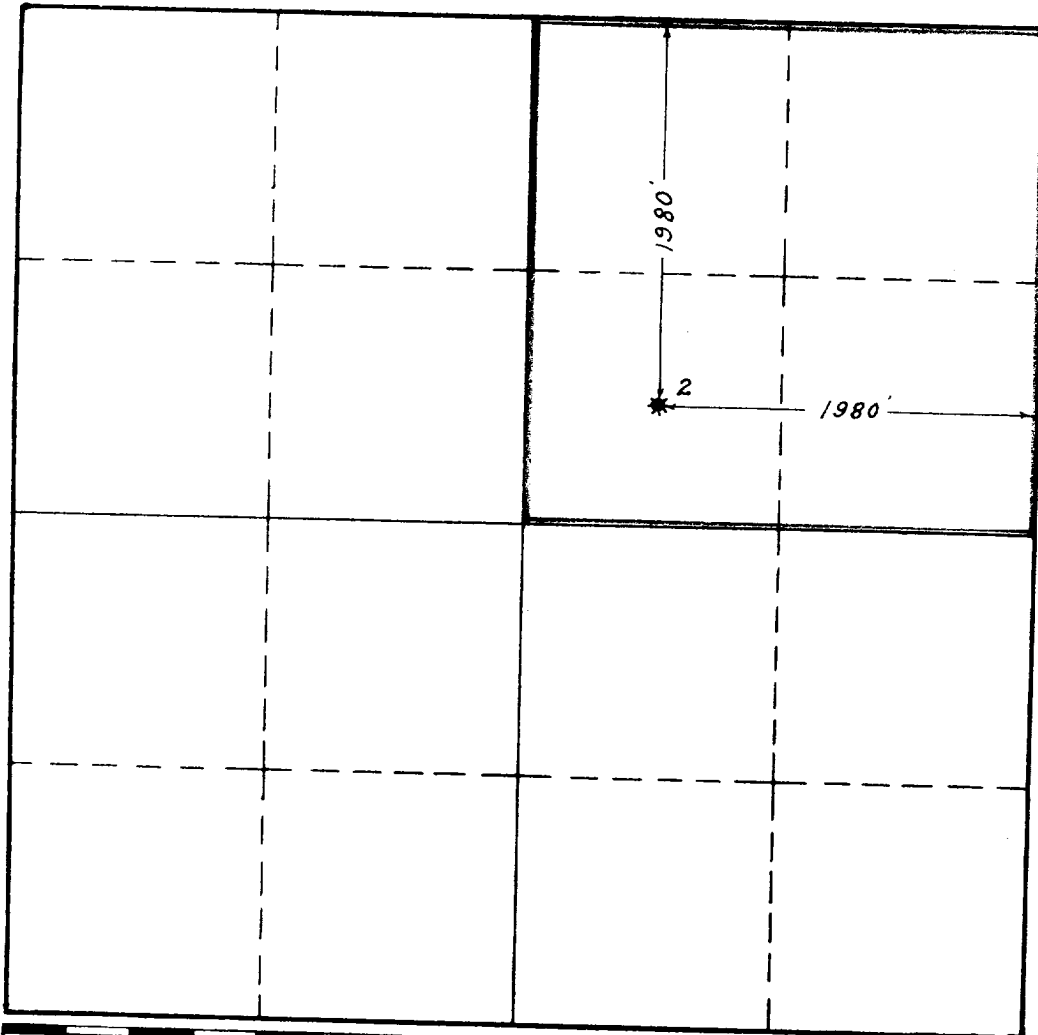

This is to certify that the information in Section A above is true and complete to the best of my knowledge and belief.

HUMBLE OIL & REFG. CO  
(Operator)

Henry E. Meadows  
(Representative)  
Assistant Division Supt.  
Box 1600 Midland, Texas  
Address

This is to certify that the well location shown on the plat in Section B was plotted from field notes of actual surveys made by me or under my supervision and that the same is true and correct to the best of my knowledge and belief.

Date Surveyed 4-22-58

W. A. Whitefield  
Registered Professional  
Engineer and/or Land Surveyor

0 330 660 990 1320 1650 1980 2310 2640 2000 1500 1000 500 0

State Lse. No. E 2064

LEASE NO. 96404

Certificate No. 1382

W-A-2200