

N. MEXICO OIL CONSERVATION COMMISSION
Well Location and Acreage Dedication Plat

Section A.

Date April 17, 1959

Operator HUMBLE OIL & REFG. CO Lease South Four Lakes Unit
Well No. 6 Unit Letter 1 Section 2 Township 12-S. Range 34 E NMPM
Located 1980 Feet From South Line, 660 Feet From East Line
County Lea G. L. Elevation _____ Dedicated Acreage 40 Acres
Name of Producing Formation Pennsylvanian Pool Undesignated

1. Is the Operator the only owner* in the dedicated acreage outlined on the plat below?
Yes ☒ No ☐.
2. If the answer to question one is "no," have the interests of all the owners been consolidated by communitization agreement or otherwise? Yes ☐ No ☐. If answer is "yes," Type of Consolidation _____
3. If the answer to question two is "no," list all the owners and their respective interests below:

Owner

Land Description

<u>Owner</u>	<u>Land Description</u>

Section B

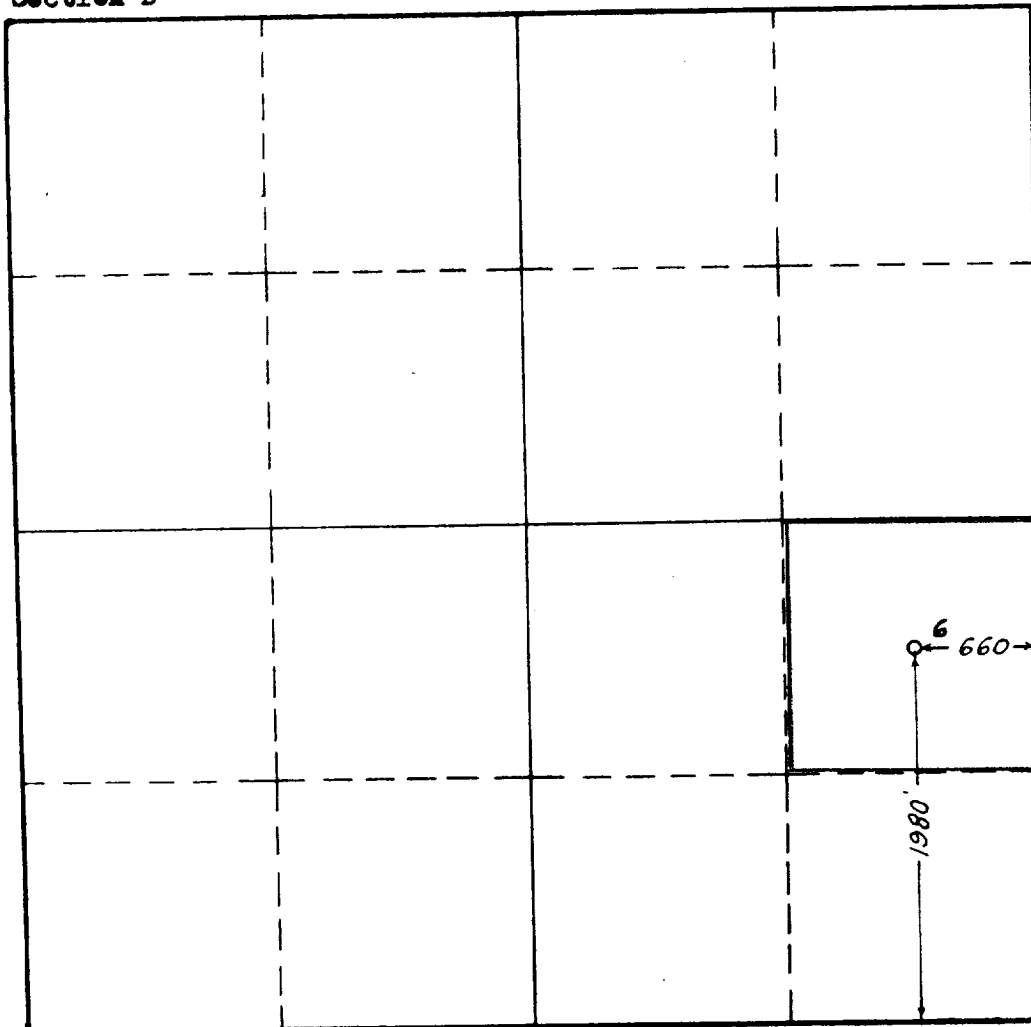

This is to certify that the information in Section A above is true and complete to the best of my knowledge and belief.

HUMBLE OIL & REFG. CO
(Operator)
H. L. Hensley
(Representative)
Assistant Division Supt.
Box 1600 Midland, Texas
Address

This is to certify that the well location shown on the plat in Section B was plotted from field notes of actual surveys made by me or under my supervision and that the same is true and correct to the best of my knowledge and belief.

Date Surveyed 4-22-58

H. L. Hensley
Registered Professional
Engineer and/or Land Surveyor.

0 330 660 990 1320 1650 1980 2310 2640 2000 1500 1000 500 0

State License # E2064

Humble-LEASE NO. 96404-116583
135496-137670

Certificate No. 2156

W-A-2289