

## NOTICE OF INTENTION TO DRILL

Notice must be given to the District Office of the Oil Conservation Commission and approval obtained before drilling or recompletion begins. If changes in the proposed plan are considered advisable, a copy of this notice showing such changes will be returned to the sender. Submit this notice in QUINTUPLICATE. One copy will be returned following approval. See additional instructions in Rules and Regulations of the Commission. If State Land submit 6 Copies Attach Form C- 128 in triplicate to first 3 copies of form C-101

Midland, Texas

(Place)

9-15-60

(Date)

OIL CONSERVATION COMMISSION  
SANTA FE, NEW MEXICO

Gentlemen:

You are hereby notified that it is our intention to commence the Drilling of a well to be known as

Joseph I. O'Neill, Jr.

(Company or Operator)

~~XXXXXX~~ State I

(Lease)

Well No. 1, in P The well is

(Unit)

located 660 feet from the south line and 660 feet from the

east line of Section 14, T. 12S, R. 34E, NMPM.

(GIVE LOCATION FROM SECTION LINE) Ranger Lake Penn. Pool, Lea County

If State Land the Oil and Gas Lease is No. E-1027

If patented land the owner is

Address

We propose to drill well with drilling equipment as follows: Rotary

The status of plugging bond is Blanket Bond Form 39-A-1 No. 90-114-215

Maryland Casualty Company

Drilling Contractor Great Western Drilling Co.

We intend to complete this well in the Pennsylvania

formation at an approximate depth of 10,500 feet.

### CASING PROGRAM

### 660' F&E Lines

We propose to use the following strings of Casing and to cement them as indicated:

Size of Hole	Size of Casing	Weight per Foot	New or Second Hand	Depth	Sacks Cement
17-1/2	13-3/8	42#	New	350	350
11	8-5/8	32#	New	4200	1000
7-7/8	5-1/2	17#	New	T.D.	250

If changes in the above plans become advisable we will notify you immediately.

ADDITIONAL INFORMATION (If recompletion give full details of proposed plan of work.)

SEP 19 1960

Approved \_\_\_\_\_, 19\_\_\_\_  
Except as follows:

OIL CONSERVATION COMMISSION

By \_\_\_\_\_

Engineer District 7

Sincerely yours,

Joseph I. O'Neill, Jr.

(Company or Operator)

By

Roy L. Blanton

Roy L. Blanton

Position Production Clerk

Send Communications regarding well to

Name Joseph I. O'Neill, Jr.

Address 410 West Ohio, Midland, Texas

**NEW MEXICO OIL CONSERVATION COMMISSION**  
**WELL LOCATION AND ACREAGE DEDICATION PLAT**

FORM C-128  
Revised 5/1/57

SEE INSTRUCTIONS FOR COMPLETING THIS FORM ON THE REVERSE SIDE

**SECTION A**

Operator <b>JOSEPH I O'NEILL, JR.</b>		Lease <b>STATE 1</b>		1960 SEP 15 PM 2:45	
Unit Letter <b>P</b>	Section <b>14</b>	Township <b>12 S</b>	Range <b>34 E</b>	County <b>LEA</b>	
Actual Footage Location of Well: <b>660'</b> feet from the <b>SOUTH</b> line and <b>660</b> feet from the <b>EAST</b> line					
Ground Level Elev. <b>4141 1/2</b>	Producing Formation <b>Pennsylvanian</b>		Pool <b>Ranger Lake (Pennsylvanian)</b>	Dedicated Acreage: <b>80</b> Acres	

1. Is the Operator the only owner in the dedicated acreage outlined on the plat below? YES ☒ NO \_\_\_\_ ("Owner" means the person who has the right to drill into and to produce from any pool and to appropriate the production either for himself or for himself and another. (65-3-29 (e) NMSA 1935 Comp.)
2. If the answer to question one is "no," have the interests of all the owners been consolidated by communitization agreement or otherwise? YES \_\_\_\_ NO \_\_\_\_ . If answer is "yes," Type of Consolidation \_\_\_\_
3. If the answer to question two is "no," list all the owners and their respective interests below:

Owner	Land Description

**SECTION B**

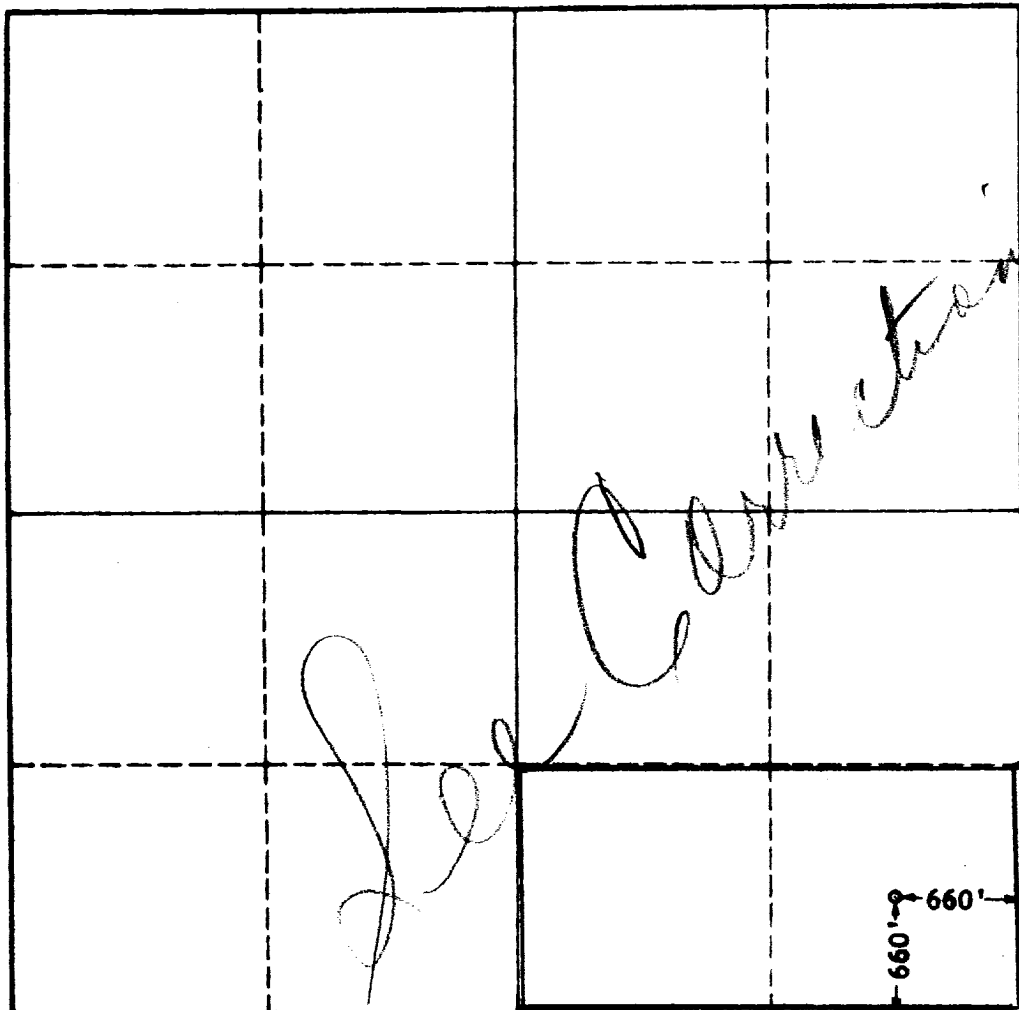

**CERTIFICATION**

I hereby certify that the information in SECTION A above is true and complete to the best of my knowledge and belief.

Name **Roy L Blanton**  
Position **Production Clerk**  
Company **Joseph I. O'Neill, Jr.**  
Date **9-15-60**

I hereby certify that the well location shown on the plat in SECTION B was plotted from field notes of actual surveys made by me or under my supervision, and that the same is true and correct to the best of my knowledge and belief.

Date Surveyed **SEP 15 1960**  
Registered Professional Engineer and/or Land Surveyor **JOHN W. WEST**  
Certificate No. **876**  
N. M. - **1004**

