

NEW MEXICO OIL CONSERVATION COMMISSION
Santa Fe, New Mexico

NOTICE OF INTENTION TO DRILL OR ~~RECOMPLETION~~

Notice must be given to the District Office of the Oil Conservation Commission and approval obtained before drilling or recompletion begins. If changes in the proposed plan are considered advisable, a copy of this notice showing such changes will be returned to the sender. Submit this notice in QUINTUPLICATE. One copy will be returned following approval. See additional instructions in Rules and Regulations of the Commission.

Midland, Texas
(Place)

June 15, 1957
(Date)

OIL CONSERVATION COMMISSION
SANTA FE, NEW MEXICO

Gentlemen:

You are hereby notified that it is our intention to commence the (Drilling) (~~Recompletion~~) of a well to be known as

Phillips Petroleum Company and T.P. Coal and Oil Company
(Company or Operator)

West Ranger Unit
(Lease)

, Well No. 3, in J (Unit) The well is

located 1979 feet from the South line and 1978 feet from the

East line of Section 23, T. 12-S, R. 34-E, NMPM.

(GIVE LOCATION FROM SECTION LINE) Ranger Lake Pennsylvanian Pool, Lea County

If State Land the Oil and Gas Lease is No. E-1027-1028 E-1027

If patented land the owner is -

Address -

We propose to drill well with drilling equipment as follows: Rotary

The status of plugging bond is Blanket

Drilling Contractor Shoenfeld-Hunter-Kitch Drilling Company

P.O. Box 588

Tulsa, Oklahoma

We intend to complete this well in the Pennsylvanian formation at an approximate depth of 10,500 feet.

CASING PROGRAM

We propose to use the following strings of Casing and to cement them as indicated:

Size of Hole	Size of Casing	Weight per Foot	New or Second Hand	Depth	Sacks Cement
<u>17-3/4"</u>	<u>13-3/8"</u>	<u>48#</u>	<u>New</u>	<u>350</u>	<u>350/Circ.</u>
<u>11"</u>	<u>8-5/8"</u>	<u>36#</u>	<u>New</u>	<u>4200</u>	<u>800/Circ.</u>
<u>7-7/8"</u>	<u>5-1/2"</u>	<u>20#</u>	<u>New</u>	<u>T.D.</u>	<u>Sufficient to tie</u>
					<u>in base of 3-5/8"</u>

If changes in the above plans become advisable we will notify you immediately.

ADDITIONAL INFORMATION (If recompletion give full details of proposed plan of work.)

Use salt water and diesel oil emulsion under immediate string casing to T.D. Maintain water loss control from 9200 feet to T.D.

Approved....., 19.....
Except as follows:

Sincerely yours,

Phillips Petroleum Company
(Company or Operator)

By W. J. Durham

Position Clerk

Send Communications regarding well to

Name M. R. Hayes

Address 3rd Floor Permian Bldg
Midland, Texas

OIL CONSERVATION COMMISSION

By E. J. Fisher

Title

NEW MEXICO OIL CONSERVATION COMMISSION
Well Location and Acreage Dedication Plat

Section A.

Date June 15, 1957

Operator Phillips Petroleum Company Lease East Ranger Unit
Well No. 3 Unit Letter J Section 23 Township 12-S Range 34-E NMPM
Located 1979 Feet From South Line, 1978 Feet From East Line
County Lea G. L. Elevation Furnish Later Dedicated Acreage 40 Acres
Name of Producing Formation Pennsylvanian Pool Ranger Lease Pennsylvanian

1. Is the Operator the only owner* in the dedicated acreage outlined on the plat below?
Yes _____ No X _____.
2. If the answer to question one is "no," have the interests of all the owners been consolidated by communitization agreement or otherwise? Yes X No _____. If answer is "yes," Type of Consolidation Unit Plan (Order No. B-797)
3. If the answer to question two is "no," list all the owners and their respective interests below:

Owner

Land Description

Section B

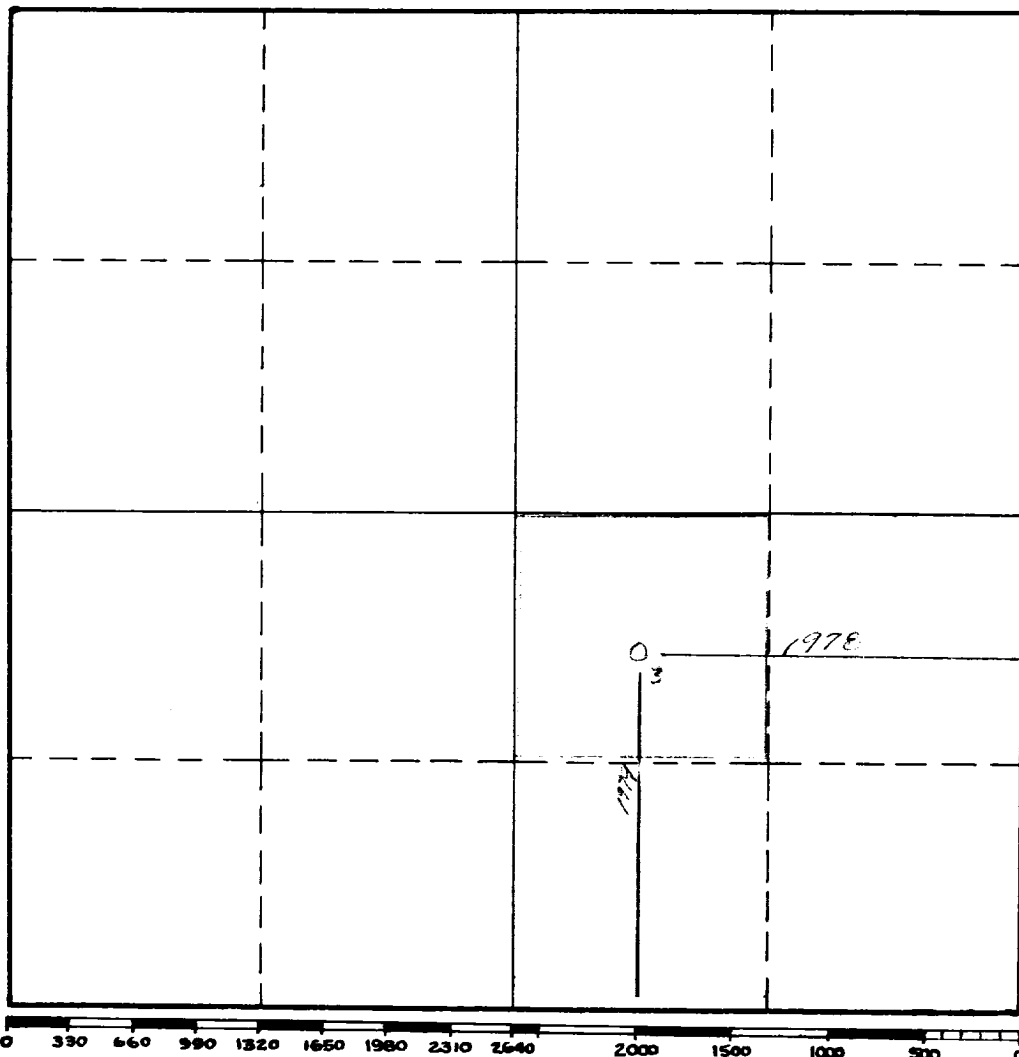

This is to certify that the information in Section A above is true and complete to the best of my knowledge and belief.

Phillips Petroleum Company
(Operator)

W.J. Durham *W.J. Durham*
(Representative)

M.R. Hayes
3rd Floor Permian Bldg, Midland, Tex
Address

This is to certify that the well location shown on the plat in Section B was plotted from field notes of actual surveys made by me or under my supervision and that the same is true and correct to the best of my knowledge and belief.

Date Surveyed 6-14-57

M.E. Sperry
Registered Professional
Engineer and/or Land Surveyor.

Certificate No. 679

(See instructions for completing this form on the reverse side)