

NEW MEXICO OIL CONSERVATION COMMISSION

Santa Fe, New Mexico

NOTICE OF INTENTION TO DRILL OR RECOMPLETE

Notice must be given to the District Office of the Oil Conservation Commission and approval obtained before drilling or recompletion begins. If changes in the proposed plan are considered advisable, a copy of this notice showing such changes will be returned to the sender. Submit this notice in QUINTUPPLICATE. One copy will be returned following approval. See additional instructions in Rules and Regulations of the Commission. If State Land submit 6 Copies

Midland, Texas
(Place)

September 9, 1957
(Date)

OIL CONSERVATION COMMISSION
SANTA FE, NEW MEXICO

Gentlemen:

You are hereby notified that it is our intention to commence the (Drilling) (Recompletion) of a well to be known as

Phillips Petroleum Company and T. P. Coal and Oil Company
(Company or Operator)

West Ranger Unit
(Lease)

Well No. **4**, in **F** (Unit) The well is

located **1900** feet from the **North** line and **1978** feet from the

West line of Section **23**, T. **12-S**, R. **34-E**, NMPM.

(GIVE LOCATION FROM SECTION LINE) **Ranger Lake Pennsylvanian** Pool, **Lea** County

If State Land the Oil and Gas Lease is No. **E-2793**

If patented land the owner is **-**

Address **-**

We propose to drill well with drilling equipment as follows: **Rotary**

The status of plugging bond is **Blanket**

Drilling Contractor **Schoenfeld-Hunter-Kitch Drilling Company,**
P. O. Box 586, Tulsa, Oklahoma

We intend to complete this well in the **Pennsylvanian** formation at an approximate depth of **10,500** feet.

CASING PROGRAM

We propose to use the following strings of Casing and to cement them as indicated:

Size of Hole	Size of Casing	Weight per Foot	New or Second Hand	Depth	Sacks Cement
27 3/4"	13 3/8"	40#	New	350'	350 sz - cir.
11"	8 5/8"	36#	New	4,225'	850 sz - cir.
7 7/8"	5 1/2"	20#	New	10,500'	Sufficient amount to tie into base of 8-5/8" csg.

If changes in the above plans become advisable we will notify you immediately.

ADDITIONAL INFORMATION (If recompletion give full details of proposed plan of work.)

Use native mud and salt saturated fluid to Int. Csg. point then clear water with viscosity to be maintained and oil added.

Approved....., 19.....
Except as follows:

OIL CONSERVATION COMMISSION

By.....

Sincerely yours,

Phillips Petroleum Company

(Company or Operator)

By **M. D. McKeith** *Division Chief Clerk*

Position **Division Chief Clerk**

Send Communications regarding well to

Name **M. E. Hayes**
Address **3rd Floor Pennam Bldg., Midland, Texas**

NEW MEXICO OIL CONSERVATION COMMISSION

Well Location and Acreage Dedication Plat

Section A.

Date September 9, 1957

Operator Phillips Petroleum Company Lease West Ranger Unit
Well No. 4 Unit Letter P Section 23 Township 12-S Range 34-E NMPM
Located 1900 Feet From North Line, 1978 Feet From West Line
County Lee G. L. Elevation Furnish Later Dedicated Acreage 40 Acres
Name of Producing Formation Pennsylvanian Pool Ranger Lake Pennsylvanian

1. Is the Operator the only owner* in the dedicated acreage outlined on the plat below?
Yes _____ No X.
2. If the answer to question one is "no," have the interests of all the owners been consolidated by communitization agreement or otherwise? Yes X No _____. If answer is "yes," Type of Consolidation Unit Plan (Order No. R-797)
3. If the answer to question two is "no," list all the owners and their respective interests below:

Owner

Land Description

Section B

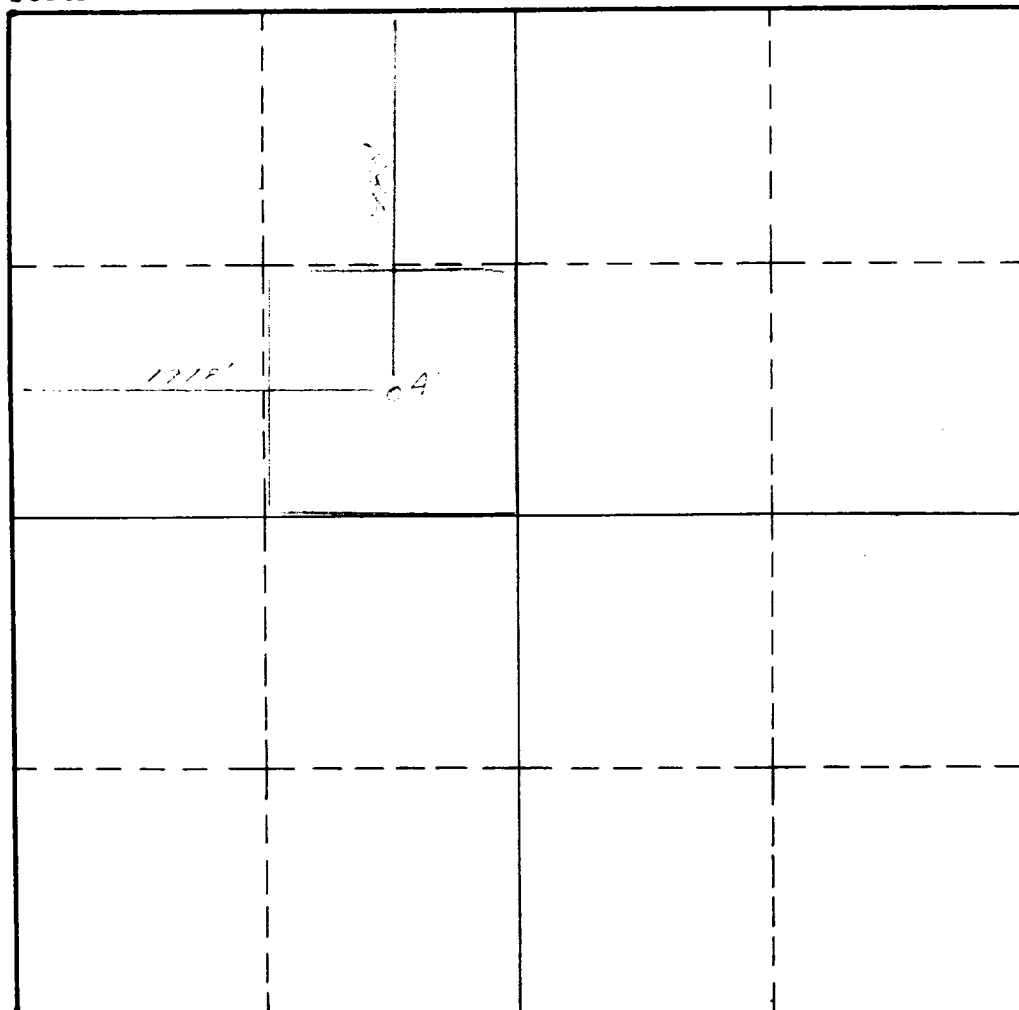

This is to certify that the information in Section A above is true and complete to the best of my knowledge and belief.

Phillips Petroleum Company
(Operator)

M. D. McHitt
(Representative)

Midland, Texas
Address

This is to certify that the well location shown on the plat in Section B was plotted from field notes of actual surveys made by me or under my supervision and that the same is true and correct to the best of my knowledge and belief.

Date Surveyed 9-6-57

M. E. Sney
Registered Professional
Engineer and/or Land Surveyor.

Certificate No. 679

INSTRUCTIONS FOR COMPLETION:

1. Operator shall furnish and certify to the information called for in Section A.
2. Operator shall outline the dedicated acreage for both oil and gas wells on the plat in Section B.
3. A registered professional engineer or land surveyor registered in the State of New Mexico or approved by the Commission shall show on the plat the location of the well and certify this information in the space provided.
4. All distances shown on the plat must be from the outer boundaries of Section.
5. If additional space is needed for listing owners and their respective interests as required in question 3, Section A, please use space below

* "Owner" means the person who has the right to drill into and to produce from any pool and to appropriate the production either for himself or for himself and another. (65-3-29 (e) NMSA 1953 Comp.)