

NEW MEXICO OIL CONSERVATION COMMISSION  
Well Location and Acreage Dedication Plat

Section A.

Date 8-25-58

Operator Gordon Cone Lease State "24"  
Well No. 2 Unit Letter M Section 24 Township 12 S Range 34 E NMPM  
Located 330 Feet From South Line, 330 Feet From West Line  
County Lea G. L. Elevation 4139.2 Dedicated Acreage 1/4 Acres  
Name of Producing Formation Pennsylvanian Pool Ranger Lake

1. Is the Operator the only owner\* in the dedicated acreage outlined on the plat below?  
Yes X No       .
2. If the answer to question one is "no," have the interests of all the owners been consolidated by communitization agreement or otherwise? Yes        No       . If answer is "yes," Type of Consolidation       .
3. If the answer to question two is "no," list all the owners and their respective interests below:

Owner

Land Description

GORDON M. CONE

SW/4 SW/4 Sec. 24-12S-34E

Section B

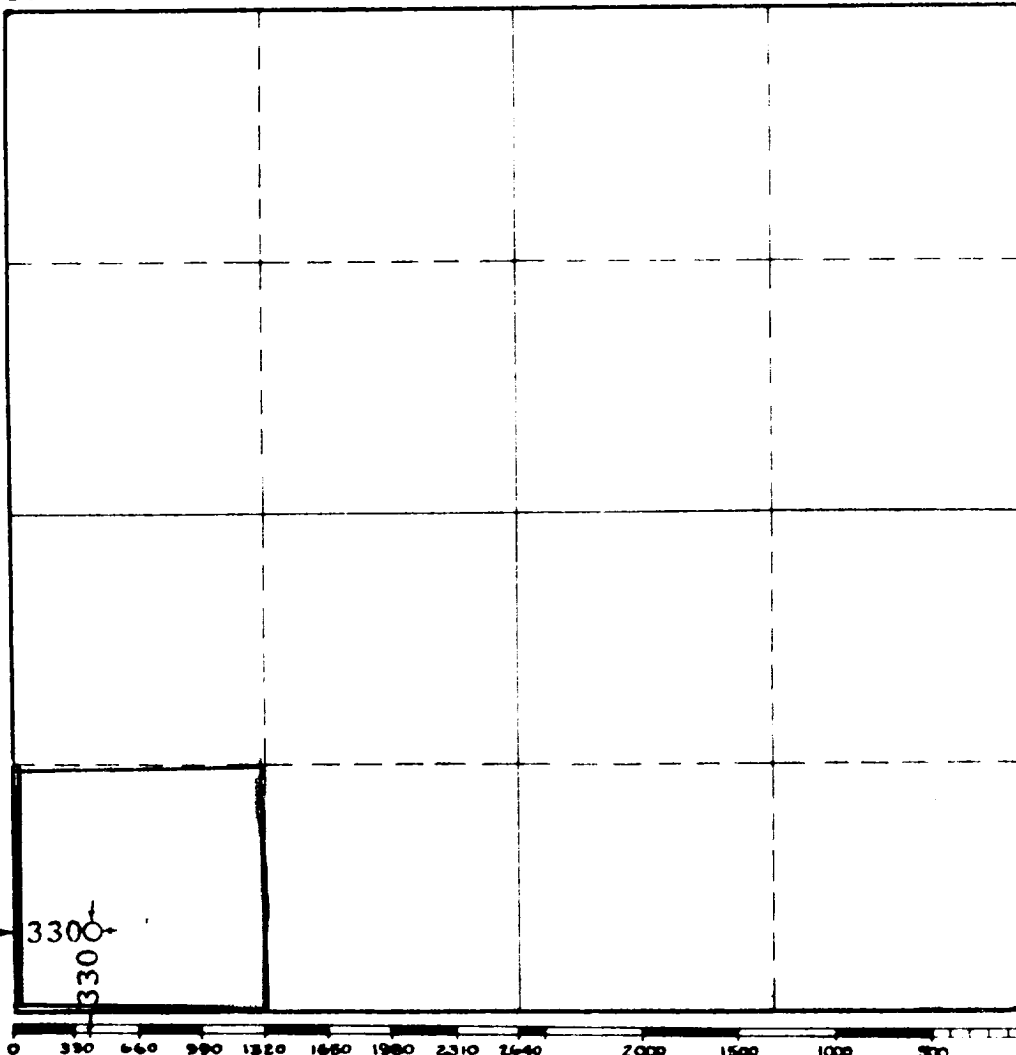

This is to certify that the information in Section A above is true and complete to the best of my knowledge and belief.

GORDON M. CONE

(Operator)

Gordon M. Cone  
(Representative)

BOX 1148, LOVINGTON, N.M.

Address

This is to certify that the well location shown on the plat in Section B was plotted from field notes of actual surveys made by me or under my supervision and that the same is true and correct to the best of my knowledge and belief.

Date Surveyed 8-25-58

John W. West  
Registered Professional  
Engineer and/or Land Surveyor.

Certificate No. 676