

NEW MEXICO OIL CONSERVATION COMMISSION
WELL LOCATION AND ACREAGE DEDICATION PLAT

FORM C-128
Revised 5/1/57

SEE INSTRUCTIONS FOR COMPLETING THIS FORM ON THE REVERSE SIDE

SECTION A

Operator Pan American Pet. Corp.		Lease State A7333 OCT 23 AM 10		No. 3	
Unit Letter J	Section 34	Township 12 S	Range 34 E	County Lea	
Actual Footage Location of Well: 1980 feet from the East line and 1980 feet from the South line					
Ground Level Elev. Not yet available	Producing Formation Pennsylvanian	Pool Undesignated (Ranger Lake - Pennsylvanian)		Dedicated Acreage: 80 Acres	

Extension)

1. Is the Operator the only owner in the dedicated acreage outlined on the plat below? YES ☒ NO ____ ("Owner" means the person who has the right to drill into and to produce from any pool and to appropriate the production either for himself or for himself and another. (65-3-29 (e) NMSA 1935 Comp.)
2. If the answer to question one is "no," have the interests of all the owners been consolidated by communitization agreement or otherwise? YES ____ NO ____ . If answer is "yes," Type of Consolidation ____
3. If the answer to question two is "no," list all the owners and their respective interests below:

Owner	Land Description

SECTION B

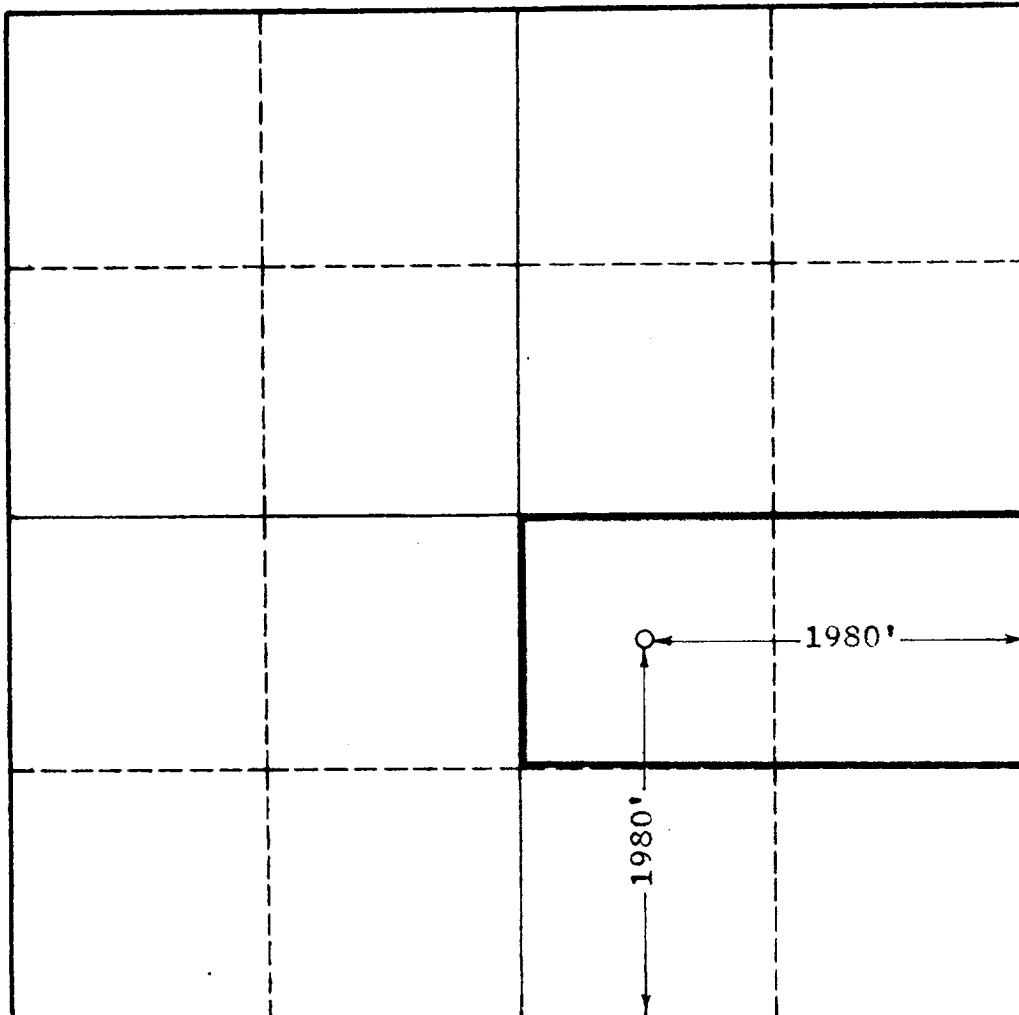

CERTIFICATION

I hereby certify that the information in SECTION A above is true and complete to the best of my knowledge and belief.

Original Signed by

Name J. W. BROWN

Position

Area Superintendent

Company Pan American Petroleum Corporation

Date

October 23, 1959

I hereby certify that the well location shown on the plat in SECTION B was plotted from field notes of actual surveys made by me or under my supervision, and that the same is true and correct to the best of my knowledge and belief.

Date Surveyed

10-20-59

Registered Professional Engineer and/or Land Surveyor, JOHN W. WEST

John W. West

Certificate No.

N.M. - P.E. & L.S. NO. 676

