

NEW MEXICO OIL CONSERVATION COMMISSION

Well Location and Acreage Dedication Plat

Section A.

Date 5-29-57

Operator Texas Crude Oil Company, J. I. Shell Lease Shell-Shultz 07  
Well No. 149 Unit Letter H Section 13 Township 12 S Range 37 E NMPM  
Located 2310 Feet From North Line, 330 Feet From East Line  
County Lea G. L. Elevation 3177 Dedicated Acreage 10 Acres  
Name of Producing Formation Dawson Pool Shultz

1. Is the Operator the only owner\* in the dedicated acreage outlined on the plat below?  
Yes No No \_\_\_\_\_.
2. If the answer to question one is "no," have the interests of all the owners been consolidated by communitization agreement or otherwise? Yes \_\_\_\_\_ No \_\_\_\_\_. If answer is "yes," Type of Consolidation \_\_\_\_\_
3. If the answer to question two is "no," list all the owners and their respective interests below:

Owner

Land Description

Section B

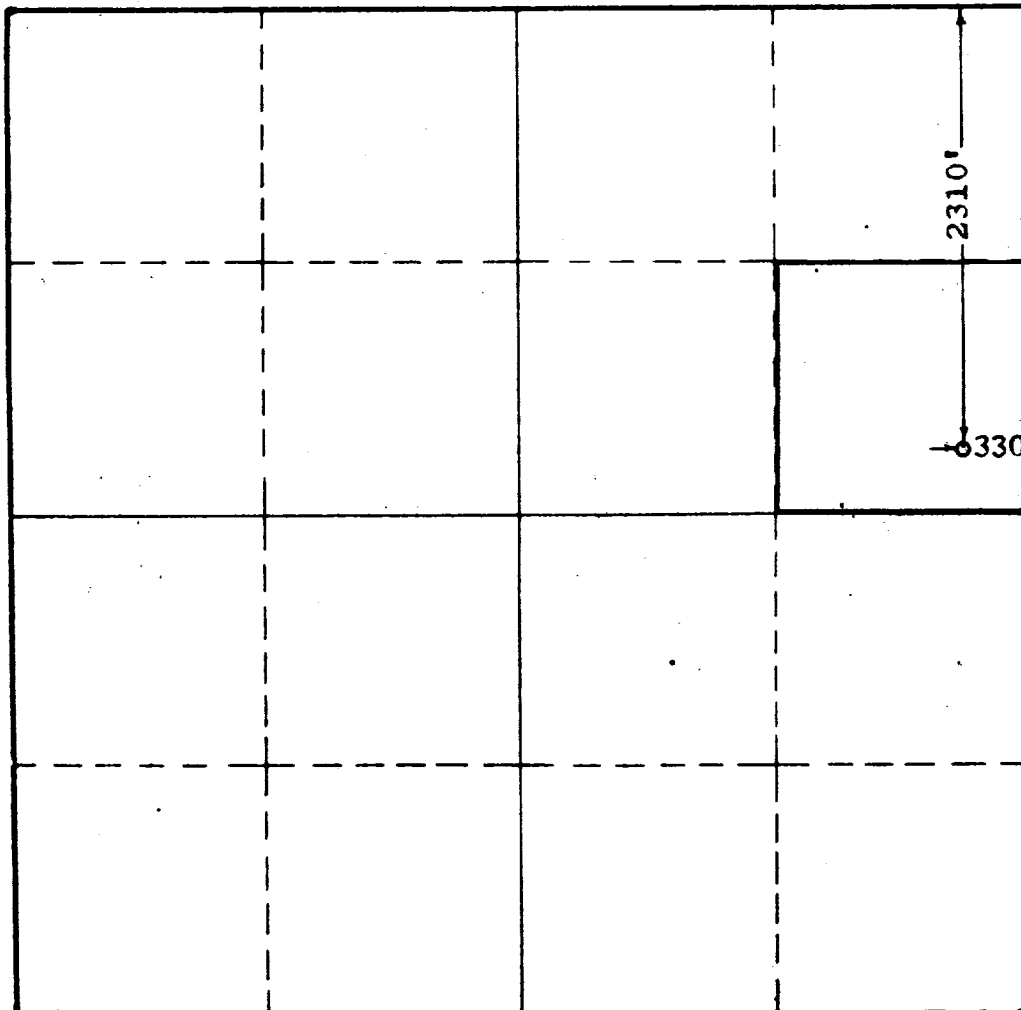

This is to certify that the information in Section A above is true and complete to the best of my knowledge and belief.

Texas Crude Oil Co., & J.I. Shell

(Operator)

John G. Oliver  
(Representative)

1205 V & J Turn, Midland, Texas

Address

This is to certify that the well location shown on the plat in Section B was plotted from field notes of actual surveys made by me or under my supervision and that the same is true and correct to the best of my knowledge and belief.

Date Surveyed 5-29-57

John W. West  
Registered Professional  
Engineer and/or Land Surveyor.

Certificate No. 676

See instructions for completing this form on the reverse side

