

NEW MEXICO OIL CONSERVATION COMMISSION
Santa Fe, New Mexico

Form C-101
Revised (12/1/55)

NOTICE OF INTENTION TO DRILL

HOBBS OFFICE OCC

Notice must be given to the District Office of the Oil Conservation Commission and approval obtained before drilling or recompletion begins. If changes in the proposed plan are considered advisable, a copy of this notice showing such changes will be returned to the sender. Submit this notice in QUINTUPLICATE. One copy will be returned following approval. See additional instructions in Rules and Regulations of the Commission.

If State Land submit 6 Copies Attach Form C-128 in triplicate to first 3 copies of form C-101

Hobbs, New Mexico

July 29, 1960

(Place)

(Date)

OIL CONSERVATION COMMISSION
SANTA FE, NEW MEXICO

Gentlemen:

You are hereby notified that it is our intention to commence the Drilling of a well to be known as

Skelly Oil Company

(Company or Operator)

M. A. Foster

(Lease)

Well No. 2

"1"

(Unit)

The well is

located 1980 feet from the south line and 660 feet from the

east

Line of Section 27, T. 12-S, R. 37-E, NMPM.

(GIVE LOCATION FROM SECTION LINE) Southwest Gladiola Pool, Lea County

If State Land the Oil and Gas Lease is No.

If patented land the owner is Mr. Brady Lowe

Address Lubbock, Texas

We propose to drill well with drilling equipment as follows: Rotary tools from surface to total depth of approximately 12,400'.

The status of plugging bond is Blanket bond #1253688 for \$100,000 with The Federal Insurance Company

Drilling Contractor Sharp Drilling Co.

P.O. Box 1271

Midland, Texas

We intend to complete this well in the Devonian

formation at an approximate depth of 12,400 feet.

CASING PROGRAM

We propose to use the following strings of Casing and to cement them as indicated:

Size of Hole	Size of Casing	Weight per Foot	New or Second Hand	Depth	Sacks Cement
18"	13-3/8" OD	44.5#	New	355	360
12-1/4"	8-5/8" OD	32#	New	4500	2200
7-7/8"	5-1/2" OD	17#	New	12,400	500

If changes in the above plans become advisable we will notify you immediately.

ADDITIONAL INFORMATION (If recompletion give full details of proposed plan of work.)

Halliburton process will be used in cementing all casing. Cement will be circulated to surface on the 13-3/8" casing.

Approved _____, 19_____
Except as follows:

Sincerely yours,

Skelly Oil Company

(Company or Operator)

By _____

Position Dist. Supt.

Send Communications regarding well to

Name Skelly Oil Company

Address P.O. Box 38 - Hobbs, New Mexico

OIL CONSERVATION COMMISSION

By _____

NEW MEXICO OIL CONSERVATION COMMISSION

WELL LOCATION AND ACREAGE DEDICATION PLAT

HOBBS OFFICE OCC FOR
Rev.

SEE INSTRUCTIONS FOR COMPLETING THIS FORM ON THE REVERSE SIDE

SECTION A

Operator Skelly Oil Co			Lease M. A. Foster		Well No. 2
Unit Letter I	Section 27	Township 12 S	Range 37 E	County Lea	
Actual Footage Location of Well: 1980 feet from the South line and 660 feet from the East line					
Ground Level Elev.	Producing Formation Devonian		Pool Southwest Gladiola		Dedicated Acreage: 10 80 Acres

1. Is the Operator the only owner in the dedicated acreage outlined on the plat below? YES ☒ NO ____ . ("Owner" means the person who has the right to drill into and to produce from any pool and to appropriate the production either for himself or for himself and another. (65-3-29 (e) NMSA 1955 Comp.)
2. If the answer to question one is "no," have the interests of all the owners been consolidated by communitization agreement or otherwise? YES ____ NO ____ . If answer is "yes," Type of Consolidation ____
3. If the answer to question two is "no," list all the owners and their respective interests below:

Owner	Land Description

SECTION B

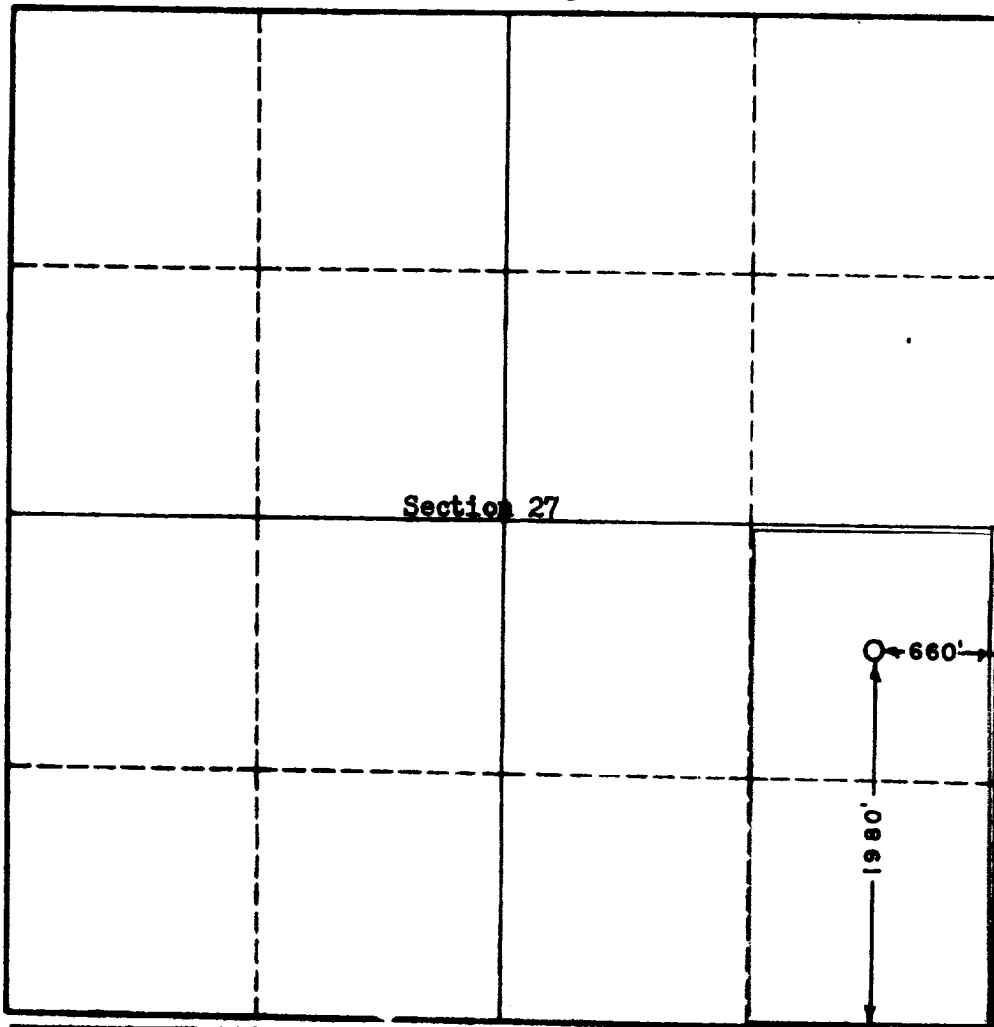

CERTIFICATION

I hereby certify that the information in SECTION A above is true and complete to the best of my knowledge and belief.

Name <i>[Signature]</i>
Position Dist. Supt.
Company Skelly Oil Co.
Date July 29, 1960

I hereby certify that the well location shown on the plat in SECTION B was plotted from field notes of actual surveys made by me or under my supervision, and that the same is true and correct to the best of my knowledge and belief.

Date Surveyed July 29, 1960
Registered Professional Engineer and/or Land Surveyor JOHN W. WEST
Certificate No. N. M. - P. E. & L. S. NO. 676

