

NEW MEXICO OIL CONSERVATION COMMISSION

Well Location and Acreage Dedication Plat

Section A.

Date May 10, 1957

Operator CABOT CARBON COMPANY Lease H. M. Lowe "B"
 Well No. 1 Unit Letter Section 26 Township 13 South Range 37 East NMPM
 Located 467 Feet From South Line, 850 Feet From East Line
 County Lea G. L. Elevation 3855.5 Dedicated Acreage 40 Acres
 Name of Producing Formation Devonian Pool King-Devonian

1. Is the Operator the only owner* in the dedicated acreage outlined on the plat below?
 Yes No X.
2. If the answer to question one is "no," have the interests of all the owners been consolidated by communitization agreement or otherwise? Yes X No . If answer is "yes," Type of Consolidation Joint Operating Agreement
3. If the answer to question two is "no," list all the owners and their respective interests below:

OwnerLand Description

Section B

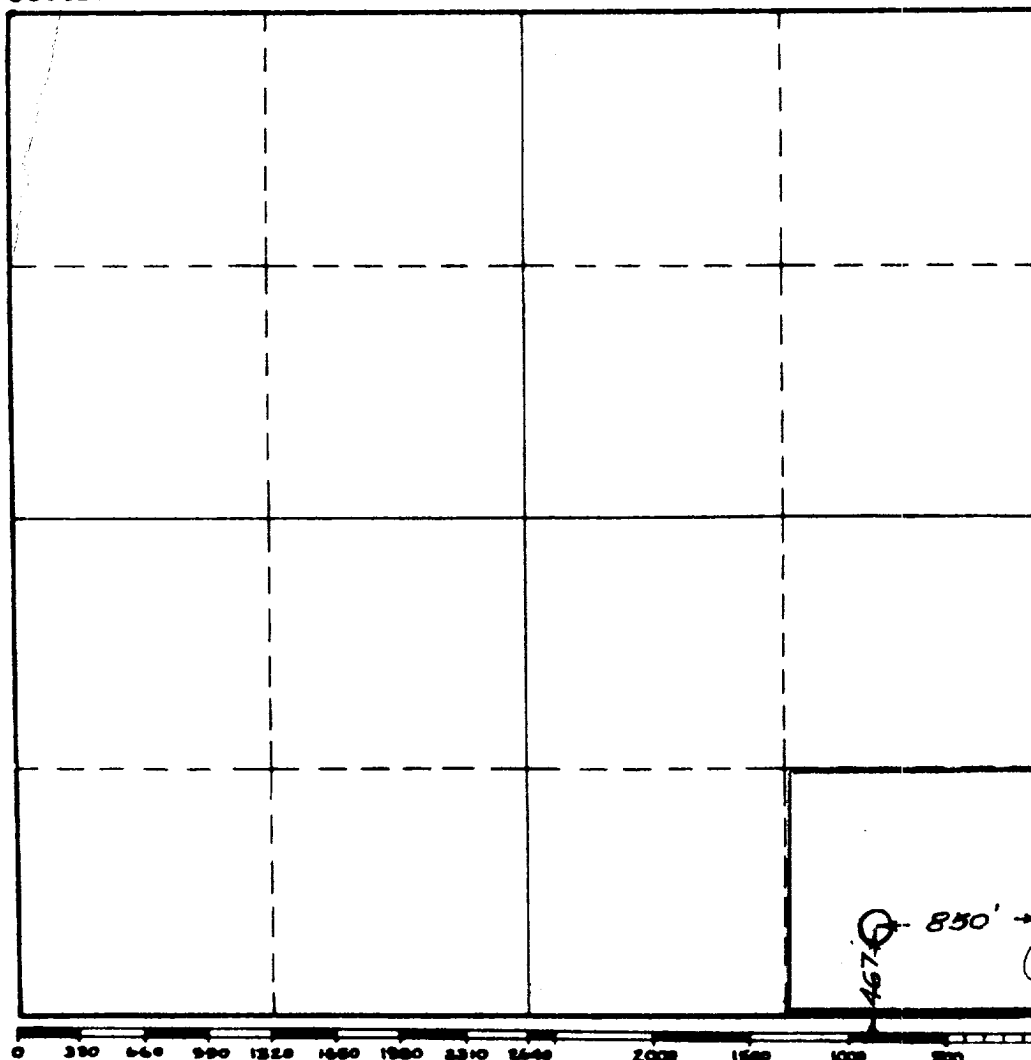

This is to certify that the information in Section A above is true and complete to the best of my knowledge and belief.

Cabot Carbon Company
 (Operator)

Percy C. Quinn
 (Representative)

Box 2095, Midland, Texas
 Address

This is to certify that the well location shown on the plat in Section B was plotted from field notes of actual surveys made by me or under my supervision and that the same is true and correct to the best of my knowledge and belief.

Date Surveyed May 10, 1957

John W. Shearn
 Registered Professional
 Engineer and/or Land Surveyor.

Certificate No. 1559

(See instructions for completing this form on the reverse side)