

NEW MEXICO OIL CONSERVATION COMMISSION  
Well Location and Acreage Dedication Plat

DATE November 19, 1957

Section A.

Operator CABOT CARBON COMPANY Lease Howard Fleet et al  
Well No. 4 Unit Letter 0 Section 35 Township 13 South Range 37 East NMPM  
Located 990 Feet From South Line, 1650 Feet From East Line  
County Lea G. L. Elevation 3846.0 Dedicated Acreage 40 Acres  
Name of Producing Formation Devonian Pool King-Devonian

1. Is the Operator the only owner\* in the dedicated acreage outlined on the plat below?  
Yes \_\_\_\_\_ No x.
2. If the answer to question one is "no," have the interests of all the owners been consolidated by communitization agreement or otherwise? Yes x No \_\_\_\_\_. If answer is "yes," Type of Consolidation Joint operating agreement
3. If the answer to question two is "no," list all the owners and their respective interests below:

Owner

Land Description

Section B

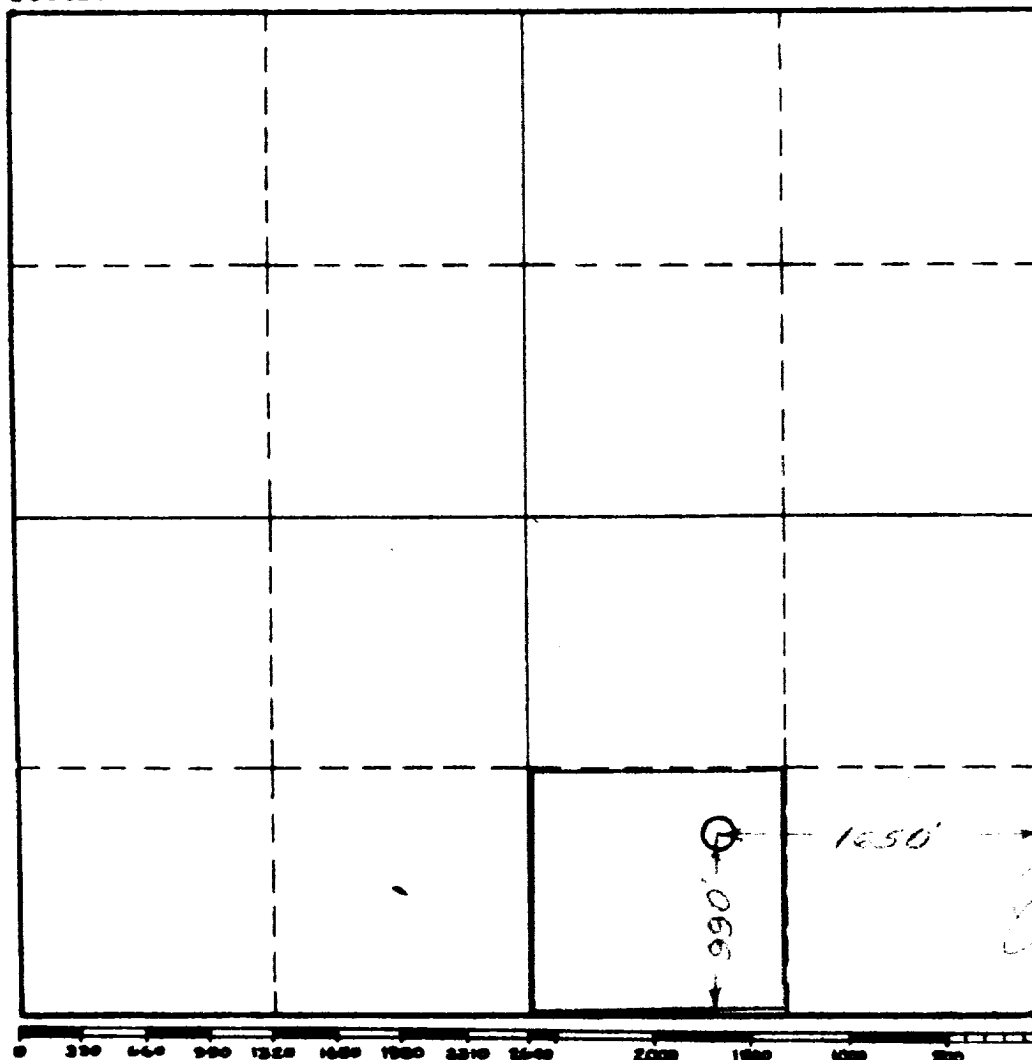

This is to certify that the information in Section A above is true and complete to the best of my knowledge and belief.

Cabot Carbon Company  
(Operator)

Percy C. Ogilvie  
(Representative)

P. O. Box 2095, Midland, Texas  
Address

This is to certify that the well location shown on the plat in Section B was plotted from field notes of actual surveys made by me or under my supervision and that the same is true and correct to the best of my knowledge and belief.

Date Surveyed Nov. 19, 1957

John W. Stearns  
Registered Professional  
Engineer and/or Land Surveyor.

Certificate No. 1559

(See instructions for completing this form on the reverse side)