

PUBLIC

NEW MEXICO OIL CONSERVATION COMMISSION

Well Location and Acreage Dedication Plat

HOBBBS OFFICE 000

Section A.

Date Sept. 20, 1958

Texas Crude Oil Co. &

Operator Hancock Oil Co. Lease Heidel

Well No. 1-1 Unit Letter J Section 1 Township 14 South Range 37 East NMPM

Located 2310 Feet From East Line, 1650 Feet From South Line

County Lea C. L. Elevation 3822.3 Dedicated Acreage 40 Acres

Name of Producing Formation Devonian Pool Undesignated

1. Is the Operator the only owner* in the dedicated acreage outlined on the plat below?
Yes X No .
2. If the answer to question one is "no," have the interests of all the owners been consolidated by communitization agreement or otherwise? Yes No . If answer is "yes," Type of Consolidation Partnership
3. If the answer to question two is "no," list all the owners and their respective interests below:

Owner

Land Description

Section B

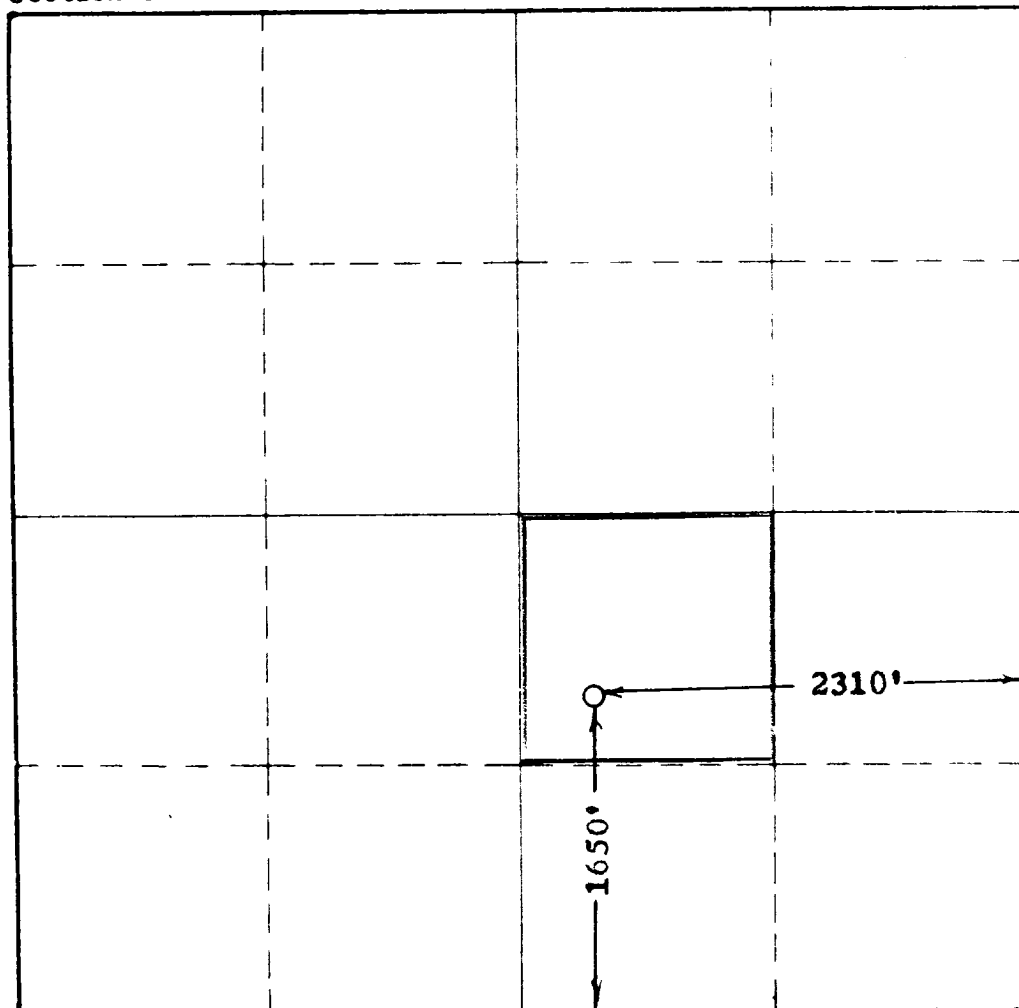

This is to certify that the information in Section A above is true and complete to the best of my knowledge and belief.

**Texas Crude Oil Company &
Hancock Oil Company**
(Operator)

J. T. Ballanway
(Representative)

1201 V & J Tower, Midland, Texas
Address

This is to certify that the well location shown on the plat in Section B was plotted from field notes of actual surveys made by me or under my supervision and that the same is true and correct to the best of my knowledge and belief.

Date Surveyed Sept. 19, 1958

Robert H. Hest
Registered Professional
Engineer and/or Land Surveyor.

Certificate No. 676