

NEW MEXICO OIL CONSERVATION COMMISSION
Santa Fe, New Mexico

NOTICE OF INTENTION TO DRILL OR RECOMPLETE

Notice must be given to the District Office of the Oil Conservation Commission and approval obtained before drilling or recompletion begins. If changes in the proposed plan are considered advisable, a copy of this notice showing such changes will be returned to the sender. Submit this notice in QUINTUPLICATE. One copy will be returned following approval. See additional instructions in Rules and Regulations of the Commission.

Midland, Texas

March 5, 1957

(Place)

(Date)

OIL CONSERVATION COMMISSION
SANTA FE, NEW MEXICO

Gentlemen:

You are hereby notified that it is our intention to commence the (Drilling) ~~(Recompletion)~~ of a well to be known as
The Atlantic Refining Company

(Company or Operator)

J. L. Reed

Well No. **1**, in **D** (Unit) The well is

located **660** feet from the **North** line and **660** feet from the **West** line of Section **1**, T. **-14-S**, R. **-37-E**, NMPM.

(GIVE LOCATION FROM SECTION LINE)

Pool, **Lea** County

D	C	B	A
E	F	G	H
L	K	J	I
M	N	O	P

If State Land the Oil and Gas Lease is No

If patented land the owner is

Address

We propose to drill well with drilling equipment as follows: **Rotary equipment to total depth.**

The status of plugging bond is **Bond No. 8 General Casualty Company of America is in effect.**

Drilling Contractor **To be determined.**

We intend to complete this well in the **Devonian and Pennsylvanian** formation at an approximate depth of **13000** feet.

CASING PROGRAM

We propose to use the following strings of Casing and to cement them as indicated:

Size of Hole	Size of Casing	Weight per Foot	New or Second Hand	Depth	Sacks Cement
17-1/4"	13-3/8"	48#	New	355'	450
12-1/4"	9-5/8"	36#	New	4600'	2200
8-3/4"	7"	23# to 32#	New	13000'	1000

If changes in the above plans become advisable we will notify you immediately.

ADDITIONAL INFORMATION (If recompletion give full details of proposed plan of work.)

We plan to drill to total depth, taking approximately 8 drill stem tests and 100' of coring. Set pipe at total depth, perforate and stimulate if necessary.

MAR 11 1957

Approved _____, 19_____
Except as follows:

OIL CONSERVATION COMMISSION

By **E. J. Fischer**
Engineer District 1
Title _____

Sincerely yours,

The Atlantic Refining Company
(Company or Operator)

By **M. L. Mills**

Position **Regional Drilling Manager**
Send Communications regarding well to

Name **The Atlantic Refining Company**

Address **Box 871**

Midland, Texas

NEW MEXICO
OIL CONSERVATION COMMISSION

Form C-128

Well Location and/or Gas Proration Plat

Date January 7, 1957

Operator THE ATLANTIC REFINING COMPANY Lease J. L. REED

Well No. 1 Section 1 Township 14 South Range 37 East NMPM

Located 660 Feet From North Line, 660 Feet From West Line,

LEA County, New Mexico. G. L. Elevation _____

Name of Producing Formation Devonian & Pennsylvanian Pool King Dedicated Acreage 41.60 Ac.

(Note: All distances must be from outer boundaries of Section)

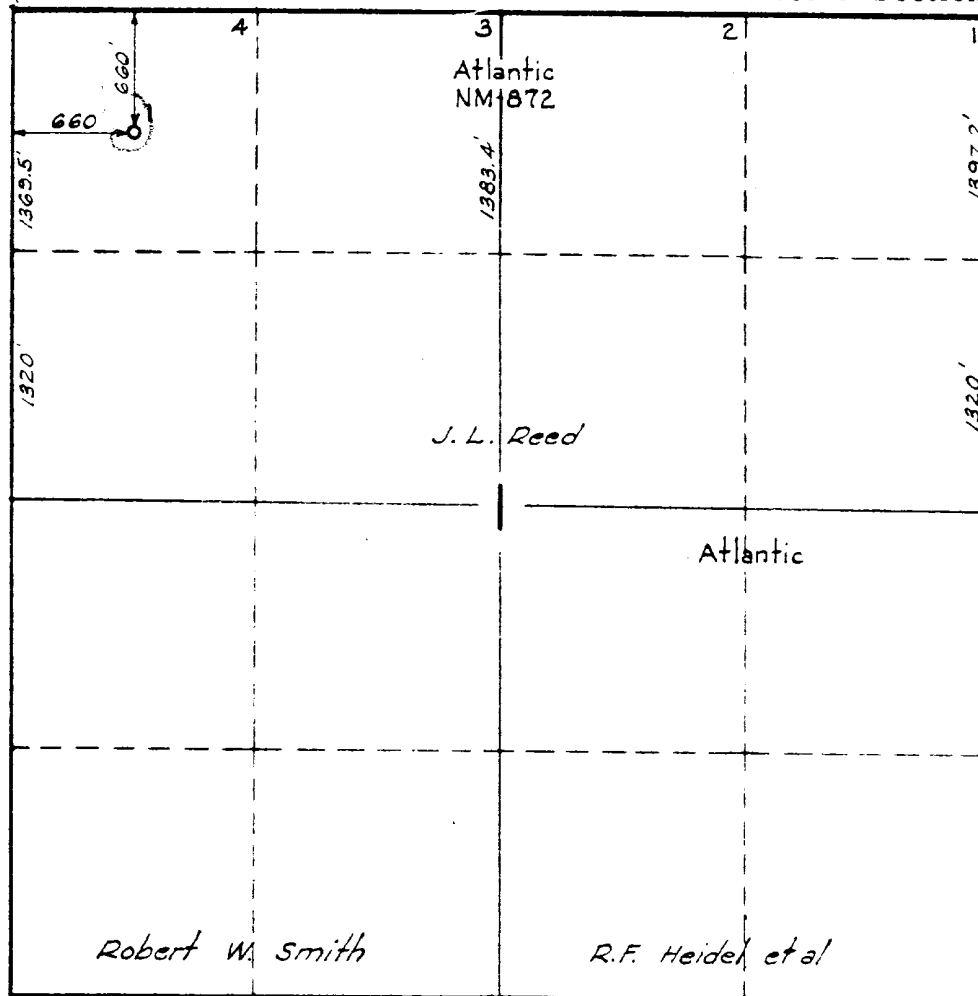

1. Is this Well a Dual Comp. ? Yes X No ____.
2. If the answer to Question 1 is yes, are there any other dually completed wells within the dedicated acreage? Yes ____ No X.

This is to certify that the above plat was prepared from field notes of actual surveys made by me or under my supervision and that the same are true and correct to the best of my knowledge and belief.

Name Dr. L. Mills M. L. Mills
Position Regional Drilling Manager
Representing The Atlantic Refining Company
Address Box 871 Midland, Texas

Date Surveyed Feb. 28, 1957

W. J. Burkart
W. J. Burkart, Chief Surveyor
The Atlantic Refining Company

