

NEW MEXICO OIL CONSERVATION COMMISSION
Santa Fe, New Mexico

NOTICE OF INTENTION TO DRILL OR RECOMPLETE

Notice must be given to the District Office of the Oil Conservation Commission and approval obtained before drilling or recompletion begins. If changes in the proposed plan are considered advisable, a copy of this notice showing such changes will be returned to the sender. Submit this notice in QUINTUPPLICATE. One copy will be returned following approval. See additional instructions in Rules and Regulations of the Commission.

Monument, New Mexico
(Place)

April 6, 1954
(Date)

OIL CONSERVATION COMMISSION
SANTA FE, NEW MEXICO

Gentlemen:

You are hereby notified that it is our intention to commence the (Drilling) (Recompletion) of a well to be known as

Amerada Petroleum Corporation
(Company or Operator)

Lois C. Hobbs (Lease), Well No. 1, in D (Unit). The well is located 810 feet from the North line and 510 feet from the West line of Section 3, T. 14-S, R. 37-E, NMPM. (GIVE LOCATION FROM SECTION LINE) Wildcat - Lea County

R-37-E

D-1	C	B	A
E	F	G	H
L	K	J	I
M	N	O	P

T
14
S

If State Land the Oil and Gas Lease is No.

If patented land the owner is Lois C. Hobbs

Address Lovington, New Mexico

We propose to drill well with drilling equipment as follows: Rotary Tools all the way -

The status of plugging bond is Blanket -

Drilling Contractor Noble Drilling Corporation
Stanclind Bldg.
Tulsa, Oklahoma

We intend to complete this well in the Pennsylvanian formation at an approximate depth of 11,700 feet.

CASING PROGRAM

We propose to use the following strings of Casing and to cement them as indicated:

Size of Hole	Size of Casing	Weight per Foot	New or Second Hand	Depth	Sacks Cement
17-1/2"	13-3/8	36#	New	360'	250
11	8-5/8	32#	New	4720	1500
7-7/8	5-1/2	15.5 & 17#	New	11700	600

If changes in the above plans become advisable we will notify you immediately.

ADDITIONAL INFORMATION (If recompletion give full details of proposed plan of work.)

It was necessary to move 150' south and 150' west of original location due to the fact the location had fallen in a livestock corral belonging to a nearby rancher. The attached Plat indicated move was made toward other properties owned by Amerada. (Ref: Rule 104 (f) New Mexico Oil Conservation Commission Rules & Regulations)

Approved: APR 6 1954, 19
Except as follows:

Sincerely yours,

Amerada Petroleum Corporation
(Company or Operator)

By: [Signature]
Position: Assistant District Superintendent
Send Communications regarding well to
Name: Amerada Petroleum Corporation
Address: Drawer D, Monument, New Mexico

OIL CONSERVATION COMMISSION

By: Roy Yunker
Title:

WELL LOCATION SURVEY PLAT

OPERATOR AMERADA PETROLEUM CORP.

LEASE LOIS C. HOBBS

WELL NO. 1

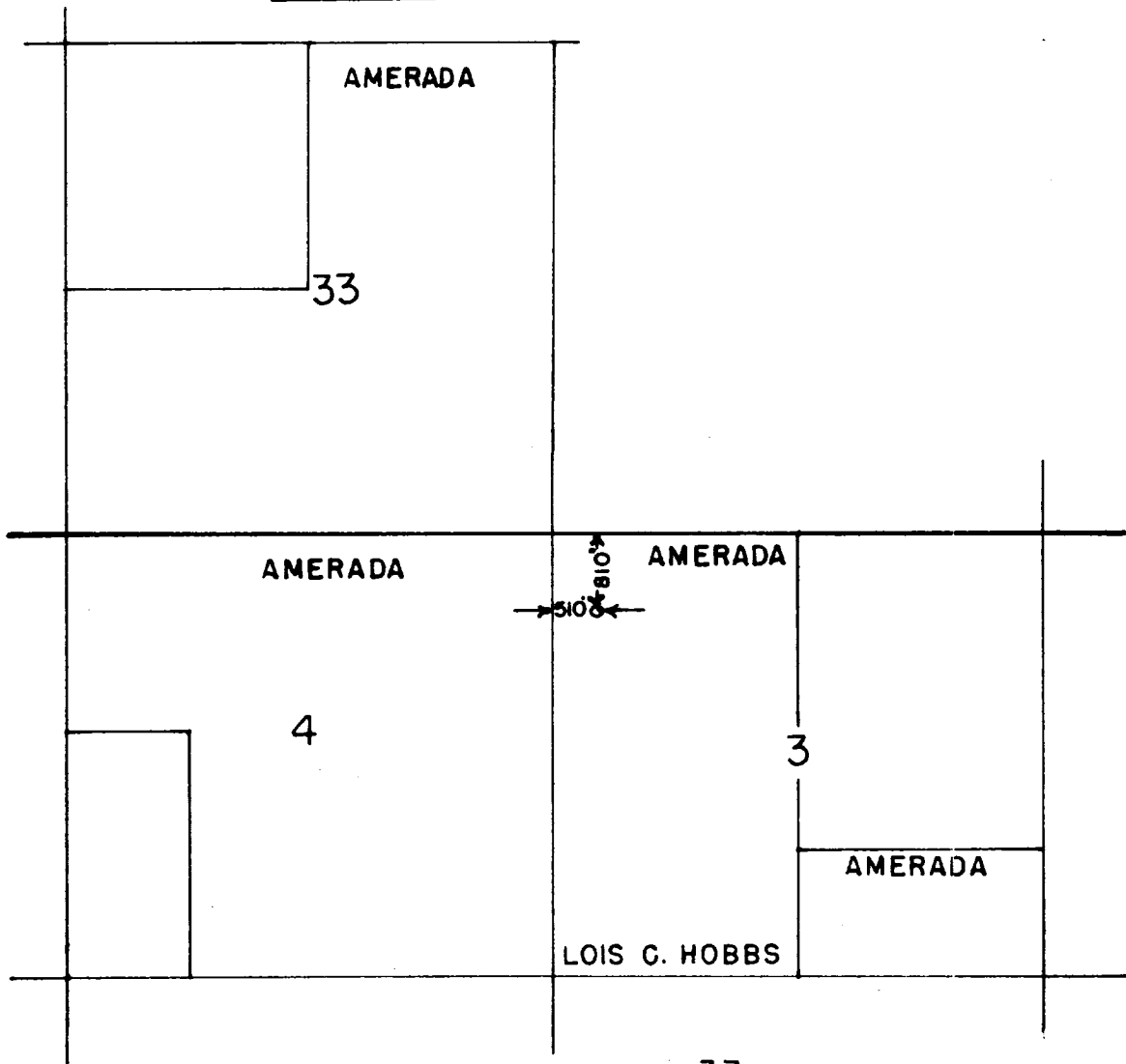

SEC. 3, TWP. 14 S., RGE. 37 E., N.M.P.M.

I HEREBY CERTIFY THAT THIS PLAT WAS MADE FROM NOTES TAKEN IN THE FIELD BY ME IN AN ACTUAL BOUNDARY SURVEY AND THAT THE SAME IS TRUE AND CORRECT TO THE BEST OF MY KNOWLEDGE AND BELIEF.

John W. West
JOHN W. WEST, PE & LS NO. 676

