

DUPLICATE

(Form C-101)
(Revised 7/1/52)

NEW MEXICO OIL CONSERVATION COMMISSION
Santa Fe, New Mexico

NOTICE OF INTENTION TO DRILL OR RECOMPLETE

Notice must be given to the District Office of the Oil Conservation Commission and approval obtained before drilling or recompletion begins. If changes in the proposed plan are considered advisable, a copy of this notice showing such changes will be returned to the sender. Submit this notice in **QUINTUPLICATE**. One copy will be returned following approval. See additional instructions in Rules and Regulations of the Commission.

Midland, Texas
(Place)

Jan. 14, 1957
(Date)

OIL CONSERVATION COMMISSION
SANTA FE, NEW MEXICO

Gentlemen:

You are hereby notified that it is our intention to commence the (Drilling) (Recompletion) of a well to be known as

Ralph Lowe

(Company or Operator)

Wm. J. Adamson

(Lease)

Well No. **4**, in **C** The well is

located **660** feet from the **North** line and **1986.93** feet from the

West line of Section **5**, T. **12-S**, R. **38-E**, NMPM.

(GIVE LOCATION FROM SECTION LINE) **N. Gladiola Dev.** Pool, **Lea** County

If State Land the Oil and Gas Lease is No.

If patented land the owner is **Wm. J. Adamson**

Address **El Paso, New Mexico**

We propose to drill well with drilling equipment as follows: **Rotary**

The status of plugging bond is **10,000.00 Blanket Form 39-A-1 Approved**

Drilling Contractor **Lowe Drilling Company**

We intend to complete this well in the **Devonian** formation at an approximate depth of **12,500** feet.

CASING PROGRAM

We propose to use the following strings of Casing and to cement them as indicated:

Size of Hole	Size of Casing	Weight per Foot	New or Second Hand	Depth	Sacks Cement
17"	13-3/8	50	New	350	Circulate
11	8-5/8	32	New	4500	Circulate
7-7/8	5-1/2	20	New	T.D.	1000

If changes in the above plans become advisable we will notify you immediately.

ADDITIONAL INFORMATION (If recompletion give full details of proposed plan of work.)

JAN 18 1957

Approved....., 19.....
Except as follows:

OIL CONSERVATION COMMISSION

By **E. J. Fischer**
Title **Engineer District 1**

Sincerely yours,

Ralph Lowe

(Company or Operator)

By **[Signature]**

Position **Agent**

Send Communications regarding well to

Name **Ralph Lowe**

Address **Box 832 Midland, Texas**

NEW MEXICO
OIL CONSERVATION COMMISSION

Form C-128

Well Location and/or Gas Proration Plat

Date Jan 14, 1957

Operator Ralph Lowe Lease Wm. J. Adamson

Well No. 4 Section 5 Township 12-S Range 38-E NMPM

Located 660 Feet From North Line, 1986.93 Feet From West Line,

Lea County, New Mexico. G. L. Elevation 3882

Name of Producing Formation Devonian Pool Devonian Dedicated Acreage 40
North Gladiola

(Note: All distances must be from outer boundaries of Section)

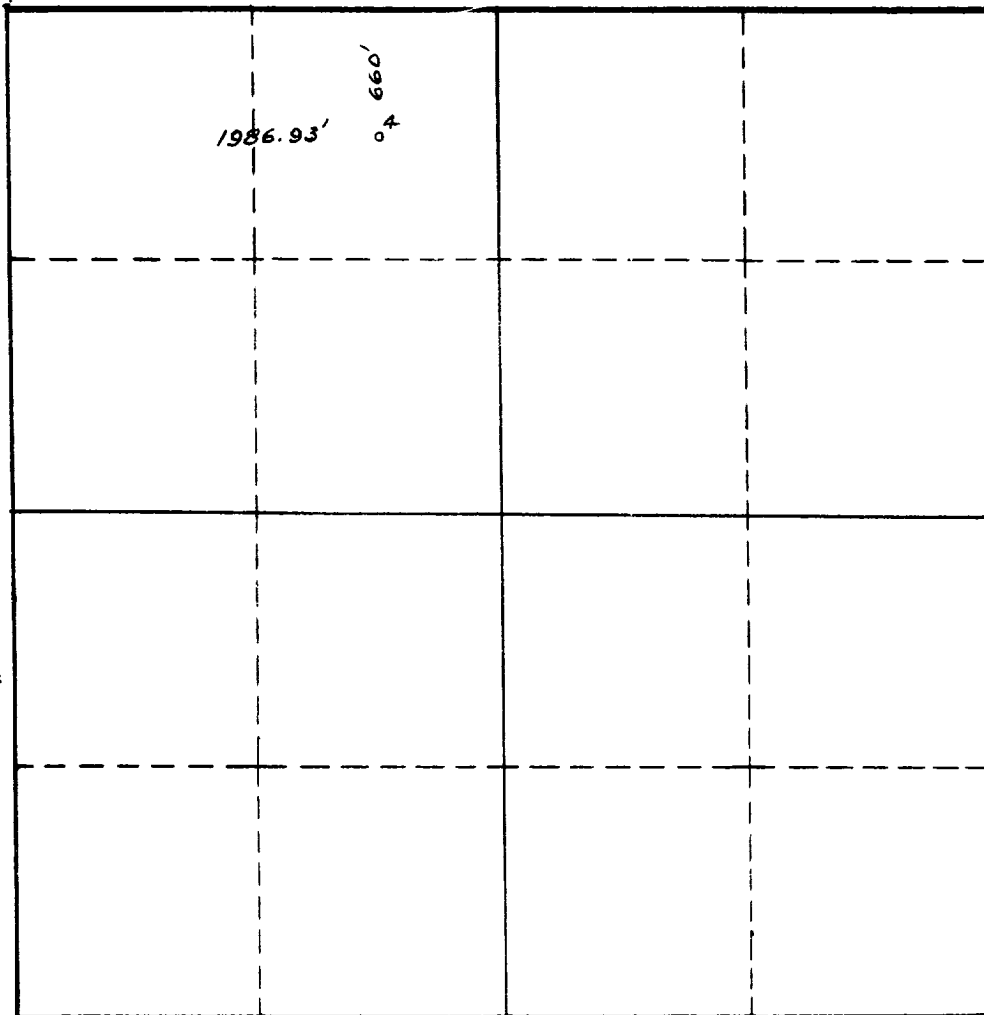

NOTE

This section of
form is to be
used for gas
wells only.



SCALE: 1"=1000'

1. Is this Well a Dual Comp. ? Yes No .
2. If the answer to Question 1 is yes, are there any other dually completed wells within the dedicated acreage ? Yes No .

Name
Position
Representing
Address

This is to certify that the above plat was prepared from field notes of actual surveys made by me or under my supervision and that the same are true and correct to the best of my knowledge and belief.

Date Surveyed October 29, 1956
J. F. Johnson
Registered Professional Engineer and/or
Land Surveyor