

NEW MEXICO OIL CONSERVATION COMMISSION  
Santa Fe, New Mexico

Form C-101  
Revised (12/1/55)

NOTICE OF INTENTION TO DRILL

Notice must be given to the District Office of the Oil Conservation Commission and approval obtained before drilling or recompletion begins. If changes in the proposed plan are considered advisable, a copy of this notice showing such changes will be returned to the sender. Submit this notice in QUINTUPLICATE. One copy will be returned following approval. See additional instructions in Rules and Regulations of the Commission. If State Land submit 6 Copies Attach Form C-128 in triplicate to first 3 copies of form C-101

Hobbs, New Mexico  
(Place)

July 15, 1957  
(Date)

OIL CONSERVATION COMMISSION  
SANTA FE, NEW MEXICO

Gentlemen:

You are hereby notified that it is our intention to commence the Drilling of a well to be known as

Continental Oil Company  
(Company or Operator)

W. F. Wallace 6 (Lease), Well No. 1, in (Unit) The well is located 1980 feet from the South line and 1980 feet from the West line of Section 6, T. 12, R. 38, NMPM. (GIVE LOCATION FROM SECTION LINE) Devonian Pool, Lea County

If State Land the Oil and Gas Lease is No.

If patented land the owner is W. F. Wallace Estate & Don Wallace

Address Lovington, New Mexico

We propose to drill well with drilling equipment as follows: Rotary

The status of plugging bond is.

Drilling Contractor Ralph Lowe Drilling Co.  
Midland, Texas

We intend to complete this well in the Devonian formation at an approximate depth of 12,200 feet.

CASING PROGRAM

We propose to use the following strings of Casing and to cement them as indicated:

Size of Hole	Size of Casing	Weight per Foot	New or Second Hand	Depth	Sacks Cement
	13 3/8	48	New	400	330
	8 5/8	24	New	3400	
	8 5/8	32	New	4450	100
	5 1/2	17	New	12200	400

If changes in the above plans become advisable we will notify you immediately.

ADDITIONAL INFORMATION (If recompletion give full details of proposed plan of work.)

Approved, 19.....  
Except as follows:

Sincerely yours,

Continental Oil Company  
(Company or Operator)

By

Position District Engineer  
Send Communications regarding well to

Name

Address

OIL CONSERVATION COMMISSION

By

NEW MEXICO OIL CONSERVATION COMMISSION

Well Location and Acreage Dedication Plat

Section A.

Date 7-15-57

Operator CONTINENTAL OIL CO. Lease W.F. WALLACE 6  
Well No. 1 Unit Letter K Section 6 Township 12-S Range 38-E NMPM  
Located 1980 Feet From WEST Line, 1980 Feet From SOUTH Line  
County LEA G. L. Elevation \_\_\_\_\_ Dedicated Acreage \_\_\_\_\_ Acres  
Name of Producing Formation Devonian Pool Madison

1. Is the Operator the only owner\* in the dedicated acreage outlined on the plat below?  
Yes X No \_\_\_\_\_.
2. If the answer to question one is "no," have the interests of all the owners been consolidated by communitization agreement or otherwise? Yes \_\_\_\_\_ No \_\_\_\_\_. If answer is "yes," Type of Consolidation \_\_\_\_\_
3. If the answer to question two is "no," list all the owners and their respective interests below:

Owner

Land Description

Section B

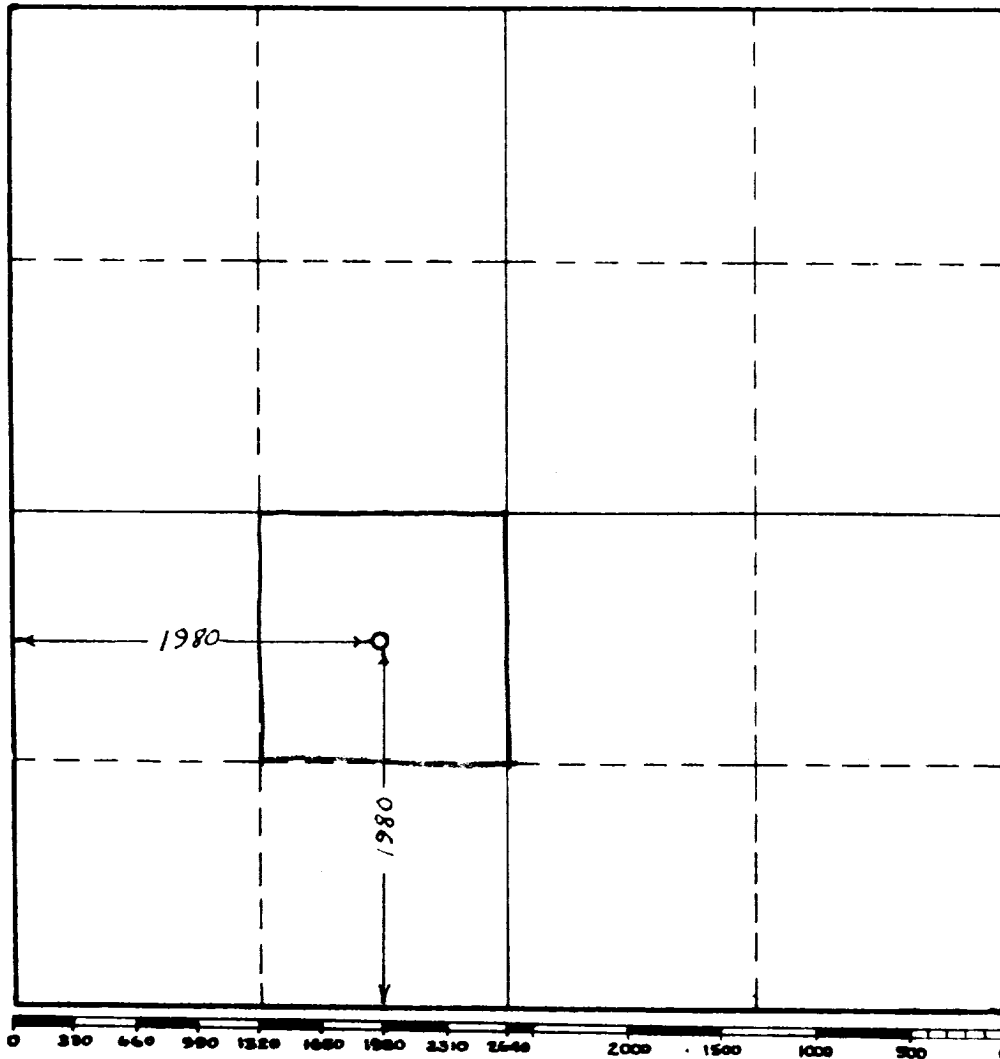

This is to certify that the information in Section A above is true and complete to the best of my knowledge and belief.

Continental Oil Company  
(Operator)

E. Heynion  
(Representative)

Box 427, Hobbs, New Mexico  
Address

This is to certify that the well location shown on the plat in Section B was plotted from field notes of actual surveys made by me or under my supervision and that the same is true and correct to the best of my knowledge and belief.

Date Surveyed 7-15-57

John W. West  
Registered Professional  
Engineer and/or Land Surveyor.

Certificate No. 676