

STATE OF NEW MEXICO  
ENERGY AND MINERALS DEPARTMENT

MINERAL CONSERVATION DIVISION  
P. O. BOX 2088  
SANTA FE, NEW MEXICO 87501

Form C-101  
Revised 10-1-78

NO. OF COPIES RECEIVED	
DISTRIBUTION	
SANTA FE	
FILE	
U.S.G.S.	
LAND OFFICE	
OPERATOR	

5A. Indicate Type of Lease  
STATE ☐ FEE ☒

5. State Oil & Gas Lease No.

APPLICATION FOR PERMIT TO DRILL, DEEPEN, OR PLUG BACK

1A. Type of Work

b. Type of Well  
DRILL ☐ DEEPEN ☐ PLUG BACK ☐  
OIL WELL ☒ GAS WELL ☐ X OTHER Re-Enter SINGLE ZONE ☐ MULTIPLE ZONE ☐

2. Name of Operator

Texas Resource Group, Inc.

3. Address of Operator

5944 Luther Lane, Dallas, TX 75225

4. Location of Well

UNIT LETTER \_\_\_\_\_ LOCATED 1980 FEET FROM THE North LINE  
AND 660 FEET FROM THE West LINE OF SEC. 8 TWP. 12S RGE. 38E NMPM

7. Unit Agreement Name

8. Farm or Lease Name

Harris

9. Well No.

#3

10. Field and Pool, or Wildcat  
Gladiola Miss.

12. County  
Lea

11,000'

Miss.

Workover Rig

11. Elevations (Show whether DE, RT, etc.)

S.L. 3867

21A. Kind of casing being used

Blanket

21B. Drilling Contractor

Cobra Drilling

22. Approx. Date Work will start

6-18-82

23.

PROPOSED CASING AND CEMENT PROGRAM

SIZE OF HOLE	SIZE OF CASING	WEIGHT PER FOOT	SETTING DEPTH	SACKS OF CEMENT	EST. TOP
17 1/2	13 3/8	42.2	372	400	Circ.
12 1/2	9 5/8	32-36 & 40	4495	2000	Circ.
7 7/8	5 1/2	17 & 20	12024	500	10,300'

This well was plugged on December 8, 1970 by Gulf Oil Corporation. We plan to re-enter same hole, tie back into 5 1/2 at 5106' and perforate and treat the Mississippi at 11,330' to 11,360' and 11,370' to 11,410'.

IN ABOVE SPACE DESCRIBE PROPOSED PROGRAM; IF PROPOSAL IS TO DEEPEN OR PLUG BACK, GIVE DATA ON PRESENT PRODUCTIVE ZONE AND PROPOSED NEW PRODUCTIVE ZONE. GIVE BLOWOUT PREVENTER PROGRAM, IF ANY.

I hereby certify that the information above is true and complete to the best of my knowledge and belief.

Signed Paul J. Adams Title Inspector Date 1-24-83

(This space for State Use)

APPROVED BY OIL & GAS INSPECTOR  
CONDITIONS OF APPROVAL, IF ANY:

DATE MAR 30 1983

RECEIVED

DIVISION

RECEIVED

MAR 29 1983

C.C.D.  
HOBBS OFFICE

# IL CONSERVATION DIVISIO

STATE OF NEW MEXICO  
ENERGY AND MINERALS DEPARTMENT

P. O. BOX 2088  
SANTA FE, NEW MEXICO 87501

Form C-102  
Revised 10-1-78

All distances must be from the outer boundaries of the Section.

Operator Texas Resource Group, Inc.			Lease Harris			Well No. #3		
Unit Letter E	Section 8	Township 12 South	Range 38 East	County Lea				
Actual Footage Location of Well: 1980 feet from the North line and 660 feet from the West line								
Ground Level Elev. 3867	Producing Formation Mississippi		Pool Gladiola Miss.			Dedicated Acreage: 40 Acres		

1. Outline the acreage dedicated to the subject well by colored pencil or hachure marks on the plat below.
2. If more than one lease is dedicated to the well, outline each and identify the ownership thereof (both as to working interest and royalty).
3. If more than one lease of different ownership is dedicated to the well, have the interests of all owners been consolidated by communitization, unitization, force-pooling, etc?

☒ Yes ☐ No If answer is "yes," type of consolidation Communitization

If answer is "no," list the owners and tract descriptions which have actually been consolidated. (Use reverse side of this form if necessary.)

No allowable will be assigned to the well until all interests have been consolidated (by communitization, unitization, forced-pooling, or otherwise) or until a non-standard unit, eliminating such interests, has been approved by the Division.

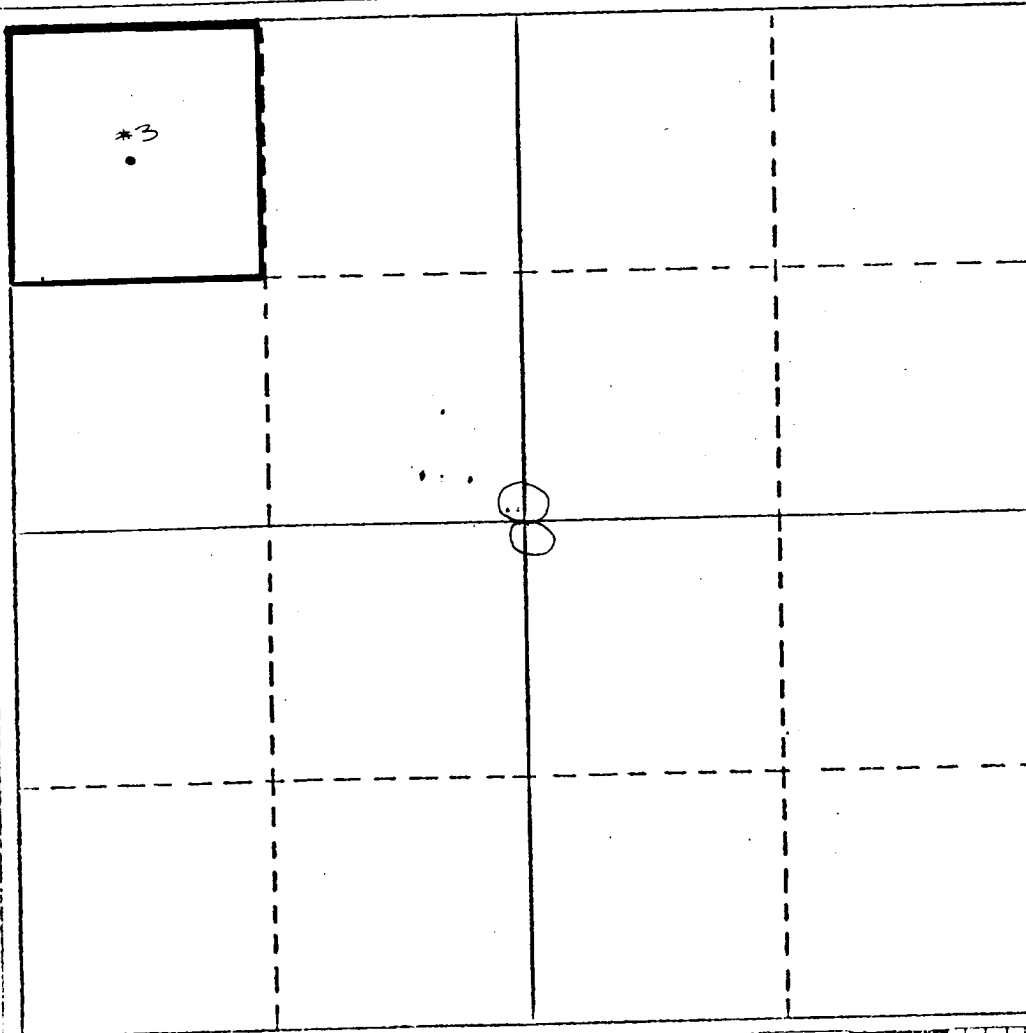

## CERTIFICATION

I hereby certify that the information contained herein is true and complete to the best of my knowledge and belief.

Name  
Paul J. Adams

Position  
Engineer

Company  
Texas Resource Group, Inc

Date  
1-24-83

I hereby certify that the well location shown on this plat was plotted from field notes of actual surveys made by me or under my supervision, and that the same is true and correct to the best of my knowledge and belief.

6-11-83

Date Surveyed

Registered Professional Engineer and/or Land Surveyor

Paul J. Adams

Certificate No.

#8720 - Oklahoma

RECEIVED

1983 MAR 29  
HOBBS DIVISION

RECEIVED  
MAR 29 1983  
C.D.D.  
HOBBS OFFICE