

NEW MEXICO OIL CONSERVATION COMMISSION

Form C-101

Revised (12/1/55)

Santa Fe, New Mexico

NOTICE OF INTENTION TO DRILL

Notice must be given to the District Office of the Oil Conservation Commission and approval obtained before drilling or recompletion begins. If changes in the proposed plan are considered advisable, a copy of this notice, showing such changes will be returned to the sender. Submit this notice in QUINTUPLICATE. One copy will be returned following approval. See additional instructions in Rules and Regulations of the Commission. If State Land submit 6 Copies Attach Form C-128 in triplicate to first 3 copies of form C-101

MIDLAND, TEXAS

JULY 11, 1962

(Place)

(Date)

OIL CONSERVATION COMMISSION
SANTA FE, NEW MEXICO

Gentlemen:

You are hereby notified that it is our intention to commence the Drilling of a well to be known as

CHAMBERS & KENNEDY

(Company or Operator)

FIELD STATE

(Lease)

Well No. 1

P

The well is

located 660 feet from the SOUTH line and 660 feet from the

EAST

Line of Section 10, T. 12-S, R. 39-E, NMPM.

(GIVE LOCATION FROM SECTION LINE)

UNDERSIGNED

Pool,

LEA

County

If State Land the Oil and Gas Lease is No. E9111

If patented land the owner is

Address

We propose to drill well with drilling equipment as follows: ROTARY TOOLS
FROM SURFACE TO T.D.

The status of plugging bond is: MARYLAND CASUALTY COMPANY
BLANKET BOND

Drilling Contractor B. L. McFARLAND DRILLING COMPANY, INC.
3612 W. WALL STREET MIDLAND, TEXAS

We intend to complete this well in the DEVONIAN
formation at an approximate depth of 12,300 feet.

CASING PROGRAM

We propose to use the following strings of Casing and to cement them as indicated:

Size of Hole	Size of Casing	Weight per Foot	New or Second Hand	Depth	Sacks Cement
17 1/2"	13 3/8"	48, H-40	NEW	385	325 *
11	8 5/8"	24, 32 J-55	NEW	4550	300
7 7/8"	5 1/2"	15.5 & 17#	NEW	12,300	350 * *

If changes in the above plans become advisable we will notify you immediately.

ADDITIONAL INFORMATION (If recompletion give full details of proposed plan of work.)

APPROVAL MUST BE CIRCULATED BEHIND
Except as follows:

CASING

OIL CONSERVATION COMMISSION

By

Sincerely yours,

CHAMBERS & KENNEDY

(Company or Operator)

By W. J. ALEXANDER W. J. ALEXANDER

Position ENGINEER

Send Communications regarding well to

Name CHAMBERS & KENNEDY

Address 607 MIDLAND NAT'L BANK BLDG.

NEW MEXICO OIL CONSERVATION COMMISSION
WELL LOCATION AND ACRES DEDICATION PLAT

FORM C-128
Revised 5/1/57

SEE INSTRUCTIONS FOR COMPLETING THIS FORM ON THE REVERSE SIDE

Operator CHAMBERS & KENNEDY		Lease 1952 JUL 12 PM 3:00 FIELD STATE		Well No. 1-10
Unit Letter P	Section 10	Township 12 SOUTH	Range 38 EAST	County LKA
Actual Footage Location of Well: 660 feet from the SOUTH line and 660 feet from the EAST line				
Ground Level Elev. 3822.10	Producing Formation DEVONIAN	Pool UNDESIGNATED	Dedicated Acres: 40.00 Acres	

1. Is the Operator the only owner in the dedicated acreage outlined on the plat below? YES ☒ NO ☐ ("Owner" means the person who has the right to drill into and to produce from any pool and to appropriate the production either for himself or for himself and another. (63-3-29 (e) NMSA 1935 Comp.)
2. If the answer to question one is "no," have the interests of all the owners been consolidated by communitization agreement or otherwise? YES ☐ NO ☐ If answer is "yes," Type of Consolidation _____
3. If the answer to question two is "no," list all the owners and their respective interests below:

Owner	Land Description

SECTION B

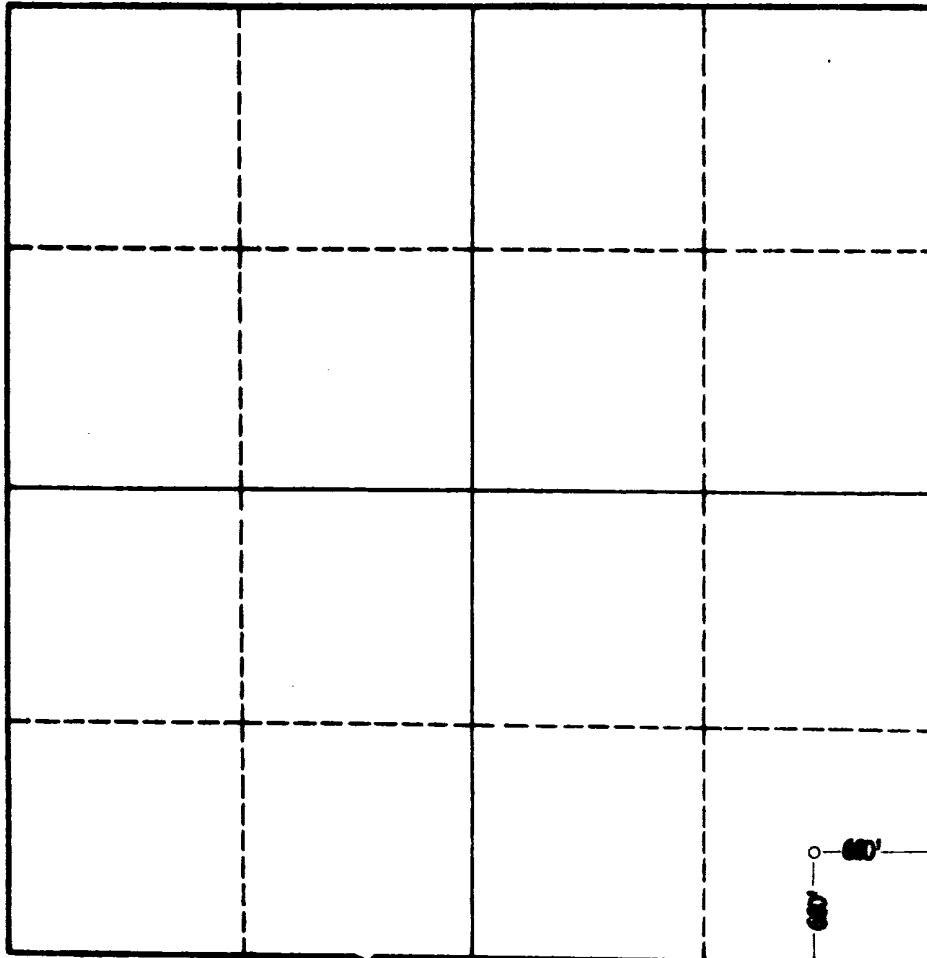

CERTIFICATION

I hereby certify that the information in SECTION A above is true and complete to the best of my knowledge and belief.

W. J. ALEXANDER

Name	W. J. Alexander
Position	ENGINEER
Company	CHAMBERS & KENNEDY
Date	JULY 11, 1962

I hereby certify that the well location shown on the plat in SECTION B was plotted from field notes of actual survey made by me or under my supervision, and that the same is true and correct to the best of my knowledge and belief.

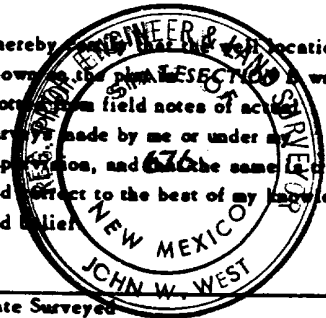

Date Surveyed	7-9-62
Registered Professional Engineer and/or Land Surveyor, JOHN W. WEST	
John W. West	
Certificate No.	N. M. - P. E. & L. S. NO. 676

0 350 640 990 1320 1660 1980 2300 2640 2000 1500 1000 500 0