

NO. OF COPIES RECEIVED		
DISTRIBUTION		
SANTA FE		
FILE		
U.S.G.S.		
LAND OFFICE		
OPERATOR		

# NEW MEXICO OIL CONSERVATION COMMISSION

Form C-101  
Revised 1-1-65

5A. Indicate Type of Lease STATE <input checked="" type="checkbox"/> FILE <input type="checkbox"/>
5. State Oil & Gas Lease No. <b>LG-0043</b>
7. Unit Agreement Name
8. Firm or Lease Name <b>Brian State</b>
9. Well No. <b>1</b>
10. Field and Pool, or Wildcat <b>Gladiola Devonian</b>
12. County <b>Lea</b>
19. Proposed Depth <b>12,000</b>
19A. Formation <b>Devonian</b>
20. History or C.T.
21B. Drilling Contractor <b>Eunice Well Servicing Co.</b>
22. Approx. Date Work will start <b>12/3/79</b>

## APPLICATION FOR PERMIT TO DRILL, DEEPEN, OR PLUG BACK

1a. Type of Work	DRILL <input type="checkbox"/>	DEEPEN <input type="checkbox"/>	PLUG BACK <input type="checkbox"/>
b. Type of Well	OIL WELL <input checked="" type="checkbox"/>	GAS WELL <input type="checkbox"/>	OTHER <b>Re-entry</b>
2. Name of Operator	<b>Elk Oil Company</b>		
3. Address of Operator	<b>P.O. Box 310, Roswell, New Mexico 88201</b>		
4. Location of Well	UNIT LETTER <b>A</b> LOCATED <b>330</b> FEET FROM THE <b>North</b> LINE		
AND <b>990</b> FEET FROM THE <b>FFL</b> LINE OF SEC. <b>19</b> TWP. <b>12S</b> RGE. <b>38E</b> NMPM			
21A. Kind & Status Plug. Bond <b>Blanket</b>	21B. Drilling Contractor <b>Eunice Well Servicing Co.</b>		
21. Elevations (Show whether DF, RL, etc.)	22. Approx. Date Work will start <b>12/3/79</b>		

## PROPOSED CASING AND CEMENT PROGRAM

SIZE OF HOLE	SIZE OF CASING	WEIGHT PER FOOT	SETTING DEPTH	SACKS OF CEMENT	EST. TOP
17	13 3/8	48	343	350	circ
11	8 5/8	32	4650	650	1500
7 7/8	5 1/2	17	11,978	150	9500

Plan to re-enter, tie 5½" casing together @ 5300' and clean out to TD.  
Perforate and test Devonian and if commercial, place on production.

Well originally drilled in 1957 by Texas Crude Oil Co. as their #2-19 State "A"

IN ABOVE SPACE DESCRIBE PROPOSED PROGRAM; IF PROPOSAL IS TO DEEPEN OR PLUG BACK, GIVE DATA ON PRESENT PRODUCTIVE ZONE AND PROPOSED NEW PRODUCTIVE ZONE. GIVE BLOWOUT PREVENTER PROGRAM, IF ANY.

I hereby certify that the information above is true and complete to the best of my knowledge and belief.

Signed  Title President Date 11/28/79  
(This space for State Use)

APPROVED BY  TITLE SUPERVISOR DISTRICT 1 DATE NOV 30 1979

CONDITIONS OF APPROVAL, IF ANY:

**NEW MEXICO OIL CONSERVATION COMMISSION  
WELL LOCATION AND ACREAGE DEDICATION PLAT**

Form C-102  
Supersedes C-128  
Effective 1-1-65

All distances must be from the outer boundaries of the Section.

Operator <b>Elk Oil Company</b>			Lease <b>Brian State</b>		Well No. <b>1</b>
Unit Letter <b>A</b>	Section <b>19</b>	Township <b>12S</b>	Range <b>38E</b>	County <b>Lea</b>	
Actual Footage Location of Well:					
<b>330</b> feet from the <b>North</b> line and		<b>990</b> feet from the <b>East</b> line			
Ground Level Elev.	Producing Formation <b>Devonian</b>	Pool <b>Gladiola</b>	Dedicated Acreage: <b>40</b> Acres		

1. Outline the acreage dedicated to the subject well by colored pencil or hachure marks on the plat below.
2. If more than one lease is dedicated to the well, outline each and identify the ownership thereof (both as to working interest and royalty).
3. If more than one lease of different ownership is dedicated to the well, have the interests of all owners been consolidated by communitization, unitization, force-pooling, etc?

☐ Yes    ☐ No    If answer is "yes," type of consolidation \_\_\_\_\_

If answer is "no," list the owners and tract descriptions which have actually been consolidated. (Use reverse side of this form if necessary.) \_\_\_\_\_

No allowable will be assigned to the well until all interests have been consolidated (by communitization, unitization, forced-pooling, or otherwise) or until a non-standard unit, eliminating such interests, has been approved by the Commission.

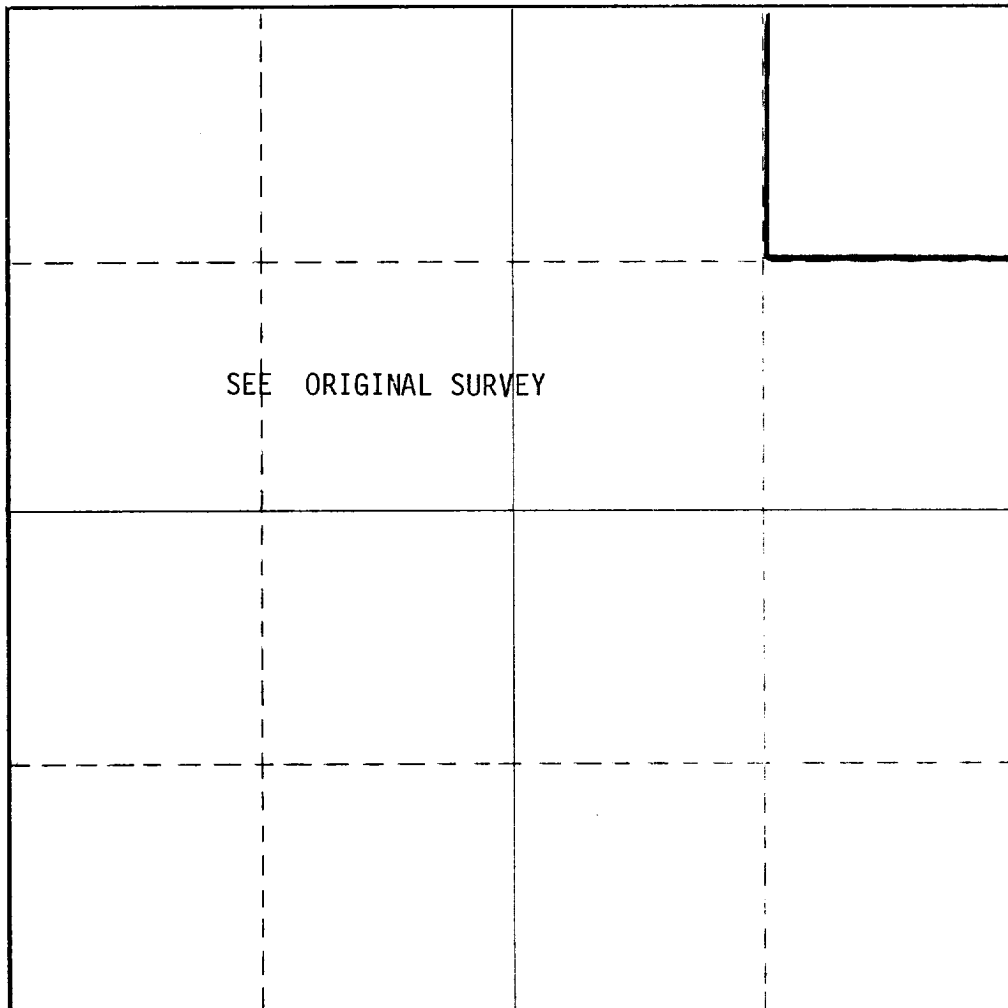

**CERTIFICATION**

*I hereby certify that the information contained herein is true and complete to the best of my knowledge and belief.*

*[Signature]*

Name  
**Joseph J. Kelly**

Position  
**President**

Company  
**Elk Oil Company**

Date  
**11/28/79**

*I hereby certify that the well location shown on this plat was plotted from field notes of actual surveys made by me or under my supervision, and that the same is true and correct to the best of my knowledge and belief.*

Date Surveyed \_\_\_\_\_

Registered Professional Engineer  
and/or Land Surveyor

Certificate No. \_\_\_\_\_

