

NEW MEXICO OIL CONSERVATION COMMISSION
Well Location and Acreage Dedication Plat

Section A.

Date Sept. 4, 1959
PROBBS OFFICE OCC

Operator Tidewater Oil Company Lease State "K"
Well No. 2 Unit Letter G&H Section 27 Township 35S Range 34-E NMPM
Located 1980 Feet From North Line, 660 Feet From East Line
County Lea G. L. Elevation _____ Dedicated Acreage 80.5 Acres
Name of Producing Formation Ranger Lake Perm Pool Ranger Lake Penn

1. Is the Operator the only owner* in the dedicated acreage outlined on the plat below?
Yes X No _____.
2. If the answer to question one is "no," have the interests of all the owners been consolidated by communitization agreement or otherwise? Yes _____ No _____. If answer is "yes," Type of Consolidation _____
3. If the answer to question two is "no," list all the owners and their respective interests below:

Owner

Land Description

Section B

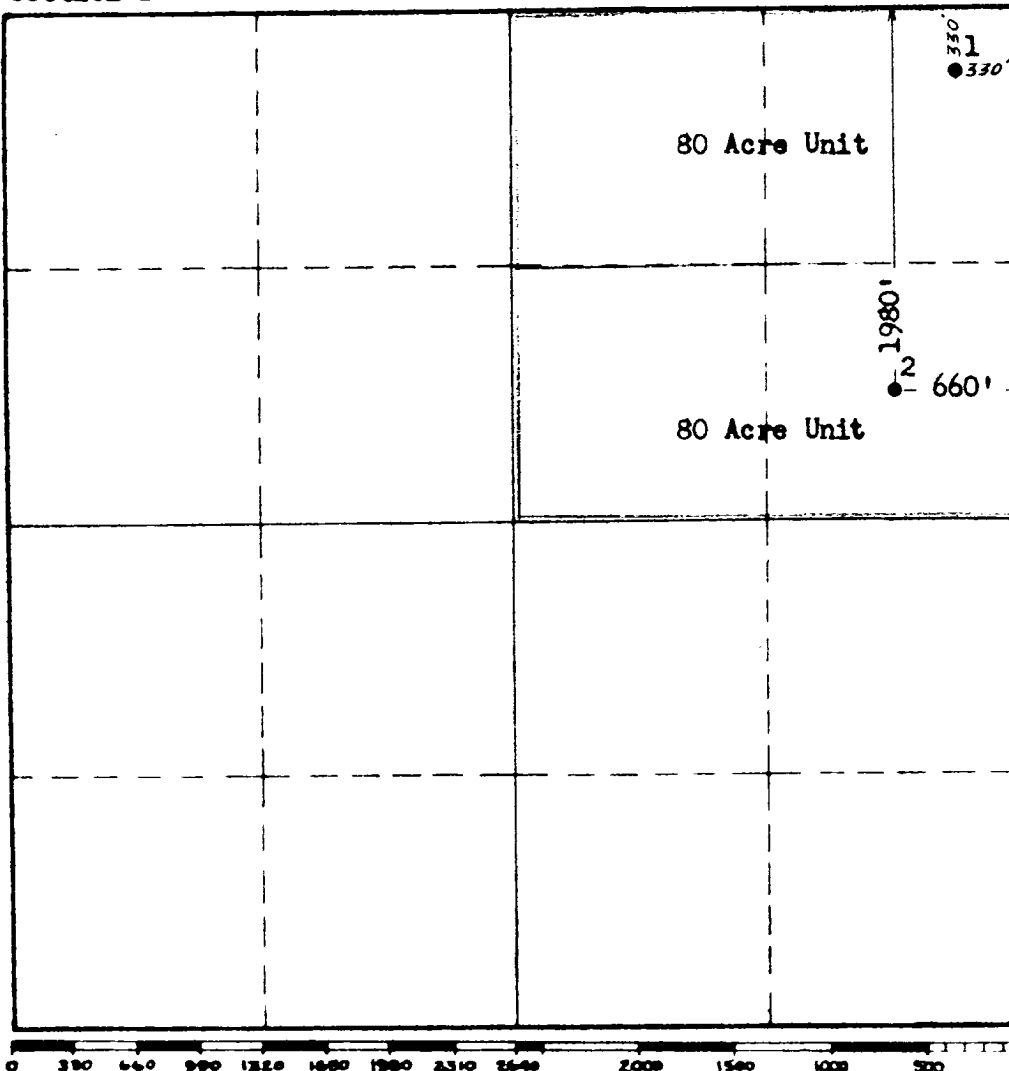

This is to certify that the information in Section A above is true and complete to the best of my knowledge and belief.

Tidewater Oil Company

(Operator)

J. M. Amis
(Representative)

Box #1231, Midland, Texas
Address

This is to certify that the well location shown on the plat in Section B was plotted from field notes of actual surveys made by me or under my supervision and that the same is true and correct to the best of my knowledge and belief.

Date Surveyed Sept. 4, 1959

J. M. Amis (Company Employee)
Registered Professional Engineer and/or Land Surveyor.

Certificate No. 5129 and 465