

COUNTY	LEA	FIELD	Ranger Lake	STATE	NM MN 08445
OPR	GETTY OIL CO.			MAP	
	1 State "BF"				
	Sec 27, T-12-S, R-34-E			CO-ORD	
	330' FNL, 330' FEL of Sec				
	Re-Cmp 1-4-72	CLASS	OWOF		EL
		FORMATION	DATUM	FORMATION	DATUM
CSG & SX - TUBING					
13 3/8" at 361' w/300 sx					
8 5/8" at 4330' w/1000 sx					
5 1/2" at 10,345' w/600 sx					
LOGS EL GR RA IND HC A					
	TD 10,350'; PBD 10,060'				
TEMPORARILY ABANDONED					

Distribution limited and publication prohibited by subscribers' agreement.
Reproduction rights reserved by Williams & Lee Scouting Service, Inc.

CONT. PROP DEPTH 10,020' TYPE WO
DATE

F.R.C. 1-20-72; Opr's Elev. 4153' GL
PD 10,020' WO (Bough "C")
(Orig. Tidewater Oil Co. #1 State "K", comp
7-28-59 thru (Pennsylvanian) Perfs 10,226-333',
OTD 10,350', OPB 10,342', Converted to WIW
2-23-65)
1-17-72 TD 10,350'; PBD 10,060'; TEMPORARILY ABANDONED
PB to 10,060'
Perf (Bough "C") 9959-76', 10,000-012',
10,014-020' w/1 SPF
Acid (9959-10,020') 1000 gals (15%)
Swbd 74 BLW (no shows oil or gas) in 7 hrs
(9959-10,020')
1-20-72 COMPLETION REPORTED

NEW MEXICO OIL CONSERVATION COMMISSION
Well Location and Acreage Dedication Plat

Section A.

Date Sept. 4, 1959

Operator Tidewater Oil Company MOSSS OFFICE OCC Lease State "K"
Well No. 1 Unit Letter A&B Section 27 Township 12-S Range 34-E NM
located 330 Feet From North 100 Feet From East Li
County Lea G. L. Elevation 10027 Dedicated Acreage 80 per
Name of Producing Formation Ranger Lake Penn Pool Ranger Lake Penn

1. Is the Operator the only owner* in the dedicated acreage outlined on the plat below?
Yes X No .
2. If the answer to question one is "no," have the interests of all the owners been consolidated by communitization agreement or otherwise? Yes No . If answer is "yes," Type of Consolidation
3. If the answer to question two is "no," list all the owners and their respective interests below:

Owner

Land Description

Section B

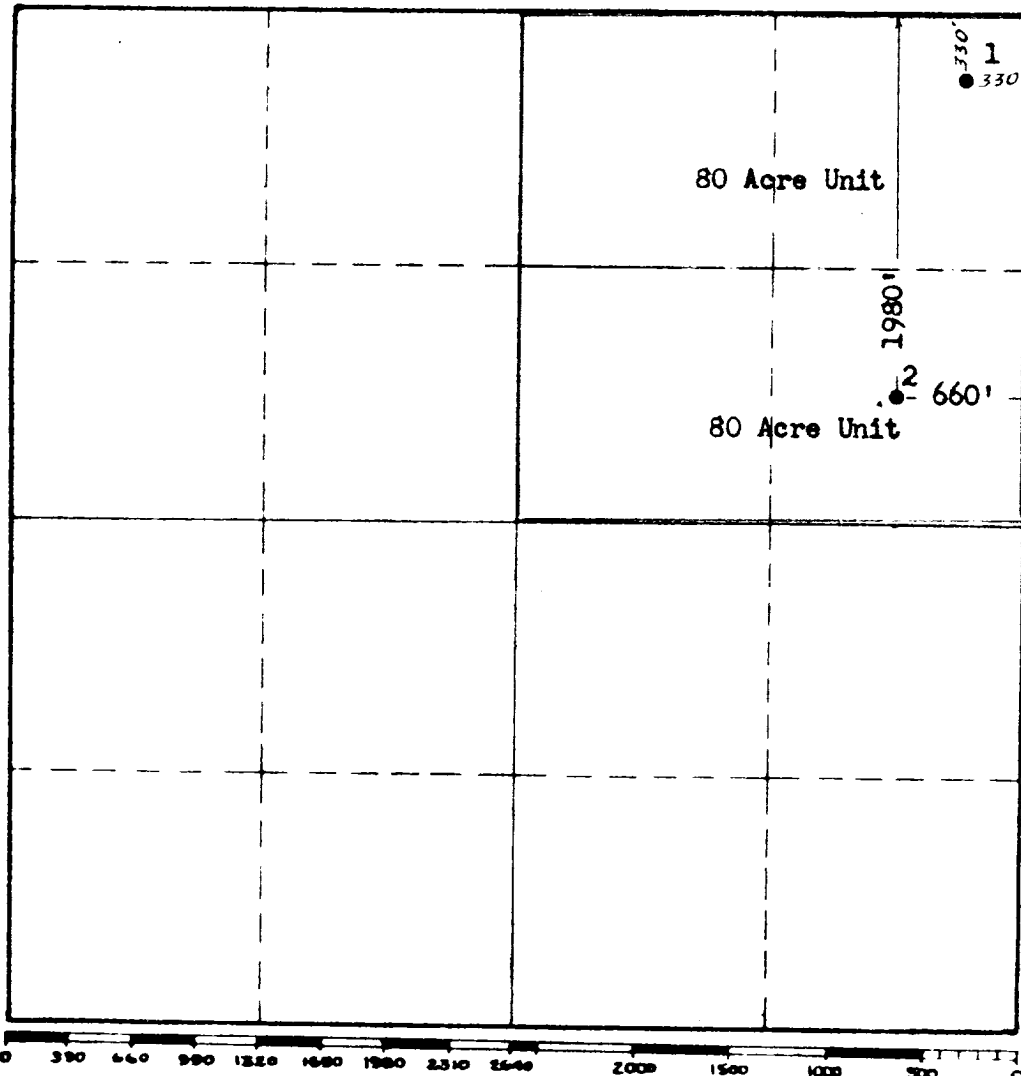

This is to certify that the information in Section A above is true and complete to the best of my knowledge and belief.

Tidewater Oil Company
(Operator)

J. M. Davis
(Representative)

Box #1231, Midland, Texas
Address

This is to certify that the well location shown on the plat in Section B was plotted from field notes of actual surveys made by me or under my supervision and that the same is true and correct to the best of my knowledge and belief.

Date Surveyed Sept. 4, 1959

J. M. Davis (Company Employee)
Registered Professional
Engineer and/or Land Surveyor.

Certificate No. 5129 and 465