

NEW MEXICO OIL CONSERVATION COMMISSION  
WELL LOCATION AND ACREAGE DEDICATION PLAT

FORM C-128  
Revised 5/1/57

SEE INSTRUCTIONS FOR COMPLETING THIS FORM ON THE REVERSE SIDE

SECTION A

Operator <b>A. A. CAMERON</b>		Lease <b>MAR 21 PM 3</b>		Well No. <b>14</b>	
Unit Letter <b>J</b>	Section <b>15</b>	Township <b>12 SOUTH</b>	Range <b>36 EAST</b>	County <b>LEA</b>	
Actual Footage Location of Well: <b>1980</b> feet from the <b>SOUTH</b> line and <b>1980</b> feet from the <b>EAST</b> line					
Ground Level Elev. <b>3986.5</b>	Producing Formation		Pool <b>Wildcat</b>	Dedicated Acreage: <b>160</b> Acres	

1. Is the Operator the only owner in the dedicated acreage outlined on the plat below? YES \_\_\_\_\_ NO **X**. ("Owner" means the person who has the right to drill into and to produce from any pool and to appropriate the production either for himself or for himself and another. (65-3-29 (e) NMSA 1955 Comp.)
2. If the answer to question one is "no," have the interests of all the owners been consolidated by communication agreement or otherwise? YES **X** NO \_\_\_\_\_. If answer is "yes," Type of Consolidation **Operating Agreement**
3. If the answer to question two is "no," list all the owners and their respective interests below:

Owner <b>Sunny Mid-Continent Oil Company</b>	Lease Description <b>NE 1/4 Sec. 15, T-12 South, R-36 East</b>
---	---

SECTION B

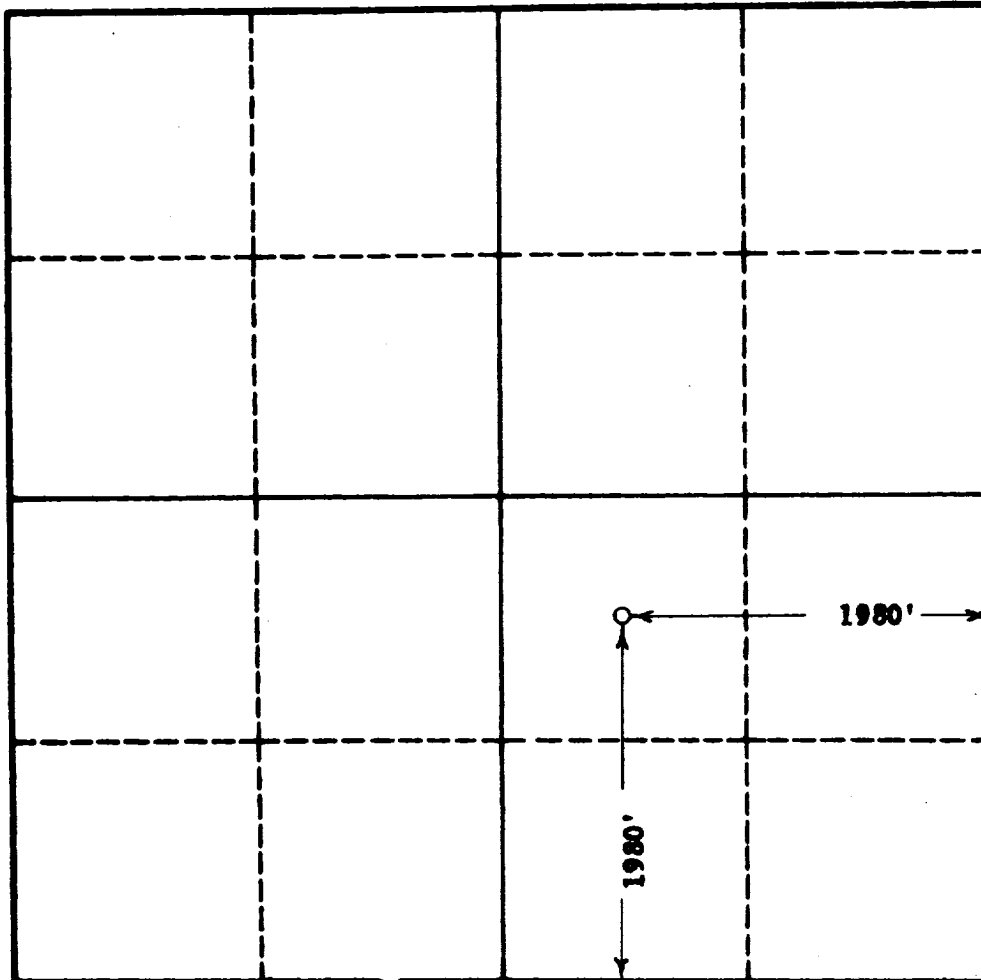

CERTIFICATION

I hereby certify that the information in SECTION A above is true and complete to the best of my knowledge and belief.

Name <b>Carlyle Fields</b>
Position <b>Production Clerk</b>
Company <b>A. A. Cameron Oil Company</b>
Date <b>March 24, 1963</b>

I hereby certify that the well location shown on the plat in SECTION B was plotted from field notes of actual surveys made by me or under my supervision, and that the same are true and correct to the best of my knowledge and belief.

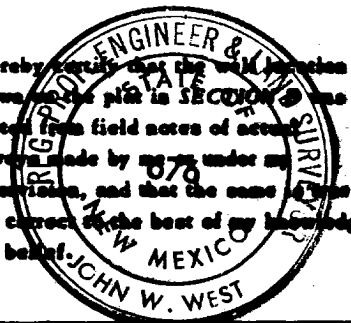

Date Surveyed <b>3-5-1963</b>
Registered Professional Engineer and/or Land Surveyor, <b>JOHN W. WEST</b>
Certificate No. <b>JOHN W. WEST</b>
N.M. - P.E. & L.S. NO. 876

