

NOTICE OF INTENTION TO DRILL

Notice must be given to the District Office of the Oil Conservation Commission and approval obtained before drilling or recompletion begins. If changes in the proposed plan are considered advisable, a copy of this notice showing such changes will be returned to the sender. Submit this notice in QUINTUPPLICATE. One copy will be returned following approval. See additional instructions in Rules and Regulations of the Commission.

If State Land submit 6 Copies Attach Form C- 128 in triplicate to first 3 copies of form C-101

2000 Wilco Building

(Place)

December 3, 1964

(Date)

OIL CONSERVATION COMMISSION
SANTA FE, NEW MEXICO

Gentlemen:

You are hereby notified that it is our intention to commence the Drilling of a well to be known as

Delaware Apache Corporation

(Company or Operator)

High Plains Unit

(Lease)

Well No. 1, in A The well is

located 660 feet from the North line and 660 feet from the East

(GIVE LOCATION FROM SECTION LINE)

Line of Section 22, T 14S, R 34E, NMPM.

Pool, Lea County

If State Land the Oil and Gas Lease is No. E-9697

If patented land the owner is No

Address

We propose to drill well with drilling equipment as follows: Rotary

The status of plugging bond is State wide blanket bond (active)

Drilling Contractor A. W. Thompson, Inc.

We intend to complete this well in the Lower Wolfcamp formation at an approximate depth of 10,700 feet.

CASING PROGRAM

We propose to use the following strings of Casing and to cement them as indicated:

Size of Hole	Size of Casing	Weight per Foot	New or Second Hand	Depth	Sacks Cement
15"	11 3/4"	42	New	350	Circulate
11"	8 5/8"	24 & 32	New	4400	400
7 7/8"	4 1/2"	11.6 & 13.5	New	10700	400

If changes in the above plans become advisable we will notify you immediately.

ADDITIONAL INFORMATION (If recompletion give full details of proposed plan of work.)

Approved: , 19
Except as follows:

OIL CONSERVATION COMMISSION

By:

Sincerely yours,

Delaware - Apache Corporation

(Company or Operator)

By: Larry Shannon

Position: Division Engineer

Send Communications regarding well to

Name: Apache Corporation

Address: 2000 Wilco Building, Midland, Texas

NEW MEXICO OIL CONSERVATION COMMISSION
WELL LOCATION AND ACREAGE DEDICATION PLAT

FORM C-128
Revised 5/1/57

SEE INSTRUCTIONS FOR COMPLETING THIS FORM ON THE REVERSE SIDE

SECTION A

Operator DELAWARE APACHE CORP.			Lease HIGH PLAINS UNIT		Well No. 1
Unit Letter A	Section 22	Township 14 SOUTH	Range 34 EAST	County LEA	
Actual Postage Location of Well: 660 feet from the NORTH line and 660 feet from the EAST line					
Ground Level Elev. 4103.9	Producing Formation Lower Wolfcamp		Pool Undesignated	Dedicated Acreage: 40 Acres	

1. Is the Operator the only owner in the dedicated acreage outlined on the plat below? YES _____ NO X. ("Owner" means the person who has the right to drill into and to produce from any pool and to appropriate the production either for himself or for himself and another. (65-3-29 (e) NMSA 1935 Comp.)
2. If the answer to question one is "no," have the interests of all the owners been consolidated by communitization agreement or otherwise? YES X NO _____. If answer is "yes," Type of Consolidation Unit Operating Agreement
3. If the answer to question two is "no," list all the owners and their respective interests below:

Owner	Land Description

SECTION B

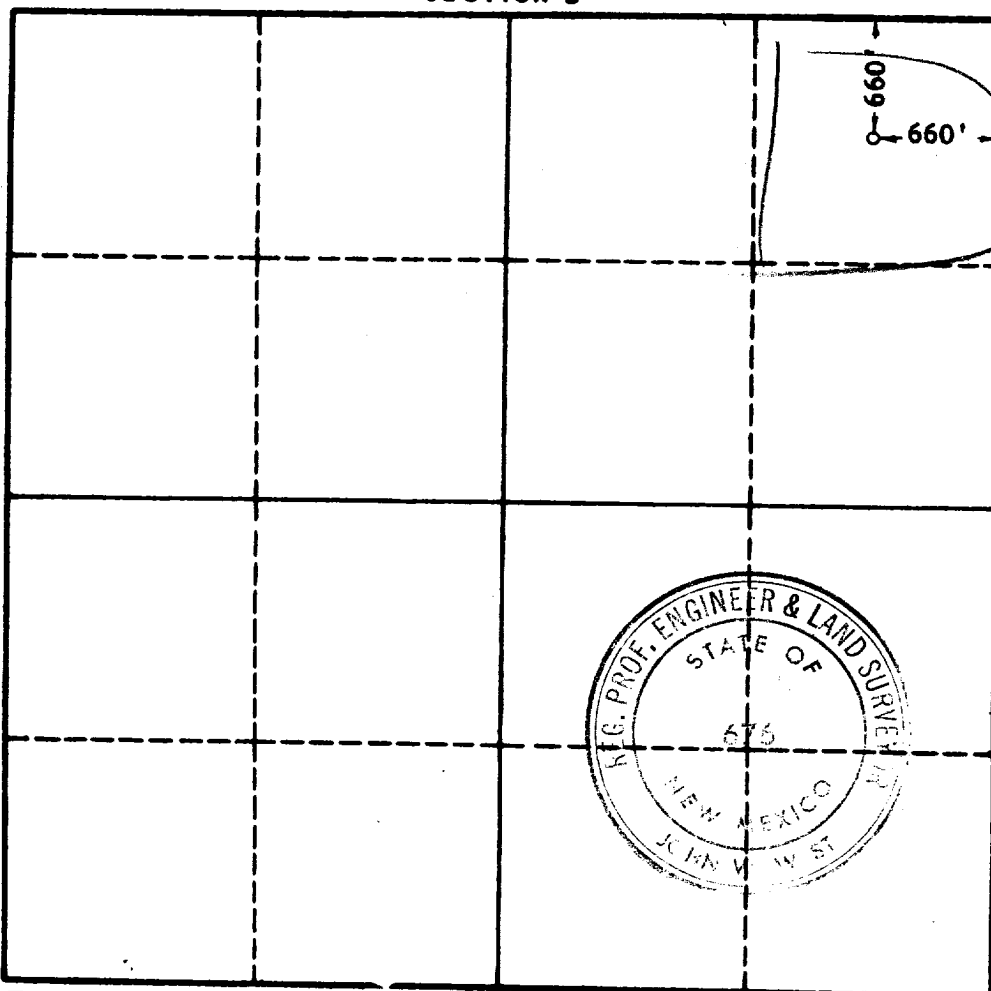

CERTIFICATION

I hereby certify that the information in SECTION A above is true and complete to the best of my knowledge and belief.

Name <u>Sally Shanna</u>
Position Division Engineer
Company Delaware - Apache Corp.
Date December 3, 1964

I hereby certify that the well location shown on the plat in SECTION B was plotted from field notes of actual surveys made by me or under my supervision, and that the same is true and correct to the best of my knowledge and belief.

Date Surveyed DECEMBER 1, 1964
Registered Professional Engineer and/or Land Surveyor, JOHN W. WEST
<u>John W. West</u>
Certificate No. N. M. - P. E. & L. S. NO. 676

0 330 660 990 1320 1650 1980 2310 2640 2000 1600 1200 800 400 0