

OWWO

COUNTY LEA FIELD Wildcat STATE MN 21310

OPR BLACKROCK OIL CO. MAP

1 State "CY"

Sec 30, T-12-S, R-34-E CO-ORD

660' FSL, 612' FWL of Sec

	CLASS		EL	
	FORMATION	DATUM	FORMATION	DATUM
Re-Cmp 8-28-72				
CSG & SX - TUBING				
13 3/8" at 410' w/375 sx				
8 5/8" at 4091' w/800 sx				
5 1/2" at 10,374' w/525 sx				
LOGS EL GR RA IND HC A				
	TD 10,374'; PBD 9644'			

IP (Wolfcamp) Perfs 9326-74' P 48 BOPD. Pot based on 24 hr test.
GOR 1050; Grav NR

Distribution limited and publication prohibited by subscribers' agreement.
Reproduction rights reserved by Williams & Lee Scouting Service, Inc.

CONT. PROP DEPTH 9374' TYPE WO
DATE

F.R.C. 9-16-72; Opr's Elev. 4226' DF
PD 9374' WO (Wolfcamp)
(Orig. Pan American Pet. Corp., comp 10-22-65
thru (Pennsylvanian) Perfs 10,226-252', OTD
10,374', OPB 10,300'; OWWO by Blackrock Oil Co.
& comp 4-15-71 thru (Upper Pennsylvanian) Perfs
9782-9862', OPB 9896')
9-11-72 TD 10,374'; PBD 9644' COMPLETE
PB to 9644'
Perf 9326-30', 9366-74' w/1 SPF
Acid (9326-74') 3000 gals
9-16-72 COMPLETION REPORTED

OWWO

COUNTY LEA FIELD Hightower, E. STATE NM MN 21310
 OPR BLACKROCK OIL CO. MAP
 1 State "CY"
 Sec 30, T-12-S, R-34-E CO-ORD
 660' FSL, 612' FWL of Sec

		CLASS		EL 42262	
Re-Cmp 4-15-71		FORMATION	DATUM	FORMATION	DATUM
CSG & SX - TUBING					
13 3/8" at 410' w/375 sx					
8 5/8" at 4091' w/800 sx					
5 1/2" at 10,374' w/525 sx.					
LOGS EL GR RA IND HC A					
		TD 10,374'; PBD 9896'			

IP (Upper Pennsylvanian) Perfs 9782-9862' Swbd 108 BOPD. Pot
 based on 24 hr test. GOR TSTM.

Distribution limited and publication prohibited by subscribers' agreement.
 Reproduction rights reserved by Williams & Lee Logging Service, Inc.

CONT. PROP DEPTH 9862' TYPE WO
 DATE

5-3-71 F.R.C. 5-6-71; Opr's Elev. 4229' KB
 PD 9862' WO (Upper Pennsylvanian)
 (Orig. Pan American Pet. Corp., comp 10-22-65
 thru Perfs 10,226-252', OTD 10,374', OPB 10,300')
 TD 10,374'; PBD 9896'; COMPLETE
 BP @ 9896'
 Perf @ 9782', 9783', 9798', 9801', 9803', 9841',
 9842', 9861', 9862' w/1 SPI
 Acid (9782-9862') 2500 gals
 5-6-71 COMPLETION REPORTED

COUNTY	LEA	FIELD	Hightower, East	STATE	NM
OPR	PAN AMERICAN PETROLEUM CORP.				MAP
	1	State "CY"			
	Sec. 30, T-12-S, R-34-E				CO-ORD
	660' fr S Line & 612' fr W Line of Sec.				
	Spd 9-5-65				
	Cmp 10-22-65	CLASS			
		FORMATION	DATUM	FORMATION	DATUM
CSG & SX - TUBING					
	13 3/8" 410' 375				
	8 5/8" 4091' 800				
	5 1/2" 10374' 525				
LOGS EL GR RA IND HC A					
	TD 10374', PBD 10300'				

IP Pennsylvanian Perfs 10226-252' Flwd 342 BOPD. Pot. Based on 24 hr test thru 14/64" chk., TP 1060#, gravity 43., GOR 1050.

Distribution limited and publication prohibited by subscribers' agreement.
Reproduction rights reserved by Williams & Lee Scouting Service, Inc.

CONT. Cactus Drlg. Co.

PROP DEPTH 10,400' TYPE

F.R. 9-9-65; Opr's Elev. 4229' KB
 PD 10,400' - Pennsylvanian
 Contractor - Cactus Drlg. Co.
 9-7-65 Drlg. 450'.
 9-13-65 TD 4091', WOC.
 9-20-65 Drlg. 6414'.
 9-27-65 Drlg. 8306'.
 10-4-65 Drlg. 9436'.
 10-11-65 Drlg. 10143'.
 DST (Bough "A") 9905-97', open 3 hrs,
 GTS 2 hrs 30 mins @ TSTM,
 rec 15' free oil, 1500' WB, 900' GCM +
 3870' salt wtr,
 1 hr ISIP 3560#, FP 1200-2613#,
 1 hr FSIP 3302#.

10-18-65 TD 10374', prep to drill out.
DST 10200-305', open 3 hrs,
GTS 37 mins,
rec 1500' WB, 7860' HGC Oil + 120' DM,
1 hr ISIP 3759#, FP 1175-2257#,
1 hr FSIP 3759#.

10-25-65 TD 10374', PBD 10300', COMPLETED.
Perf 10335-342' W/2 SPF
Ac. 1000 gals.
Swbd 38 BLW in 13 hrs & swbd down
Did not rec load.
Set BP @ 10300'
Perf 10226-252' W/2 SPF
Ac. 2000 gals.
(Holding for tops)

11-1-65 TD 10374', PBD 10300', Completion Reported.
LOG TOPS: Wolfcamp 9110', Bough Pay
9826', Ranger Lake 10217'.

HOBBBS OFFICE O. C. C.
NEW MEXICO OIL CONSERVATION COMMISSION
WELL LOCATION AND ACREAGE DEDICATION PLAT

Form C-102
Supersedes C-128
Effective 1-1-65

APR 28 7 34 AM '66

All distances must be from the outer boundaries of the Section.

Operator PAN AMERICAN PETROLEUM CORP.			Lease STATE "CY"		Well No. 1
Unit Letter M	Section 30	Township 12 SOUTH	Range 34 EAST	County LEA	
Actual Footage Location of Well:					
660 feet from the SOUTH		line and 612		feet from the WEST	
Ground Level Elev. 4229' RDB	Producing Formation LOWER PENN	Pool HIGHTOWER LOWER PENN, EAST		Dedicated Acreage: 80 Acres	

1. Outline the acreage dedicated to the subject well by colored pencil or hachure marks on the plat below.
2. If more than one lease is dedicated to the well, outline each and identify the ownership thereof (both as to working interest and royalty).
3. If more than one lease of different ownership is dedicated to the well, have the interests of all owners been consolidated by communitization, unitization, force-pooling, etc?

☐ Yes ☐ No If answer is "yes," type of consolidation _____

If answer is "no," list the owners and tract descriptions which have actually been consolidated. (Use reverse side of this form if necessary.) _____

No allowable will be assigned to the well until all interests have been consolidated (by communitization, unitization, forced-pooling, or otherwise) or until a non-standard unit, eliminating such interests, has been approved by the Commission.

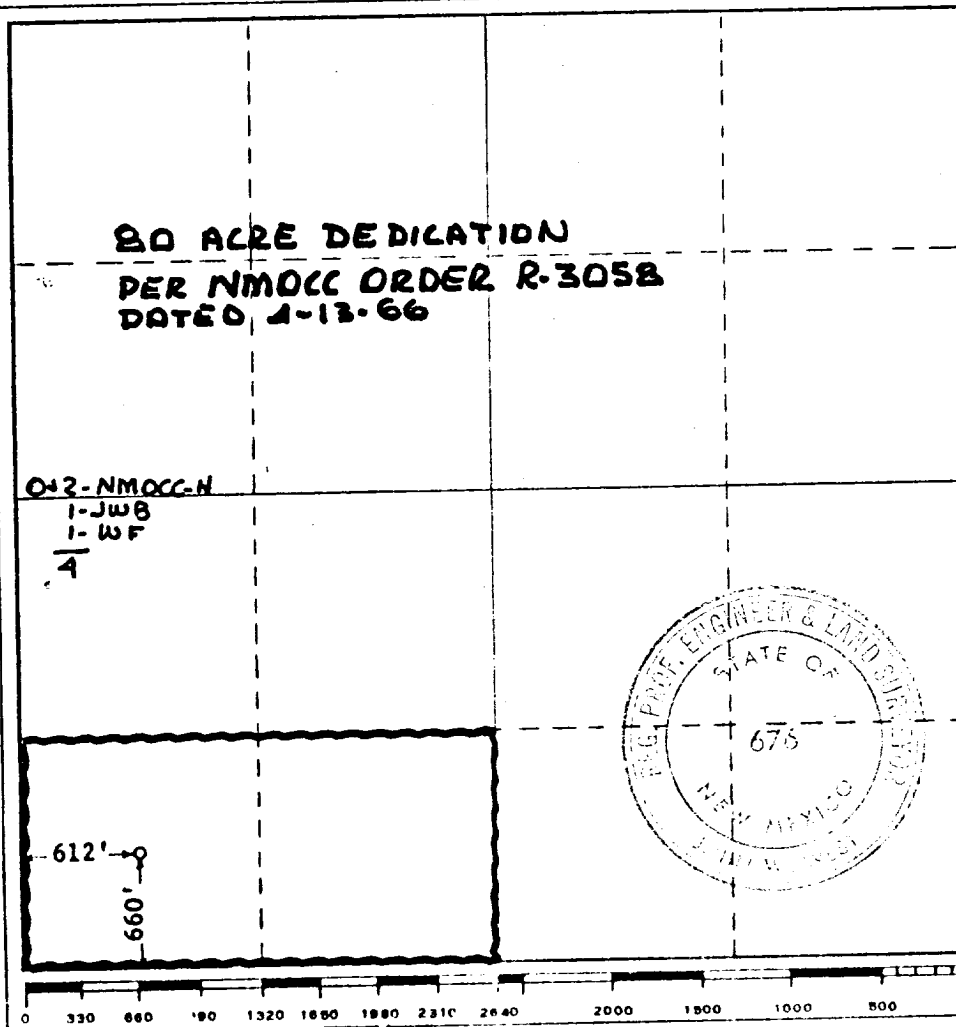

CERTIFICATION

I hereby certify that the information contained herein is true and complete to the best of my knowledge and belief.

Name _____

Position _____

AREA SUPERINTENDENT

Company _____

PAN AMERICAN PETRO. CORP.

Date _____

4-26-66

I hereby certify that the well location shown on this plat was plotted from field notes of actual surveys made by me or under my supervision, and that the same is true and correct to the best of my knowledge and belief.

Date Surveyed _____

AUGUST 25, 1965

Registered Professional Engineer and/or Land Surveyor

John W. Whit

N.M.P.E. & L.S. No. 676