

NEW MEXICO OIL CONSERVATION COMMISSION  
Santa Fe, New Mexico

Form C-101  
Revised (12/1/55)

## NOTICE OF INTENTION TO DRILL

Notice must be given to the District Office of the Oil Conservation Commission and approval obtained before drilling or recompletion begins. If changes in the proposed plan are considered advisable, a copy of this notice showing such changes will be returned to the sender. Submit this notice in **QUINTUPPLICATE**. One copy will be returned following approval. See additional instructions in Rules and Regulations of the Commission. If State Land submit 6 Copies Attach Form C-128 in triplicate to first 3 copies of form C-101

**Albuquerque, New Mexico**

**April 5, 1963**

(Place)

(Date)

OIL CONSERVATION COMMISSION  
SANTA FE, NEW MEXICO

Gentlemen:

You are hereby notified that it is our intention to commence the Drilling of a well to be known as  
**Pubco Petroleum Corporation - South King Exploration Company**

(Company or Operator)

State

**1**

**P**

(Lease)

, Well No. \_\_\_\_\_, in \_\_\_\_\_, The well is

(Unit)

located **660** feet from the **South** line and **330** feet from the

**East**

Line of Section **2**, T. **14S**, R. **37E**, NMPM.

(GIVE LOCATION FROM SECTION LINE)

**Wildcat**

Pool,

**Lee**

County

**R37E**

If State Land the Oil and Gas Lease is No. **K-3359**

If patented land the owner is \_\_\_\_\_

Address \_\_\_\_\_

We propose to drill well with drilling equipment as follows: **Rotary tools**  
**from surface to T.D.**

The status of plugging bond is **Statewide**

Drilling Contractor **Tri-Service Drilling Company**  
**Midland, Texas**

We intend to complete this well in the **Devonian**  
**12,800** feet.

### CASING PROGRAM

We propose to use the following strings of Casing and to cement them as indicated:

Size of Hole	Size of Casing	Weight per Foot	New or Second Hand	Depth	Sacks Cement
<b>17 1/2</b>	<b>13 3/8</b>	<b>48</b>	<b>NEW</b>	<b>300</b>	<b>Circ.</b>
<b>12 1/2</b>	<b>9 5/8</b>	<b>37.3, 36 &amp; 40</b>	<b>NEW</b>	<b>4700</b>	<b>500</b>
<b>8 3/4</b>	<b>4 1/2</b>	<b>11.6 &amp; 13.5</b>	<b>NEW</b>	<b>12,800</b>	<b>600</b>

If changes in the above plans become advisable we will notify you immediately.

ADDITIONAL INFORMATION (If recompletion give full details of proposed plan of work.)

Approved \_\_\_\_\_, 19\_\_\_\_\_  
Except as follows:

OIL CONSERVATION COMMISSION

By \_\_\_\_\_

Sincerely yours,

**Pubco Petroleum Corporation**

(Company or Operator)

By **J.L. Albright, Geologist**

Position \_\_\_\_\_

Send Communications regarding well to

Name **Pubco Petroleum Corporation**

Address **P.O. Box 1419, Albuquerque, New Mexico**

**NEW MEXICO OIL CONSERVATION COMMISSION**  
**WELL LOCATION AND ACREAGE DEDICATION PLAT**

FORM C-120  
Revised 5/1/57

SEE INSTRUCTIONS FOR COMPLETING THIS FORM ON THE REVERSE SIDE

**SECTION A**

Operator <b>PUBCO PETROLEUM CORP. - SOUTH KING EXPL. CO.</b>				Lease STATE		Well No. <b>1</b>
Unit Letter <b>P</b>	Section <b>2</b>	Township <b>14 SOUTH</b>	Range <b>37 EAST</b>	County <b>LEA</b>		
Actual Footage Location of Well: <b>660</b> feet from the <b>SOUTH</b> line and <b>330</b> feet from the <b>EAST</b> line						
Ground Level Elev. <b>3836.4</b>	Producing Formation		Pool <b>Wildcat</b>		Dedicated Acreage: <b>40</b> Acres	

1. Is the Operator the only owner in the dedicated acreage outlined on the plat below? YES ☒ NO \_\_\_\_ ("Owner" means the person who has the right to drill into and to produce from any pool and to appropriate the production either for himself or for himself and another. (65-3-29 (e) NMSA 1955 Comp.)
2. If the answer to question one is "no," have the interests of all the owners been consolidated by communication agreement or otherwise? YES \_\_\_\_ NO \_\_\_\_ If answer is "yes," Type of Consolidation \_\_\_\_
3. If the answer to question two is "no," list all the owners and their respective interests below:

Owner	Land Description

**SECTION B**

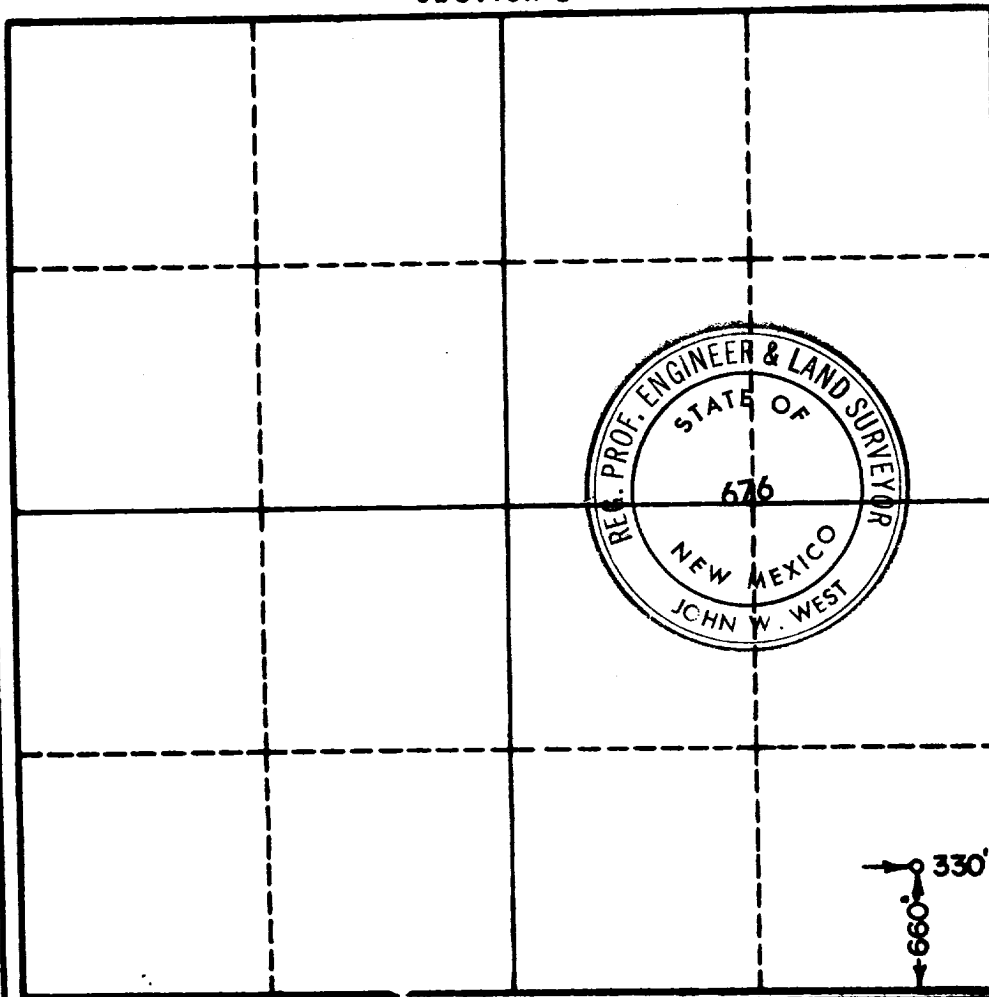

**CERTIFICATION**

I hereby certify that the information in SECTION A above is true and complete to the best of my knowledge and belief.

Name J. L. Albright  
Position Geologist  
Company Pubco Petroleum Corporation  
Date April 3, 1965

I hereby certify that the well location shown on the plat in SECTION B was plotted from field notes of actual surveys made by me or under my supervision, and that the same is true and correct to the best of my knowledge and belief.

Date Surveyed 3-30-65  
Registered Professional Engineer and/or Land Surveyor, JOHN W. WEST  
John W. West  
Certificate No. N. M. - P. E. & L. S. NO. 676

0 330 660 990 1320 1650 1980 2310 2640 2970 3300