

| Re-Cmp 12-30-68 | | CLASS | | EL | |
|-----------------------------|--|-----------|-------|-----------|-------|
| | | FORMATION | DATUM | FORMATION | DATUM |
| CSG & SX - TUBING | | | | | |
| 13 3/8" at 337' w/400 sx | | | | | |
| 9 5/8" at 4152' w/400 sx | | | | | |
| 5 1/2" at 10,365' w/1770 SX | | | | | |
| | | | | | |
| | | | | | |
| | | | | | |
| | | | | | |
| LOGS EL GR RA IND HC A | | | | | |

Distribution limited and publication prohibited by subscribers' agreement.
Reproduction rights reserved by Williams & Lee Scouting Service, Inc.

| | | | | | |
|-------|------|-------|-------|------|----|
| CONT. | PROP | DEPTH | 9946' | TYPE | WO |
| DATE | | | | | |

F.R.C. 2-13-69
FD 9946' WO (Penn)
(Orig. Shell Oil Co. #1 HTB State, Comp
1-19-66 thru perfs 9833-9841', OTD 10,365',
CEB 9967')
2-10-69 TD 10,365'; PED 9967'; COMPLETE
Perf 9783-85', 9859-64', 9909-12', 9933-46'
Acid (9783-9946') 2000 gals
2-13-69 Ppd 4 FO + 10 BW in 24 hrs (9783-9946')
COMPLETION REPORTED

| | | | | | |
|-----------------------------|-------------------|----------------------|-----------------|-----------|-------|
| COUNTY | LEA | FIELD | Hightower, East | STATE | NM |
| OPR | SHELL OIL COMPANY | | | | |
| 1 | State "HTB" | | | | MAP |
| Sec. 31, T-12-S, R-34-E | | | | | |
| 700' FNL & 580' FWL of Sec. | | | | | |
| Spd 11-18-65 | | | | | |
| Cmp 1-19-66 | | | | | |
| CSG & SX - TUBING | | CLASS | | EL | |
| | | FORMATION | DATUM | FORMATION | DATUM |
| 13 3/8" 337' 400 | | | | | |
| 9 5/8" 4152' 400 | | | | | |
| 5 1/2" 10364' | | | | | |
| LOGS EL GR RA IND HC A | | | | | |
| | | TD 10365', PBD 9985' | | | |

IP Bough "A" Perfs 9833-41' Flwd 148 BOPD + 7 BW. Pot. Based on 24 hr test thru 20/64" chk., TP 100#, CP Pkr, Gravity 48.5, GOR 574.

Distribution limited and publication prohibited by subscribers' agreement.
Reproduction rights reserved by Williams & Lee Scouting Service, Inc.

CONT. Cactus Drlg. Corp.

DATE

PROP DEPTH 10,400' TYPE

F.R. 11-11-65
PD 10,400' - Penn.
Contr. - Cactus
11-22-65 Drlg. 2355'.
Set 13 3/8" @ 337' W/400 sx.
11-29-65 Drlg. 4650'.
Set 9 5/8" @ 4152' W/400 sx.
12-6-65 Drlg. 7130'.
12-13-65 Drlg. 8882'.
12-20-65 TD 9870', on DST 9780-9870'.
1-3-66 TD 10365', prep to re-cmt casing.
DST (Bough "A") 9780-9870', open 2 hrs
19 mins,
GTS 7 mins @ 432 MCEGPD,
MTS 1 hr 2 mins, CTS 1 hr 27 mins,
Cleaned to pits 9 mins @ approx. 3 BO,
Flwd to tanks 40 mins & Flwd 20 BO thru
1/2" chk., SFP 120#.

CONTINUED

LEA Hightower, East
SHELL OIL CO., #1 State "HTB"

NM

Sec. 31-12S-34E

Page #2

66

Cont.

Rev out 27 BO,
Rec 113' GCM below sub,
1 hr 30 min ISIP 3046#, FP 755-1344#,
1 hr 12 min FSIP 2227# (Building)
SP DST (Bough "G" & "H") 10127-243',
open 1 hr 56 mins,
GTS 17 mins @ 260 MCFGPD, decreasing to
TSTM @ end of test
Rev out est. 30 BO (4% RS&W),
Rec 85' G&MCO below sub (47% oil),
1 hr 30 min ISIP 3508#,
FP 283-994#, 2 hr FSIP 2716#.
Set 5½" @ 10364'.

1-10-66

TD 10365', PBD 10284', swbg.
Perf @ 9022' W/2 shots
Perf @ 10315' W/4 shots
Squeezed perfs 9022 & 10315' W/300 sx.
Perf 10132-134' W/2 SPF
Perf 10171-174' W/1 SPF
Perf @ 10235', 10237', 10238', 10239',
10240', 10242' W/1 SPI
Ac (10235-242') 1000 gals
Swbd 69 BLW + 83 BEW, w/tr oil in 18 hrs
(10235-242')
Ac (10171-174') 1000 gals.
Swbd 68 ELW, w/tr. oil in 6 hrs (10171-174')

- 1-17-66 TD 10365', PBD 10284', tstg.
Set BP @ 10251'
Ac (10132-134') 1000 gals.
Flwd 30 BNO +2% ES&W in 4 hrs thru
24/64" chk., TP 150# (10132-134')
- 1-24-66 TD 10365', PBD 10284', SI for BHP.
Flwd 114 BO in 24 hrs thru 24/64" chk.,
TP 150#, gravity 39.5, GOR 711 (10132-
134')
Ac (10132-134') 1000 gals.
Perf (Bough "A") 9833-41' W/2 SPF
Ac (9833-41') 1500 gals(15%)
Flwd 86 BO + 7 EW/20 hrs thru 20/64"
chk., TP 100-140# (9833-41')
- 1-31-66 TD 10365', PBD 9985', tstg.
Swbd 28½ BO + 28 EW/24 hrs (10132-134')
Set CIEP @ 9985'
- 2-7-66 TD 10365', PBD 9985', WO Pot.
- 2-14-66 TD 10365', PBD 9985', COMPLETED.
LOG TOPS: Yates 2729', Queen 3478',
San Andres 4074', Abc 7629', Wolfcamp
9068', Bough "A" 9797', Bough "G"
10067', Bough "H" 10153'.

**NEW MEXICO OIL CONSERVATION COMMISSION
WELL LOCATION AND ACREAGE DEDICATION PLAT**

Form C-102
Supersedes C-128
Effective 1-1-65

All distances must be from the outer boundaries of the Section **N. C. C.**

| | | | | | |
|--|--|-----------------------|--|----------------------|--|
| Operator Shell Oil Company (Western Division) | | | Lease HTB State | | Well No. 1 |
| Unit Letter D | Section 31 | Township 12 | Range 34 | County Lea | |
| Actual Footage Location of Well: 700 feet from the north line and 580 feet from the west line | | | | | |
| Ground Level Elev. 4215' | Producing Formation Upper Penn | | Pool E. Hightower-Upper Penn | | Dedicated Acreage: 80 7/23 Acres |

1. Outline the acreage dedicated to the subject well by colored pencil or hachure marks on the plat below.
2. If more than one lease is dedicated to the well, outline each and identify the ownership thereof (both as to working interest and royalty).
3. If more than one lease of different ownership is dedicated to the well, have the interests of all owners been consolidated by communitization, unitization, force-pooling, etc?

☐ Yes ☐ No If answer is "yes," type of consolidation _____

If answer is "no," list the owners and tract descriptions which have actually been consolidated. (Use reverse side of this form if necessary.) _____

No allowable will be assigned to the well until all interests have been consolidated (by communitization, unitization, forced-pooling, or otherwise) or until a non-standard unit, eliminating such interests, has been approved by the Commission.

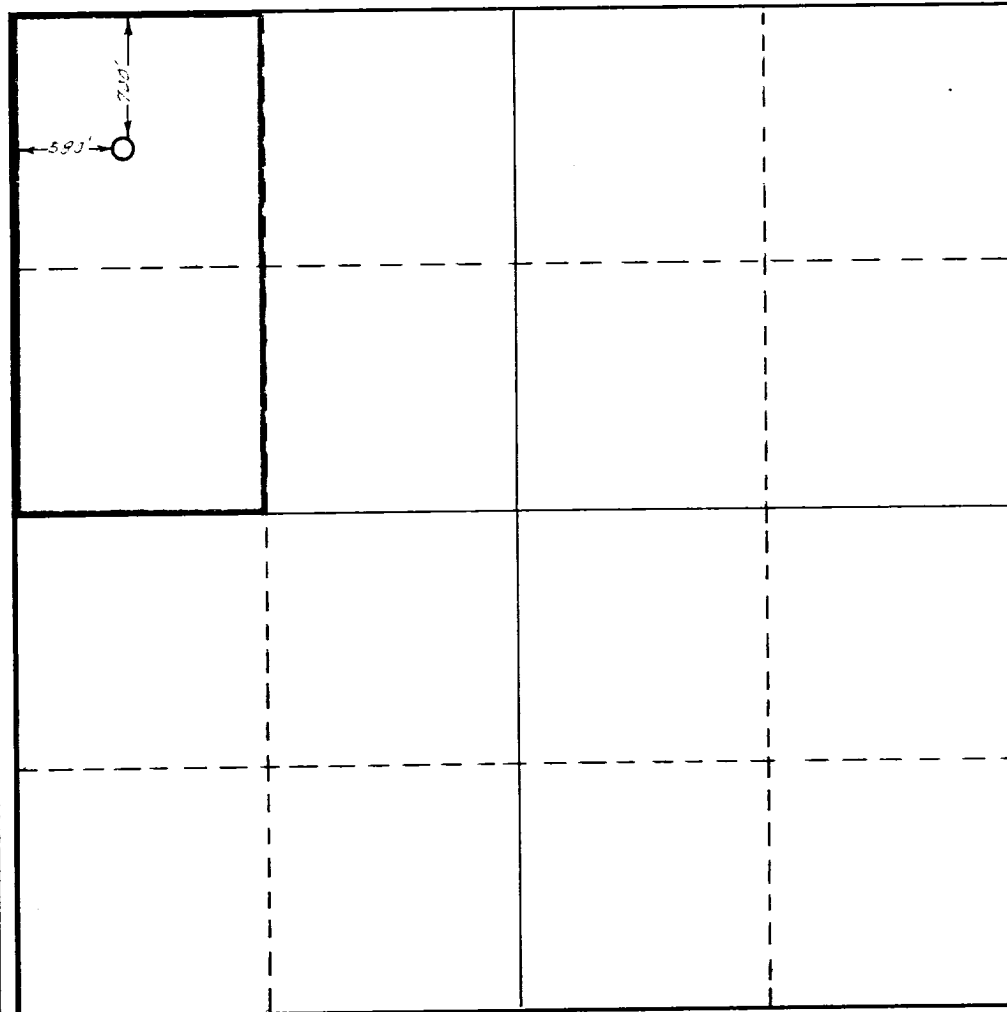

CERTIFICATION

I hereby certify that the information contained herein is true and complete to the best of my knowledge and belief.

Name
Original Signed By J. D. Duren
Position
J. D. DUREN J. D. Duren
Staff Exploitation Engr.
Company
Shell Oil Company
Date
January 28, 1966

I hereby certify that the well location shown on this plat was plotted from field notes of actual surveys made by me or under my supervision, and that the same is true and correct to the best of my knowledge and belief.

Date Surveyed
Registered Professional Engineer and/or Land Surveyor

Certificate No.

