

NO. OF COPIES RECEIVED	
DISTRIBUTION	
SANTA FE	
FILE	
U.S.G.S.	
LAND OFFICE	
OPERATOR	

NEW MEXICO OIL CONSERVATION COMMISSION

Form C-101
Revised 1-1-65

5A. Indicate Type of Lease
STATE ☐ FEE ☒

5. State Oil & Gas Lease No.

APPLICATION FOR PERMIT TO DRILL, DEEPEN, OR PLUG BACK

1a. Type of Work DRILL <input checked="" type="checkbox"/> DEEPEN <input type="checkbox"/> PLUG BACK <input type="checkbox"/>		7. Unit Agreement Name
b. Type of Well OIL WELL <input checked="" type="checkbox"/> GAS WELL <input type="checkbox"/> OTHER <input type="checkbox"/> SINGLE ZONE <input checked="" type="checkbox"/> MULTIPLE ZONE <input type="checkbox"/>		8. Farm or Lease Name Agnes Malone
2. Name of Operator The Superior Oil Company		9. Well No. 1
3. Address of Operator P. O. Box 1900, Midland, Texas 79701		10. Field and Pool, or Wildcat UNDESIGNATED
4. Location of Well UNIT LETTER J LOCATED 2310 FEET FROM THE South LINE AND 1650 FEET FROM THE East LINE OF SEC. 11 TWP. 14-S RGE. 37-E NMPM		12. County Lea
19. Proposed Depth 13,200		19A. Formation Devonian
20. Rotary or C.T. Rotary		
21. Elevations (Show whether DF, RT, etc.) Est. 3840 KB	21A. Kind & Status Plug. Bond Blanket - OK	21B. Drilling Contractor Unknown at present
22. Approx. Date Work will start March 25, 1968		

23.

PROPOSED CASING AND CEMENT PROGRAM

SIZE OF HOLE	SIZE OF CASING	WEIGHT PER FOOT	SETTING DEPTH	SACKS OF CEMENT	EST. TOP
17-1/2"	13-3/8"	48#	325	475	Surface
12-1/4"	9-5/8"	36#, 40#	4700	1150 cu. ft.	1500
8-5/8"	5-1/2"	20#	13,200	400	9000

The proposed total depth of this well is 13,200'. We plan to drill and run casing according to the above outlined program. However, since this is a wildcat well, size of the productive casing string could be altered somewhat depending upon the results of tests and indicated shows. A completion will be made in the Devonian, if tests and shows warrant.

13 3/8

6-7-68

IN ABOVE SPACE DESCRIBE PROPOSED PROGRAM: IF PROPOSAL IS TO DEEPEN OR PLUG BACK, GIVE DATA ON PRESENT PRODUCTIVE ZONE AND PROPOSED NEW PRODUCTIVE ZONE. GIVE BLOWOUT PREVENTER PROGRAM, IF ANY.

I hereby certify that the information above is true and complete to the best of my knowledge and belief.

Signed *D. H. Collins Jr.* Title District Engineer Date March 4, 1968

(This space for State Use)

APPROVED BY *Joe Ramsey* TITLE _____ DATE _____

CONDITIONS OF APPROVAL, IF ANY:

**NEW MEXICO OIL CONSERVATION COMMISSION
WELL LOCATION AND ACREAGE DEDICATION PLAT**

Form C-102
Supersedes C-128
Effective 1-1-65

All distances must be from the outer boundaries of the Section.

Operator The Superior Oil Company			Lease Agnes Malone		Well No. 1
Unit Letter J	Section 11	Township T-14-S	Range R-37-E	County Lea	
Actual Footage Location of Well: <div style="display: flex; justify-content: space-between;"> 2310 feet from the South line and 1650 feet from the East line </div>					
Ground Level Elev. Est. 3815	Producing Formation Devonian	Pool Wildcat UNITS CONSOLIDATED		Dedicated Acreage: 40 Acres	

1. Outline the acreage dedicated to the subject well by colored pencil or hachure marks on the plat below.
2. If more than one lease is dedicated to the well, outline each and identify the ownership thereof (both as to working interest and royalty).
3. If more than one lease of different ownership is dedicated to the well, have the interests of all owners been consolidated by communitization, unitization, force-pooling, etc?

☐ Yes ☐ No If answer is "yes," type of consolidation _____

If answer is "no," list the owners and tract descriptions which have actually been consolidated. (Use reverse side of this form if necessary.) _____

No allowable will be assigned to the well until all interests have been consolidated (by communitization, unitization, forced-pooling, or otherwise) or until a non-standard unit, eliminating such interests, has been approved by the Commission.

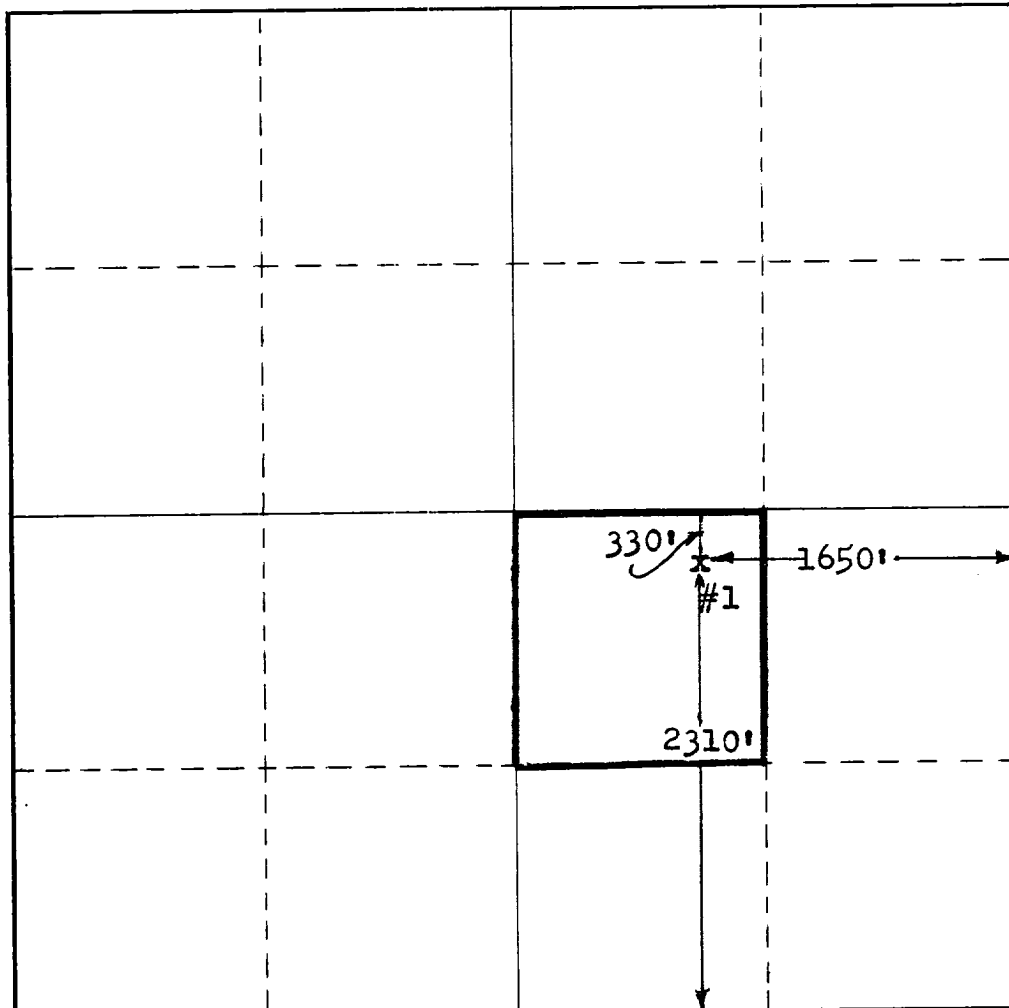

CERTIFICATION

I hereby certify that the information contained herein is true and complete to the best of my knowledge and belief.

D. H. Collins, Jr.

Name

D. H. Collins, Jr.

Position

District Engineer

Company

The Superior Oil Company

Date

March 4, 1968

I hereby certify that the well location shown on this plat was plotted from field notes of actual surveys made by me or under my supervision, and that the same is true and correct to the best of my knowledge and belief.

Date Surveyed

March 1, 1968

Registered Professional Engineer
and/or Land Surveyor

Earl K. Montooth

Certificate No.

L.S.#1317



ELF