

**NEW XICO OIL CONSERVATION COMMISSION
WELL LOCATION AND ACREAGE DEDICATION PLAT**

Form C-102
Supersedes C-128
Effective 1-1-65

All distances must be from the outer boundaries of the Section.

Operator The Superior Oil Company			Lease State "K"		Well No. 1
Unit Letter J	Section 4	Township 14-S	Range 34-E	County Lea	
Actual Footage Location of Well: 2130 feet from the South line and 1980 feet from the East line					
Ground Level Elev. 4138	Producing Formation Lower Wolfcamp		Pool Undesignated		Dedicated Acreage: 40 Acres

1. Outline the acreage dedicated to the subject well by colored pencil or hachure marks on the plat below.
2. If more than one lease is dedicated to the well, outline each and identify the ownership thereof (both as to working interest and royalty).
3. If more than one lease of different ownership is dedicated to the well, have the interests of all owners been consolidated by communitization, unitization, force-pooling, etc?

☐ Yes ☐ No If answer is "yes," type of consolidation _____

If answer is "no," list the owners and tract descriptions which have actually been consolidated. (Use reverse side of this form if necessary.) _____

No allowable will be assigned to the well until all interests have been consolidated (by communitization, unitization, forced-pooling, or otherwise) or until a non-standard unit, eliminating such interests, has been approved by the Commission. **No pooling of interests necessary since common State Lease No. K-864**

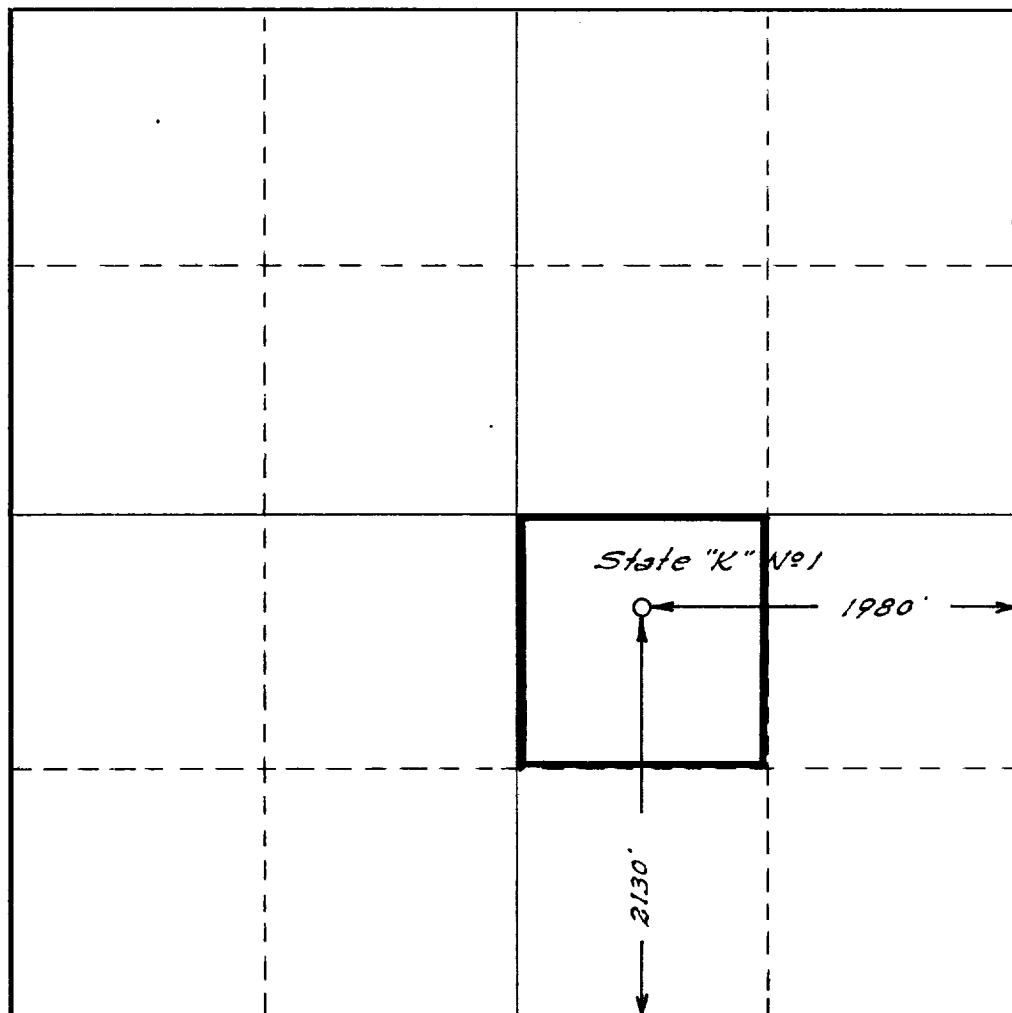

CERTIFICATION

I hereby certify that the information contained herein is true and complete to the best of my knowledge and belief.

T. D. Clay
Name
T. D. Clay

Position
Production Engineer

Company
The Superior Oil Company

Date
December 12, 1968

I hereby certify that the well location shown on this plat was plotted from field notes of actual surveys made by me or under my supervision, and that the same is true and correct to the best of my knowledge and belief.

Date Surveyed
August 17, 1968

Registered Professional Engineer
and/or Land Surveyor

Earl K. Monteith

Certificate No. **1317 LS**

