

NO. OF COPIES RECEIVED	
DISTRIBUTION	
SANTA FE	
FILE	
U.S.G.S.	
LAND OFFICE	
OPERATOR	

NEW MEXICO OIL CONSERVATION COMMISSION

Form C-101
Revised 1-1-65

5A. Indicate Type of Lease STATE <input checked="" type="checkbox"/> FEE <input type="checkbox"/>
5. State Oil & Gas Lease No. K-4670

APPLICATION FOR PERMIT TO DRILL, DEEPEN, OR PLUG BACK

1a. Type of Work b. Type of Well OIL WELL <input checked="" type="checkbox"/> GAS WELL <input type="checkbox"/> OTHER <input type="checkbox"/> SINGLE ZONE <input checked="" type="checkbox"/> MULTIPLE ZONE <input type="checkbox"/>		7. Unit Agreement Name	
2. Name of Operator PAN AMERICAN PETROLEUM CORPORATION		8. Farm or Lease Name STATE "DN"	
3. Address of Operator BOX 68, HOBBS, N. M. 88240		9. Well No. 1	
4. Location of Well UNIT LETTER Q LOCATED 660' FEET FROM THE NORTH LINE AND 1980' FEET FROM THE WEST LINE OF SEC. 19 TWP. 13-S RGE. 33-E NMPM		10. Field and Pool, or Wildcat LAZY "J" PENN - EXT	
12. County LEA		19. Proposed Depth 10,000'	
21. Elevations (Show whether DF, RT, etc.)		19A. Formation PENN	
21A. Kind & Status Plug. Bond BLANKET-ON FILE		20. Rotary or C.T. ROTARY	
21B. Drilling Contractor OACTUS DR LG		22. Approx. Date Work will start 12-17-68	

23.

PROPOSED CASING AND CEMENT PROGRAM

SIZE OF HOLE	SIZE OF CASING	WEIGHT PER FOOT	SETTING DEPTH	SACKS OF CEMENT	EST. TOP
17 1/2"	13 3/8"	48#	375'	<i>Circulate</i>	
12 1/4 - 11"	8 5/8"	24-32#	4,100'	350 5x	
7 7/8"	5 1/2"	14-17#	10,000'	FILL 600' above pay.	

13 3/8

APPROVAL VALID
FOR 90 DAYS UNLESS
DRILLING COMMENCED,

3-19-68

IN ABOVE SPACE DESCRIBE PROPOSED PROGRAM: IF PROPOSAL IS TO DEEPEN OR PLUG BACK, GIVE DATA ON PRESENT PRODUCTIVE ZONE AND PROPOSED NEW PRODUCTIVE ZONE. GIVE BLOWOUT PREVENTER PROGRAM, IF ANY.

I hereby certify that the information above is true and complete to the best of my knowledge and belief.

Signed _____ Title **AREA SUPERINTENDENT** Date **DEC 16 1968**

(This space for State Use)

APPROVED BY _____ TITLE **SUPERVISOR DISTRICT 1** DATE _____

CONDITIONS OF APPROVAL, IF ANY:

0-5- NM1000-11
1- NSW
1- SUSP
1- RRV

NEW MEXICO OIL CONSERVATION COMMISSION
WELL LOCATION AND ACREAGE DEDICATION PLAT

Form C-102
Supersedes C-128
Effective 1-1-65

All distances must be from the outer boundaries of the Section.

PAN AMERICAN PETROLEUM CORP.			Lease		STATE "DN"	Well No. 1
Section	Township	Range	County			
C	19	13 SOUTH	33 EAST LEA			
Actual Well Location of Well:						
660		feet from the	NORTH	line and	1980	feet from the WEST line
Ground Level Elev.	Producing Formation		Pool	Dedicated Acreage		
	PSMN		LAZY "J" PENN EXT	158.97		Acres

- Outline the acreage dedicated to the subject well by colored pencil or hatchure marks on the plat below.
- If more than one lease is dedicated to the well, outline each and identify the ownership thereof (both as to working interest and royalty).
- If more than one lease of different ownership is dedicated to the well, have the interests of all owners been consolidated by communitization, unitization, force-pooling, etc?

☐ Yes ☐ No If answer is "yes," type of consolidation _____

If answer is "no," list the owners and tract descriptions which have actually been consolidated. (Use reverse side of this form if necessary.) _____

No allowable will be assigned to the well until all interests have been consolidated (by communitization, unitization, forced-pooling, or otherwise) or until a non-standard unit, eliminating such interests, has been approved by the Commission.

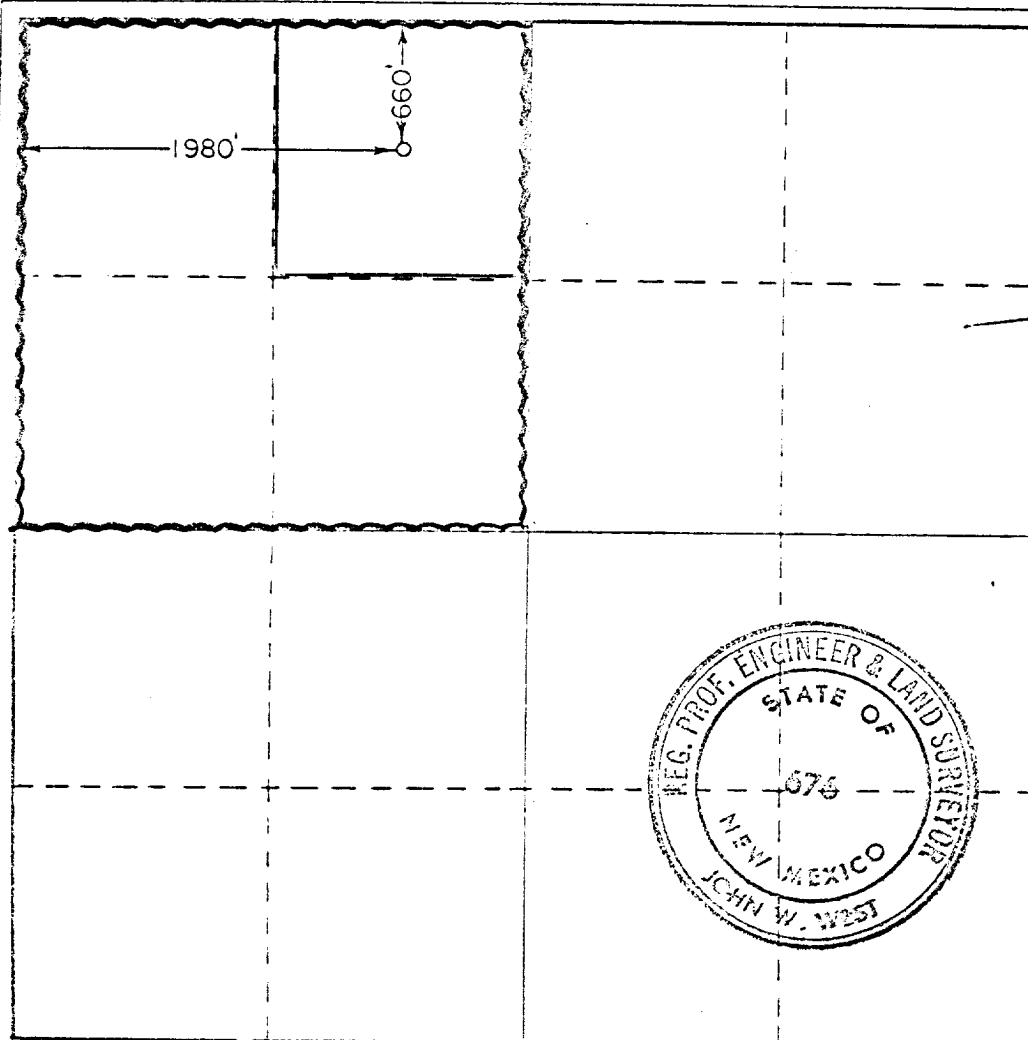

CERTIFICATION

I hereby certify that the information contained herein is true and complete to the best of my knowledge and belief.

Name _____

Position _____

AREA SUPERINTENDENT

Company _____

PAN AMERICAN PETROLEUM CORPORATION

Date _____

DEC 16 1968

I hereby certify that the well location shown on this plat was plotted from field notes of actual surveys made by me or under my supervision, and that the same is true and correct to the best of my knowledge and belief.

Date Surveyed _____

DECEMBER 14, 1968

Registered Professional Engineer and/or Land Surveyor

John W. West

Certificate No. _____

676

0 330 660 990 1320 1650 1980 2310 2640 2000 1500 1000 500 0