

NO. OF COPIES RECEIVED	
DISTRIBUTION	
SANTA FE	
FILE	
U.S.G.S.	
LAND OFFICE	
OPERATOR	

# NEW MEXICO OIL CONSERVATION COMMISSION

Orig & 5cc: NMCCC  
 lcc: G. H. Truran  
 lcc: J. E. Pierce  
 lcc: File

Form C-101  
 Revised 1-1-65

5A. Indicate Type of Lease	
STATE <input checked="" type="checkbox"/>	FEE <input type="checkbox"/>
5. State Oil & Gas Lease No.	

## APPLICATION FOR PERMIT TO DRILL, DEEPEN, OR PLUG BACK

1a. Type of Work		7. Unit Agreement Name	
b. Type of Well DRILL <input checked="" type="checkbox"/> DEEPEN <input type="checkbox"/> PLUG BACK <input type="checkbox"/> OIL WELL <input checked="" type="checkbox"/> GAS WELL <input type="checkbox"/> OTHER <input type="checkbox"/> SINGLE ZONE <input checked="" type="checkbox"/> MULTIPLE ZONE <input type="checkbox"/>		8. Farm or Lease Name State "NM"	
2. Name of Operator GREY OIL COMPANY		9. Well No. 1	
3. Address of Operator P. O. BOX 249, KINGS, NEW MEXICO		10. Field and Pool, or Wildcat UNDESIGNATED	
4. Location of Well UNIT LETTER <b>B</b> LOCATED <b>660</b> FEET FROM THE <b>North</b> LINE AND <b>1980</b> FEET FROM THE <b>East</b> LINE OF SEC. <b>12</b> TWP. <b>14S</b> RGE. <b>32E</b> NMPM		12. County Lea	
19. Proposed Depth 10,000		19A. Formation Pennsylvanian	
20. Rotary or C.T. Rotary		21. Elevations (Show whether DF, RT, etc.) 4277.4 GL	
21A. Kind & Status Plug. Bond Blanket Bond 11-30-37		21B. Drilling Contractor Contract Not Let	
22. Approx. Date Work will start When Permit Approved		23. v/st. Pool Indemnity PROPOSED CASING AND CEMENT PROGRAM	

SIZE OF HOLE	SIZE OF CASING	WEIGHT PER FOOT	SETTING DEPTH	SACKS OF CEMENT	EST. TOP
17-1/4"	13-3/8"	48	400	400	Surface
11"	8-5/8"	24 & 32	4100	765	Surface
7-7/8"	5-1/2"	17	10,000	300	9200' or 600' Above Bough "C"

It is proposed to drill a 17-1/4" hole using spud mud to 400', set 13-3/8" casing and circulate cement to surface. A 11" hole using brine will be drilled to 4100', where 8-5/8" casing will be set and cement circulated to the surface. A 7-7/8" hole using fresh water and mud will be drilled to 10,000'. Open hole logs to be run are a Bore hole compensated Sonic - Gamma Ray from surface to TB, a dual induction Laterolog from 4100' to TB and a Microlog over prospective zones. The 5-1/2" casing to be set at 10,000 and cemented with 300 sacks cement. (Top of cement to be 600' above Bough "C".) A Gamma Ray-Neutron completion log will be run. Perforations in the Pennsylvanian to be picked after evaluation of logs is completed. Perforation to be treated with a cleanup acid stimulation.

13 3/8

FOR 90 DAYS UNLESS  
 EXTENDED

6-27-69

IN ABOVE SPACE DESCRIBE PROPOSED PROGRAM: IF PROPOSAL IS TO DEEPEN OR PLUG BACK, GIVE DATA ON PRESENT PRODUCTIVE ZONE AND PROPOSED NEW PRODUCTIVE ZONE. GIVE BLOWOUT PREVENTER PROGRAM, IF ANY.

I hereby certify that the information above is true and complete to the best of my knowledge and belief.

ORIGINAL SIGNED BY  
 Signed HAROLD G. VEST Title Area Engineer Date 3-21-69

(This space for State Use)

APPROVED BY [Signature] TITLE [Signature] DATE [Signature]  
 CONDITIONS OF APPROVAL, IF ANY:

**NEW MEXICO OIL CONSERVATION COMMISSION  
WELL LOCATION AND ACREAGE DEDICATION PLAT**

Form C-102  
Supersedes C-128  
Effective 1-1-65

All distances must be from the outer boundaries of the Section.

Operator <b>GETTY OIL COMPANY</b>			Lease <b>STATE BH</b> <i>Perm</i>		Well No. <b>1</b>
Unit Letter <b>B</b>	Section <b>12</b>	Township <b>14 SOUTH</b>	Range <b>32 EAST</b>	County <b>LEA</b>	

Actual Footage Location of Well:  
**660** feet from the **NORTH** line and **1980** feet from the **EAST** line

Ground Level Elev. <b>4277.4</b>	Producing Formation <b>PENNSYLVANIAN</b>	Pool <b>BAIN UPPER PENNSYLVANIAN</b>	Dedicated Acreage: <b>160</b> Acres
-------------------------------------	---	---	--

1. Outline the acreage dedicated to the subject well by colored pencil or hachure marks on the plat below.
2. If more than one lease is dedicated to the well, outline each and identify the ownership thereof (both as to working interest and royalty).
3. If more than one lease of different ownership is dedicated to the well, have the interests of all owners been consolidated by communitization, unitization, force-pooling, etc?

☐ Yes ☐ No If answer is "yes," type of consolidation **Communitization**

If answer is "no," list the owners and tract descriptions which have actually been consolidated. (Use reverse side of this form if necessary.) \_\_\_\_\_

No allowable will be assigned to the well until all interests have been consolidated (by communitization, unitization, forced-pooling, or otherwise) or until a non-standard unit, eliminating such interests, has been approved by the Commission.

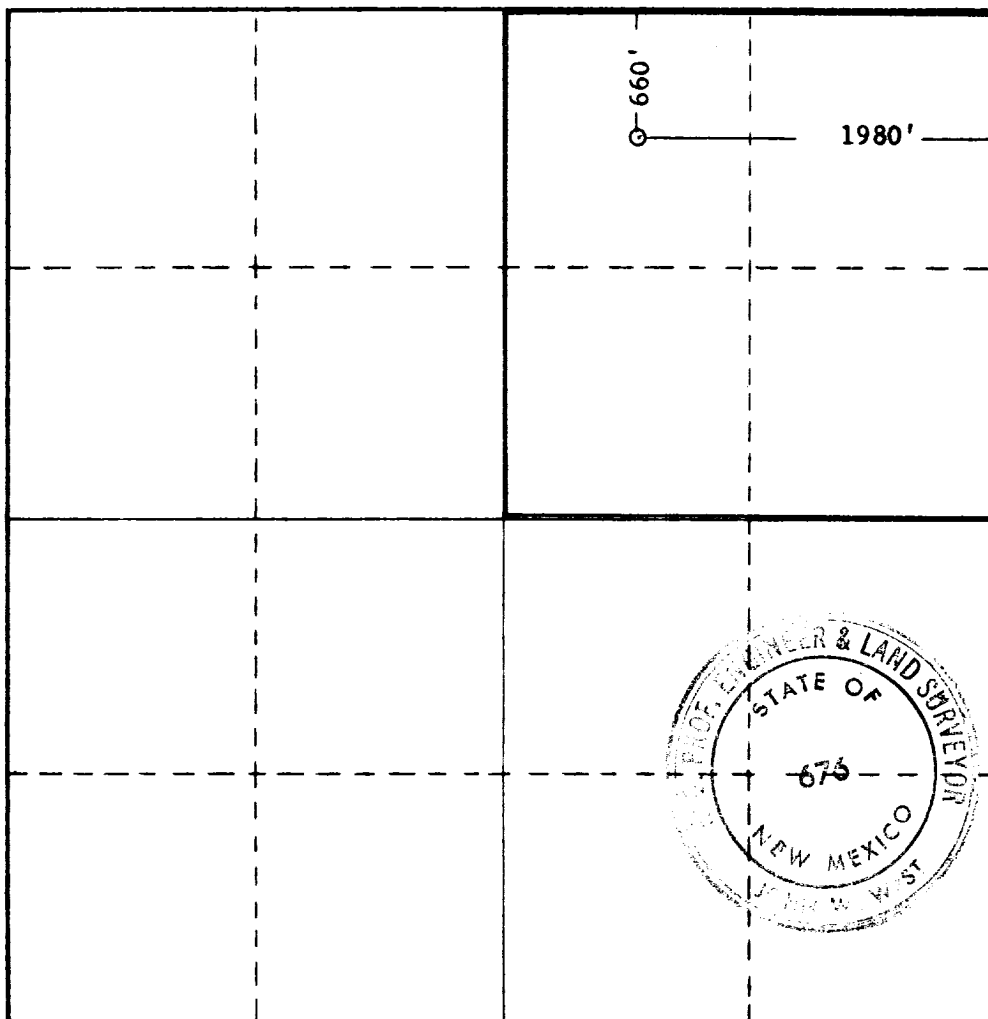

**CERTIFICATION**

*I hereby certify that the information contained herein is true and complete to the best of my knowledge and belief.*

**ORIGINAL SIGNED BY  
HAROLD G. VEST**

Name <b>H. G. Vest</b>
Position <b>Area Engineer</b>
Company <b>Getty Oil Company</b>
Date <b>March 21, 1969</b>

*I hereby certify that the well location shown on this plat was plotted from field notes of actual surveys made by me or under my supervision, and that the same is true and correct to the best of my knowledge and belief.*

Date Surveyed <b>3-18-1969</b>
Registered Professional Engineer and/or Land Surveyor

*John W. West*  
 Certificate No. **676**

