

COUNTY LEA FIELD Wildcat STATE NM 30-025-23226
 OPR R. K. PETROLEUM CORP. MAP

1 State
 Sec 27, T-13-S, R-32-E CO-ORD
 660' FNL, 1980' FEL of Sec.

Spd 7-26-69 CLASS EL
 Cmp 9-25-69

	FORMATION	DATUM	FORMATION	DATUM
CSG & SX - TUBING				
13 3/8" at 326' w/315 sx				
8 5/8" at 4030' w/315 sx				
5 1/2" at 11,110' w/700 sx				

LOGS EL GR RA IND HC A TD 12,510'; PBD 11,110'

IP (Morrow) Perfs 10,593-11,047' CAOF 7700 MCFGPD. GOR 2600;
 Grav (Cond) 51; Grav (gas) .750; SIWHP 1602#.

Distribution limited and publication prohibited by subscribers' agreement.
 Reproduction rights reserved by Williams & Lee Scouting Service, Inc.
 CONT. Moran Drlg. Co. PROP DEPTH 13,100' TYPE
 DATE

F.R. 7-22-69; Opr's Elev. 4317' GL
 PD 13,100' (Devonian)
 Contractor - Moran Drlg. Co.
 7-29-69 Drlg. 3100'
 8-4-69 Drlg. 5160' 1m
 8-11-69 Drlg. 8030'
 8-19-69 Drlg. 9998' 1m
 DST 9772', miss-run
 DST (Canyon) 9735-72', open 1 hr 30 min, rec 840'
 wtr, 1 hr ISIP 3214#, FP 47-166#, 2 hr FSIP 3191#,
 8-25-69 Drlg. 11,000' 1m & cht
 8-26-69 Drlg. 11,267'
 9-2-69 Drlg. 11,684'
 9-8-69 Drlg. 12,220' 1m
 9-18-69 TD 12,510'; PBD 11,110'; Rng Casing
 SP DST 10,705-761', open 2 hrs 14 min,

9-18-69

Continued

GTS 3 min, FTS 8 min, Flwd gas @ 21.4 MMCFGPD
thru 3/4" chk, 10 min SFP 1700#, rec 165' DF,
2 hr 16 min ISIP 4160#, FP 2913-3330#,
4 hr FSIP 3607#

SP DST 10,705-765', open 4 hrs 15 min,
GTS 3 min, FTS 8 min thru 1/2" chk, SFP 1550#,
Rev out 150' cond CM + 160' cond (grav 47),
30 min ISIP 3103#, FP 2373-2716#, 45 min
FSIP 2802#

9-22-69

TD 12,510'; PBD 11,110'; SI

9-29-69

TD 12,510'; PBD 11,110'; WO Potential
Perf 10,593-599', 10,729-735', 11,039-
047' w/13 shots

9-29-69

Continued

Acid (10,593-11,047') 3000 gals

Acid (10,593-11,047') 2000 gals

10-14-69

TD 12,510'; PBD 11,110'; WO Potential

10-27-69

TD 12,510'; PBD 11,110'; COMPLETE

FOUR POINT GAUGES:

Flwd 1298 MCFGPD thru 3/4" chk, 10 min,
TP 1363#

Flwd 1107 MCFGPD thru 3/4" chk, 10 min,
TP 1382#

Flwd 1038 MCFGPD thru 3/4" chk, 10 min,
TP 1388#

Flwd 620 MCFGPD thru 3/4" chk, 10 min,
TP 1451#

SAMPLE TOPS: Morrow 10,680', Chester 11,180'

LEA Wildcat NM Sec 27, T13S, R32E
R. K. PETROLEUM CORP. 1 State Page #3

10-27-69

Continued
LOG TOPS: Anhydrite 1500', Base Salt 2290',
Yates 2399', Seven Rivers 2530', Queen
3140', San Andres 3794', Glorieta 5250',
Tubb 6665', Abo 7430', Wolfcamp 8635',
Pennsylvanian 9090', Canyon 9725', Strawn
10,180', Atoka 10,450', Morrow 10,570',
Mississippian 11,280', Osage 11,600',
Woodford 12,315', Devonian 12,355',
Silurian 12,430'
Morrow Discovery
COMPLETION REPORTED

10-30-69

**NEW MEXICO OIL CONSERVATION COMMISSION
WELL LOCATION AND ACREAGE DEDICATION PLAT**

Form C-102
Supersedes C-128
Effective 1-1-65

All distances must be from the outer boundaries of the Section.

Operator RK Petroleum Corporation			Lease State		Well No. 1
Unit Letter B	Section 27	Township 13 South	Range 32 East	County Lea	
Actual Footage Location of Well: 1980 feet from the East line and 660 feet from the North line					
Ground Level Elev. 4317'	Producing Formation Morrow Sand		Pool Wildcat		Dedicated Acreage: 320 Acres

1. Outline the acreage dedicated to the subject well by colored pencil or hachure marks on the plat below.
2. If more than one lease is dedicated to the well, outline each and identify the ownership thereof (both as to working interest and royalty).
3. If more than one lease of different ownership is dedicated to the well, have the interests of all owners been consolidated by communitization, unitization, force-pooling, etc?

☐ Yes ☐ No If answer is "yes," type of consolidation _____

If answer is "no," list the owners and tract descriptions which have actually been consolidated. (Use reverse side of this form if necessary.) _____

No allowable will be assigned to the well until all interests have been consolidated (by communitization, unitization, forced-pooling, or otherwise) or until a non-standard unit, eliminating such interests, has been approved by the Commission.

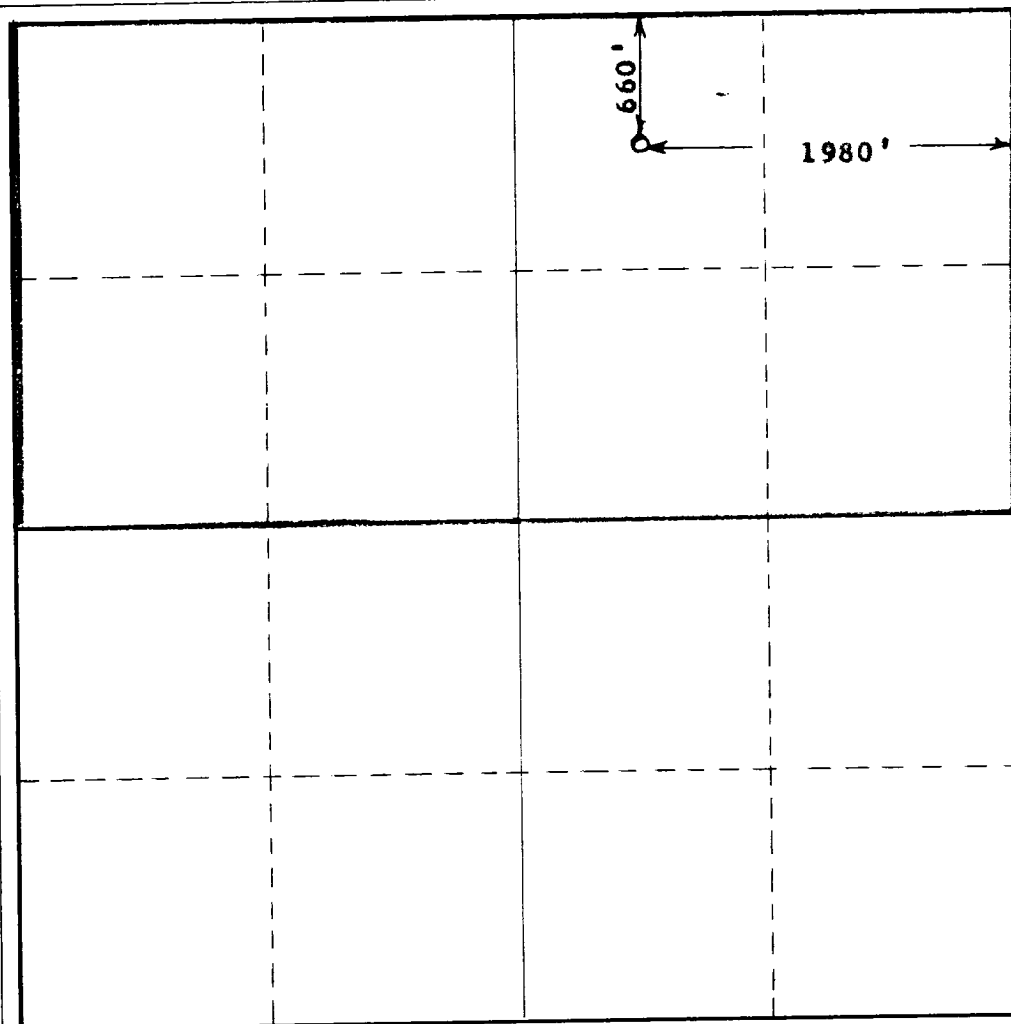

CERTIFICATION

I hereby certify that the information contained herein is true and complete to the best of my knowledge and belief.

Name

W. W. Griffith

Position

Engineer

Company

RK Petroleum Corp.

Date

10-21-69

I hereby certify that the well location shown on this plat was plotted from field notes of actual surveys made by me or under my supervision, and that the same is true and correct to the best of my knowledge and belief.

July 15, 1969

Date Surveyed

John W. West

Registered Professional Engineer
and/or Land Surveyor

Certificate No.

676

