

Submit to Appropriate  
District Office  
State Lease - 6 copies  
Fee Lease - 5 copies  
DISTRICT I  
P.O. Box 1980, Hobbs, NM 88240

DISTRICT II  
P.O. Drawer DD, Artesia, NM 88210

DISTRICT III  
1000 Rio Brazos Rd., Aztec, NM 87410

State of New Mexico  
Energy, Minerals and Natural Resources Department

OIL CONSERVATION DIVISION  
P.O. Box 2088  
Santa Fe, New Mexico 87504-2088

Form C-105  
Revised 1-1-89

WELL API NO. 30-025-23266
5. Indicate Type of Lease STATE <input checked="" type="checkbox"/> FEE <input type="checkbox"/>
6. State Oil & Gas Lease No. 0G5217

WELL COMPLETION OR RECOMPLETION REPORT AND LOG	
1a. Type of Well: OIL WELL <input checked="" type="checkbox"/> GAS WELL <input type="checkbox"/> DRY <input type="checkbox"/> OTHER <input type="checkbox"/>	
b. Type of Completion: NEW WELL <input type="checkbox"/> WORK OVER <input type="checkbox"/> DEEPEN <input type="checkbox"/> PLUG BACK <input checked="" type="checkbox"/> DEEP RESVR <input type="checkbox"/> OTHER <input type="checkbox"/>	
2. Name of Operator Sun Exploration & Production Company	
3. Address of Operator P. O. Box 1861, Midland, Texas 79702	
4. Well Location Unit Letter H : 660 Feet From The East Line and 2129 Feet From The North Line Section 33 Township 13-S Range 34-E NMPM Lea County	
10. Date Spudded 3-14-89	11. Date T.D. Reached
12. Date Compl. (Ready to Prod.) 3-16-89	13. Elevations (DF & RKB, RT, GR, etc.) 4140' GR
14. Elev. Casinghead	15. Total Depth 10,500
16. Plug Back T.D. 10,465	17. If Multiple Compl. How Many Zones?
18. Intervals Drilled By Rotary Tools	Cable Tools
19. Producing Interval(s), of this completion - Top, Bottom, Name 10,314'-10,358' Wolfcamp	
20. Was Directional Survey Made	
21. Type Electric and Other Logs Run	
22. Was Well Cored	

23. CASING RECORD (Report all strings set in well)					
CASING SIZE	WEIGHT LB/FT.	DEPTH SET	HOLE SIZE	CEMENTING RECORD	AMOUNT PULLED
13-3/8"	48#	455'	17-1/2"	250 sks	
8-5/8"	24 & 28	4500'	11"	300 sks	
5-1/2"	15.5 & 17	10500'	7-7/8"	200 sks	
24. LINER RECORD					
SIZE	TOP	BOTTOM	SACKS CEMENT	SCREEN	
25. TUBING RECORD					
SIZE	DEPTH SET	PACKER SET			
2-3/8" & 2-7/8"	10,434'				

26. Perforation record (interval, size, and number) 10,314-10,358, 1 JSPF, 27 holes		27. ACID, SHOT, FRACTURE, CEMENT, SQUEEZE, ETC. DEPTH INTERVAL 10,314'-10,358' tbgs communicated w/annulus, reversed acid to pit		AMOUNT AND KIND MATERIAL USED Acid w/3500 gals 15% NEFEHCL to pit	
--	--	---	--	---	--

28. PRODUCTION							
Date First Production 3-31-89		Production Method (Flowing, gas lift, pumping - Size and type pump) 2" x 1-1/4" x 24'				Well Status (Prod. or Shut-in) Prod.	
Date of Test 3-31-89	Hours Tested 24	Choke Size	Prod'n For Test Period	Oil - Bbl. 11	Gas - MCF 8	Water - Bbl. 20	Gas - Oil Ratio 727/1
Flow Tubing Press.	Casing Pressure	Calculated 24-Hour Rate	Oil - Bbl.	Gas - MCF	Water - Bbl.	Oil Gravity - API - (Corr.)	

29. Disposition of Gas (Sold, used for fuel, vented, etc.) Sold						Test Witnessed By	
30. List Attachments C-104, C-102							
31. I hereby certify that the information shown on both sides of this form is true and complete to the best of my knowledge and belief							

Signature <u>Maria L. Perez</u>	Printed Name <u>Maria L. Perez</u>	Title <u>Accountant</u>	Date <u>4-17-89</u>
---------------------------------	------------------------------------	-------------------------	---------------------

\* This is a combined test we performed - no production attributed to well zone per AHC 745

Submit to Appropriate  
District Office  
State Lease - 6 copies  
Fee Lease - 5 copies  
DISTRICT I  
P.O. Box 1980, Hobbs, NM 88240

DISTRICT II  
P.O. Drawer DD, Artesia, NM 88210

DISTRICT III  
1000 Rio Brazos Rd., Aztec, NM 87410

State of New Mexico  
Energy, Minerals and Natural Resources Department

OIL CONSERVATION DIVISION  
P.O. Box 2088  
Santa Fe, New Mexico 87504-2088

Form C-105  
Revised 1-1-89

WELL API NO. 30-025-23266
5. Indicate Type of Lease STATE <input checked="" type="checkbox"/> FEE <input type="checkbox"/>
6. State Oil & Gas Lease No. 0G5217
7. Lease Name or Unit Agreement Name New Mexico "R" State
8. Well No. 2
9. Pool name or Wildcat Cerca Lower Wolfcamp

WELL COMPLETION OR RECOMPLETION REPORT AND LOG

1a. Type of Well: OIL WELL <input checked="" type="checkbox"/> GAS WELL <input type="checkbox"/> DRY <input type="checkbox"/> OTHER <input type="checkbox"/>		7. Lease Name or Unit Agreement Name New Mexico "R" State	
b. Type of Completion: NEW WELL <input type="checkbox"/> WORK OVER <input type="checkbox"/> DEEPEN <input type="checkbox"/> PLUG BACK <input checked="" type="checkbox"/> DEEP RESVR <input type="checkbox"/> OTHER <input type="checkbox"/>			
2. Name of Operator Sun Exploration & Production Company		8. Well No. 2	
3. Address of Operator P. O. Box 1861, Midland, Texas 79702		9. Pool name or Wildcat Cerca Lower Wolfcamp	
4. Well Location Unit Letter <u>H</u> : <u>660</u> Feet From The <u>East</u> Line and <u>2129</u> Feet From The <u>North</u> Line Section <u>33</u> Township <u>13-S</u> Range <u>34-E</u> NMPM Lea County			
10. Date Spudded 3-14-89	11. Date T.D. Reached	12. Date Compl. (Ready to Prod.) 3-16-89	13. Elevations (DF & RKB, RT, GR, etc.) 4140' GR
14. Elev. Casinghead	15. Total Depth 10,500	16. Plug Back T.D. 10,465	17. If Multiple Compl. How Many Zones?
18. Intervals Drilled By Rotary Tools			Cable Tools
19. Producing Interval(s), of this completion - Top, Bottom, Name 10,314'-10,358' Wolfcamp			20. Was Directional Survey Made
21. Type Electric and Other Logs Run			22. Was Well Cored

CASING RECORD (Report all strings set in well)

CASING SIZE	WEIGHT LB/FT.	DEPTH SET	HOLE SIZE	CEMENTING RECORD	AMOUNT PULLED
13-3/8"	48#	455'	17-1/2"	250 sks	
8-5/8"	24 & 28	4500'	11"	300 sks	
5-1/2"	15.5 & 17	10500'	7-7/8"	200 sks	

24. LINER RECORD				25. TUBING RECORD		
SIZE	TOP	BOTTOM	SACKS CEMENT	SCREEN	SIZE	DEPTH SET
					2-3/8" &	10,434'
					2-7/8"	

26. Perforation record (interval, size, and number) 10,314-10,358, 1 JSPF, 27 holes	27. ACID, SHOT, FRACTURE, CEMENT, SQUEEZE, ETC.	
	DEPTH INTERVAL	AMOUNT AND KIND MATERIAL USED
	10,314'-10,358'	Acid w/3500 gals 15% NEFEHCL, tbq communicated w/annulus, reversed acid to pit

28. PRODUCTION							
Date First Production 3-31-89		Production Method (Flowing, gas lift, pumping - Size and type pump) 2" x 1-1/4" x 24'				Well Status (Prod. or Shut-in) Prod.	
Date of Test 3-31-89	Hours Tested 24	Choke Size	Prod'n For Test Period	Oil - Bbl. 11	Gas - MCF 8	Water - Bbl. 20	Gas - Oil Ratio 727/1
Flow Tubing Press.	Casing Pressure	Calculated 24-Hour Rate	Oil - Bbl.	Gas - MCF	Water - Bbl.	Oil Gravity - API - (Corr.)	
29. Disposition of Gas (Sold, used for fuel, vented, etc.) Sold						Test Witnessed By	

30. List Attachments C-104, C-102
--------------------------------------

31. I hereby certify that the information shown on both sides of this form is true and complete to the best of my knowledge and belief

Signature Maria L. Perez Printed Name Maria L. Perez Title Accountant Date 4-17-89

This is a combined test well - no production is attributed to it. See also...

## INSTRUCTIONS

This form is to be filed with the appropriate District Office of the Division not later than 20 days after the completion of any newly-drilled or deepened well. It shall be accompanied by one copy of all electrical and radio-activity logs run on the well and a summary of all special tests conducted, including drill stem tests. All depths reported shall be measured depths. In the case of directionally drilled wells, true vertical depths shall also be reported. For multiple completions, Items 25 through 29 shall be reported for each zone. The form is to be filed in quintuplicate except on state land, where six copies are required. See Rule 1105.

INDICATE FORMATION TOPS IN CONFORMANCE WITH GEOGRAPHICAL SECTION OF STATE

## Southeastern New Mexico

T. Anhy _____	T. Canyon _____
T. Salt _____	T. Strawn _____
B. Salt _____	T. Atoka _____
T. Yates _____	T. Miss _____
T. 7 Rivers _____	T. Devonian _____
T. Queen _____	T. Silurian _____
T. Grayburg _____	T. Montoya _____
T. San Andres _____	T. Simpson _____
T. Glorieta _____	T. McKee _____
T. Paddock _____	T. Ellenburger _____
T. Blinebry _____	T. Gr. Wash _____
T. Tubb _____	T. Delaware Sand _____
T. Drinkard _____	T. Bone Springs _____
T. Abo _____	T. _____
T. Wolfcamp _____	T. _____
T. Penn _____	T. _____
T. Cisco (Bough C) _____	T. _____

## Northwestern New Mexico

T. Ojo Alamo _____	T. Penn. "B" _____
T. Kirtland-Fruitland _____	T. Penn. "C" _____
T. Pictured Cliffs _____	T. Penn. "D" _____
T. Cliff House _____	T. Leadville _____
T. Menefee _____	T. Madison _____
T. Point Lookout _____	T. Elbert _____
T. Mancos _____	T. McCracken _____
T. Gallup _____	T. Ignacio Otzte _____
Base Greenhorn _____	T. Granite _____
T. Dakota _____	T. _____
T. Morrison _____	T. _____
T. Todilto _____	T. _____
T. Entrada _____	T. _____
T. Wingate _____	T. _____
T. Chinle _____	T. _____
T. Permian _____	T. _____
T. Penn. "A" _____	T. _____

### OIL OR GAS SANDS OR ZONES

No. 1, from.....to.....  
No. 2, from.....to.....  
No. 3, from.....to.....  
No. 4, from.....to.....

## ..... IMPORTANT WATER SANDS

**Include data on rate of water inflow and elevation to which water rose in hole.**

Include data on rate of water inflow and elevation to which water rose in hole.

No. 1, from.....to.....feet.....

No. 2, from.....to.....feet.....

No. 3, from.....to.....feet.....

U.S. GEOLOGICAL SURVEY RECORD (Attach additional sheet if necessary)

## LITHOLOGY RECORD (Attach additional sheet if necessary)

LITHOLOGY RECORD (Hatch Section)				LITHOLOGY RECORD (Hatch Section)			
From	To	Thickness in Feet	Lithology	From	To	Thickness in Feet	Lithology

RECEIVED

APR 19 1989

OCD

MORRIS C. JAMES

**RECEIVED**

**APR 19 1963**

OCD  
HOBBS OFFICE

NEW MEXICO OIL CONSERVATION COMMISSION  
WELL LOCATION AND ACREAGE DEDICATION PLAT

Form C-102  
Supersedes C-128  
Effective 1-1-65

All distances must be from the outer boundaries of the Section.

Operator Sun Exploration & Production Company			Lease New Mexico "R" State		Well No. 2
Unit Letter H	Section 33	Township 13-S	Range 34-E	County Lea	

Actual Footage Location of Well:

660	feet from the	East	line and	2129	feet from the	North	line
Ground Level Elev. 4140'	Producing Formation Lower Wolfcamp		Pool Cerca Lower Wolfcamp		Dedicated Acreage: 160 Acres		

1. Outline the acreage dedicated to the subject well by colored pencil or hachure marks on the plat below.
2. If more than one lease is dedicated to the well, outline each and identify the ownership thereof (both as to working interest and royalty).
3. If more than one lease of different ownership is dedicated to the well, have the interests of all owners been consolidated by communitization, unitization, force-pooling, etc?

☐ Yes ☐ No If answer is "yes," type of consolidation \_\_\_\_\_

If answer is "no," list the owners and tract descriptions which have actually been consolidated. (Use reverse side of this form if necessary.) \_\_\_\_\_

No allowable will be assigned to the well until all interests have been consolidated (by communitization, unitization, forced-pooling, or otherwise) or until a non-standard unit, eliminating such interests, has been approved by the Commission.

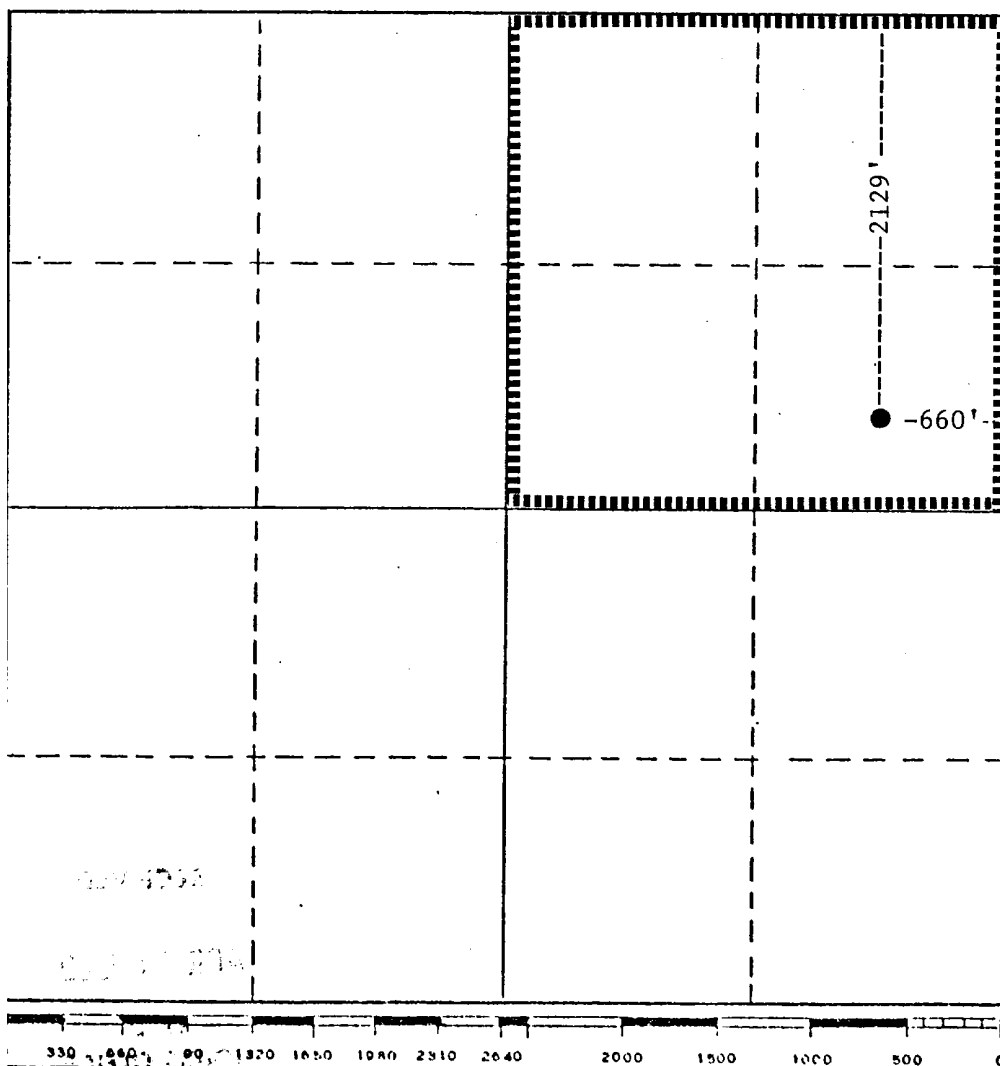

CERTIFICATION

I hereby certify that the information contained herein is true and complete to the best of my knowledge and belief.

*Maria L. Perez*  
Name

Maria L. Perez

Position

Accountant

Company

Sun Expl. & Prod. Co.

Date

4-17-89

I hereby certify that the well location shown on this plat was plotted from field notes of actual surveys made by me or under my supervision, and that the same is true and correct to the best of my knowledge and belief.

Date Surveyed

Registered Professional Engineer  
and/or Land Surveyor

Certificate No.



STATE OF NEW MEXICO  
ENERGY AND MINERALS DEPARTMENT  
OIL CONSERVATION DIVISION  
HOBBS DISTRICT OFFICE

GARREY CARRUTHERS  
GOVERNOR

4-17-89

POST OFFICE BOX 10801  
HOBBS, NEW MEXICO 88241-0801  
(505) 393-6161

DHC - 745

OIL CONSERVATION DIVISION  
P. O. BOX 2088  
SANTA FE, NEW MEXICO 87501

RE: Proposed:

MC \_\_\_\_\_  
DHC ☒ \_\_\_\_\_  
NSL \_\_\_\_\_  
NSP \_\_\_\_\_  
SWD \_\_\_\_\_  
WFX \_\_\_\_\_  
PMX \_\_\_\_\_

Gentlemen:

I have examined the application for the:

Sun Expl & Prod Co. New Mexico "A" State #211 33-13 3y  
Operator Lease & Well No. Unit S-T-R

and my recommendations are as follows:

OK - this just clears up  
paper work for us

Yours very truly,

Jerry Sexton  
Supervisor, District 1

/ed



**Sun Exploration and  
Production Company**  
No 24 Smith Road  
ClayDesta Plaza  
PO Box 1861  
Midland TX 79702 9970  
915 688 0300

April 13, 1989

Mr. David Catanach  
Energy & Mineral Dept.  
Oil Conservation Division  
P. O. Box 2088  
Santa Fe, NM 87501

RE: Request for Exception to Rule 303-A  
Downhole Commingling  
Sun Exploration & Production Company  
New Mexico 'R' State No. 2, Unit "H"  
2129' FNL & 660' FEL, Sec 33,  
T-13-S, R-34-E  
Cerca Upper Penn  
Cerca Lower Wolfcamp  
Lea County, New Mexico

Dear Mr. Catanach:

Sun Exploration and Production Company requests administrative approval for an exception to Rule 303-A to permit the downhole commingling of production in the subject well from the Cerca Upper Penn and Cerca Lower Wolfcamp pools in Lea County, New Mexico.

Sun performed a workover on the subject well from 3-14-89 thru 3-16-89. The work included acidizing the original perfs at 10398-407 in the Cerca Upper Penn and adding two sets of perfs, 10314-21 and 10341-58, in the Cerca Lower Wolfcamp. These perfs were found to be tight and unable to be broken down with acid and therefore are not contributing production in the well.

It was not realized by Sun that the perf additions at 10314-21 and 10341-58 were considered to be in a different pool from the Cerca Upper Penn. However, prior to performing the workover, proper commission approval had been gained.

RECEIVED

APR 17 1989

OCD  
HOBBS OFFICE

New Mexico 'R' State No. 2  
Page 2  
April 13, 1989

Because perfs are open in the Cerca Lower Wolfcamp pool and Cerca Upper Penn pool, downhole commingling permission is requested. However, since the Wolfcamp perfs were tight and non-productive, no additional information for this application is deemed pertinent.

Sincerely,

A handwritten signature in cursive script, appearing to read "Bruce Goodwin".

Bruce Goodwin  
Production Engineer  
(915) 688-0419

pk

Attachments:

1. Well History
2. Completion Log
3. Production Curve
4. Form C-103
5. Form C-116



NEW MEXICO 'R' STATE NO. 2

WELL HISTORY

LOCATION: 2129' FNL & 660' FEL, SEC 33, T-13-S, R-34-E, UNIT "H",  
CERCA UPPER PENN FIELD, LEA COUNTY, NEW MEXICO

ELEVATION: KB - 4153 GL - 4140

DEPTHS: TD - 10500 CS - 10500 PBD - 10454 (WL)

SPUD DATE: 09-08-69 COMPLETED: 10-14-69

CSG DATA: SURFACE - 13-3/8", 48#, H-40, STC CSG. CS  $\pm$ 455'.  
CMT'D W/250 SKS INCOR. CIRC 4 SKS TO SURFACE.

INTERMEDIATE - 8-5/8", 24 & 28#, J-55 & H-40, STC & LTC CSG.  
CS  $\pm$ 4500'. CMT'D W/300 SKS INCOR. DID NOT CIRC  
CMT. TOC  $\pm$ 2282 - CALCULATED.

PRODUCTION - 5-1/2", 15.5 & 17#, J-55 & N-80, BUTT, STC & LTC  
CSG. CS  $\pm$ 10500'. CMT'D W/200 SKS INCOR. TOC  
 $\pm$ 9350 VIA T.S.

LOGS AVAILABLE:

1. DRESSER-ATLAS GR/BHC SONIC DATED 10-6-69 FROM 10493-SURF.
2. DRESSER-ATLAS GR/LATEROLOG DATED 10-6-69 FROM 10492-4500.
3. MCCULLOUGH GR/CCL DATED 10-10-69 FROM 10452-9702.

WELL HISTORY:

10-10-69 BEGAN COMPLETION. MCCULLOUGH RAN GR/CCL FROM 10452 TO 9702  
(WL TD 10454'). PERF PENN "A" LIME SET I 10398, 400, 403,  
405, 407, 1 JSPF, TOTAL 5 HOLES W/3-1/8" CG.

10-11-69 DOWELL ACIDIZED 10398-407 W/1000 GALS 15% BDA. BDP - VAC,  
FP - 0, ISIP - VAC. AIR 3 BPM. SWAB & FLOW BACK L&AW.

10-14-69 I.P. 24 HRS F 309 BO, 10 BLW, 134 MCF, 48/64" CHOKE, 50# FTP,  
GOR 435-1, 43.5° API. FINAL REPORT.

03-04-78 DUMP ACID JOB FOR POSSIBLE SCALE BUILD-UP. A.A. OILFIELD  
SERVICE PUMP 500 GALS 15% NEFEHCL DN ANNULUS. FLUSHED ACID  
W/30 BBLS LEASE OIL. LEFT WELL SHUT-IN 4 HRS. RESUMED  
PUMPING. NO CHANGE IN PRODUCTION BASED ON PRODUCTION CURVE.

11-88 LAST TEST: 18.8 BO, 7 BW, 12.7 MCF

CUMULATIVE PRODUCTION (THRU 11/88): 256.6 MBO, 203.9 BSCF

RECEIVED

APR 17 1989

1000  
HONOLULU OFFICE



# NEW MEXICO R STATE NO.2

SUN EXPLORATION AND PRODUCTION

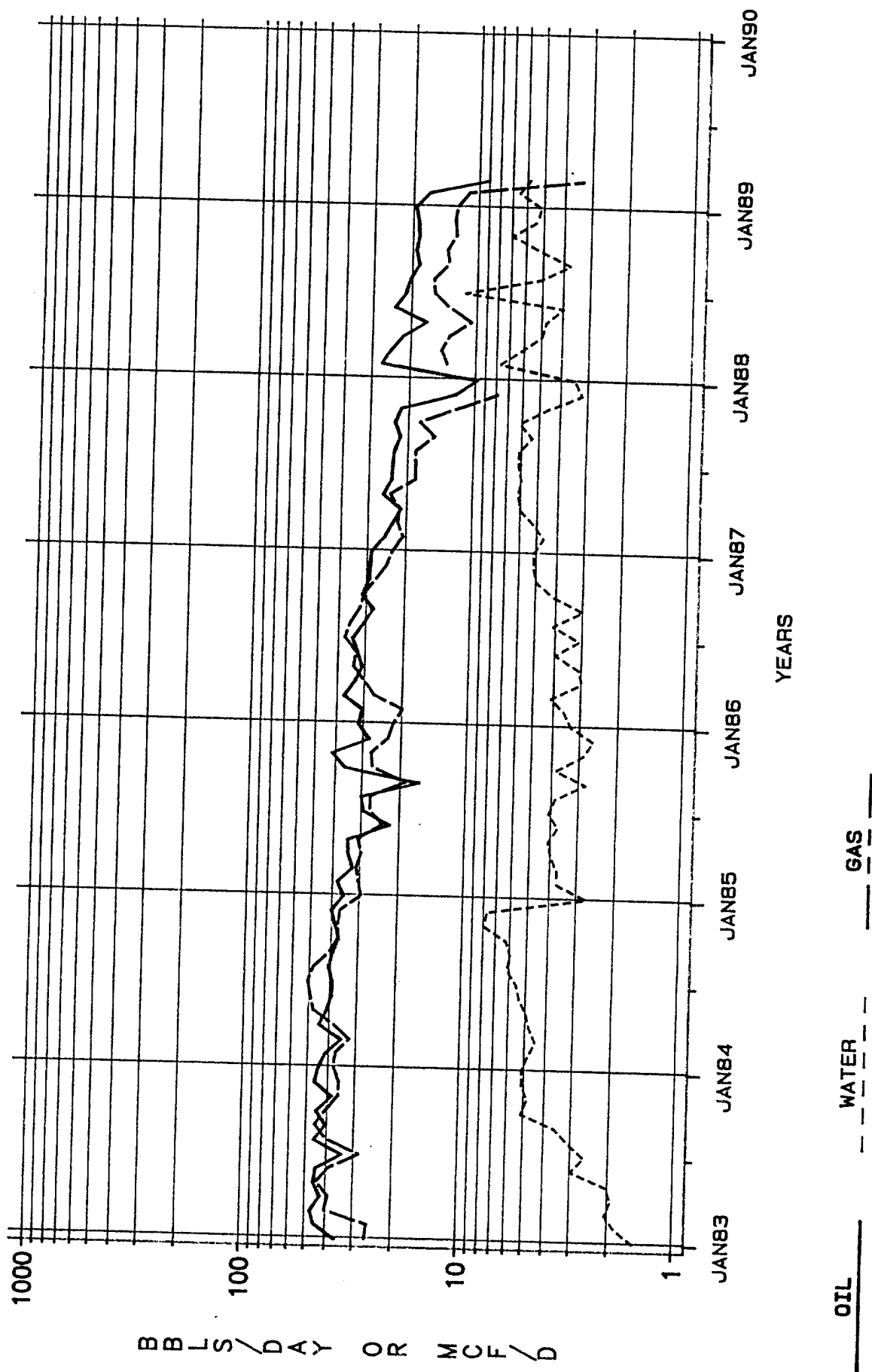

DISTRICT I  
P.O. Box 1980, Hobbs, NM 88240

DISTRICT II  
P.O. Drawer DD, Artesia, NM 88210

DISTRICT III  
1000 Rio Brazos Rd., Aztec, NM 87410

**OIL CONSERVATION DIVISION**  
P.O. Box 2088  
Santa Fe, New Mexico 87504-2088

WELL API NO. 30-025-23266
5. Indicate Type of Lease STATE <input checked="" type="checkbox"/> FEE <input type="checkbox"/>
6. State Oil & Gas Lease No. 065217
7. Lease Name or Unit Agreement Name New Mexico "R" State
8. Well No. 2
9. Pool name or Wildcat Cera (upper Penn)

<b>SUNDRY NOTICES AND REPORTS ON WELLS</b> (DO NOT USE THIS FORM FOR PROPOSALS TO DRILL OR TO DEEPEN OR PLUG BACK TO A DIFFERENT RESERVOIR. USE "APPLICATION FOR PERMIT" (FORM C-101) FOR SUCH PROPOSALS.)	
1. Type of Well: OIL WELL <input checked="" type="checkbox"/> GAS WELL <input type="checkbox"/> OTHER <input type="checkbox"/>	
2. Name of Operator Sun Exploration & Production Co.	
3. Address of Operator P.O. Box 1861, Midland, Texas 79702	
4. Well Location Unit Letter <u>H</u> : <u>660</u> Feet From The <u>East</u> Line and <u>2129</u> Feet From The <u>North</u> Line Section <u>33</u> Township <u>13-S</u> Range <u>34-E</u> NMPM <u>Lea</u> County <u></u>	
10. Elevation (Show whether DF, RKB, RT, GR, etc.) <u>4140' GR</u>	

11. Check Appropriate Box to Indicate Nature of Notice, Report, or Other Data	
<b>NOTICE OF INTENTION TO:</b>	<b>SUBSEQUENT REPORT OF:</b>
PERFORM REMEDIAL WORK <input type="checkbox"/>	REMEDIAL WORK <input type="checkbox"/>
TEMPORARILY ABANDON <input type="checkbox"/>	ALTERING CASING <input type="checkbox"/>
PULL OR ALTER CASING <input type="checkbox"/>	COMMENCE DRILLING OPNS. <input type="checkbox"/>
OTHER: <input type="checkbox"/>	PLUG AND ABANDONMENT <input type="checkbox"/>
	CASING TEST AND CEMENT JOB <input type="checkbox"/>
	OTHER: <u>Add Perfs</u> <input checked="" type="checkbox"/>

12. Describe Proposed or Completed Operations (Clearly state all pertinent details, and give pertinent dates, including estimated date of starting any proposed work) SEE RULE 1103.

3/14/89 Perf Wolfcamp Set I & II from 10341-58 & 10314-21 WD 1 JSPF 27 holes. Howco spot & Displaced 1500 gal's 15% NEFCHCL acid into Penn perfs 10398-407. Raised and reset RBP @10,375' tested to 1500' O.K. Howco spot 2 BBL's 15% NEFCHCL Acid from 10360-274', raised and set pkr @ 10205'. pressured annulus to 1000# Howco attempt to acidz wolfcamp set I & II perfs from 10314-58 w/3500 gal 15% NEFCHCL acid, pumped into the perfs @ 1/2 BPM 4200#, opened by-pass\*, continued pumping @ 1/2 BPM 4200# tbq communicated w/ annulus, open by pass rev acid to Pit.

3/15/89 Set pkr at 10170' press annulus to 1000#, Howco EIR into Wolfcamp perfs Set I & II 10314-58 w/2% KCL wtr 1 BPM at 4800# before switching to acid press communicated to annulus.

3/16/89 RIH w/ 2 3/8" & 2 7/8" tbq. TS 10434' RIH w/2" X 1 1/4 X 24' pump.

3/31/89 24P 11 Bo 20 BLW 8 MCF

\* Spotted Acid to pkr, closed by pass.

I hereby certify that the information above is true and complete to the best of my knowledge and belief.

SIGNATURE Maria L. Perez TITLE Accountant DATE 4-10-89

TYPE OR PRINT NAME Maria L. Perez

TELEPHONE NO. 915 688-0375

(This space for State Use)

APPROVED BY \_\_\_\_\_ TITLE \_\_\_\_\_ DATE \_\_\_\_\_

CONDITIONS OF APPROVAL, IF ANY:

## GAS - OIL RATIO TEST

Operator		Pool		County										
Sun Exploration & Production Co.		Cera (Upper Penn)		Lea										
Address		TYPE OF TEST - (X)		Completion										
P.O. Box 1861, Midland, Texas 79702				Special XX										
LEASE NAME	WELL NO.	LOCATION			DATE OF TEST	CHOKE SIZE	TBG. PRESS.	DAILY ALLOW-ABLE	LENGTH OF TEST HOURS	PROD. DURING TEST			GAS - C' RATIC CU. FT/BBL.	
		U	S	T						R	WATER BBLs.	GRAV. OIL		OIL BBLs.
New Mexico "R" State	2	H	33	13	34	3-31-89	P			24	20	11	8	727/1

Instructions:

During gas-oil ratio test, each well shall be produced at a rate not exceeding the top unit allowable for the pool in which well is located by more than 25 percent. Operator is encouraged to take advantage of this 25 percent tolerance in order that well can be assigned increased allowables when authorized by the Division.

Gas volumes must be reported in MCF measured at a pressure base of 15.025 psia and a temperature of 60° F. Specific gravity base will be 0.60.

Report casing pressure in lieu of tubing pressure for any well producing through casing.

(See Rule 301, Rule 1116 & appropriate pool rules.)

I hereby certify that the above information is true and complete to the best of my knowledge and belief.

Signature

Maria L. Perez Accountant

Printed name and title

4-10-89

Date \_\_\_\_\_

915 688-0375

**Telephone No.**