

NO. OF COPIES RECEIVED	
DISTRIBUTION	
SANTA FE	
FILE	
U.S.G.S.	
LAND OFFICE	
OPERATOR	

5A. Indicate Type of Lease
STATE <input checked="" type="checkbox"/> FEE <input type="checkbox"/>
5. State Oil & Gas Lease No.
V-167

APPLICATION FOR PERMIT TO DRILL, DEEPEN, OR PLUG BACK

1a. Type of Work

DRILL ☒ REENTRYDEEPEN ☐PLUG BACK ☐

b. Type of Well

OIL WELL ☒ GAS WELL ☐ OTHER ☐SINGLE ZONE ☐MULTIPLE ZONE ☐

2. Name of Operator

Yates Petroleum Corporation

3. Address of Operator

207 S. 4th, Artesia, New Mexico 88210

4. Location of Well

UNIT LETTER N LOCATED 330 FEET FROM THE South LINEAND 1652 FEET FROM THE West LINE OF SEC. 17 TWP. 13S RGE. 33E NMPM

7. Unit Agreement Name

8. Farm or Lease Name

Pan American "VJ" St.

9. Well No.

1

10. Field and Pool, or Wildcat

Undes. Baum-Upper

Penn

12. County

Lea

19. Proposed Depth

appr. 10100'

19A. Formation

Upper Penn

20. Rotary or C.T.

Rotary

1. Elevations (show whether DF, KT, etc.)

4268' GL

21A. Kind & Status Plug. Bond

Blanket

21B. Drilling Contractor

55 Pulling Unit

22. Approx. Date Work will start

ASAP

3.

PROPOSED CASING AND CEMENT PROGRAM

SIZE OF HOLE	SIZE OF CASING	WEIGHT PER FOOT	SETTING DEPTH	SACKS OF CEMENT	EST. TOP
in place	11 3/4"		420'	400 SX	
in place	8 5/8"		3970'	400 SX	
7 7/8"	5 1/2"	17# K&N	TD	250 SX	

We propose to drill plugs and clean out hole to 9756', then deepen to 10100'. Test the Upper Penn formation. If commercial, production tubing will be run, perforated and stimulated as needed for production. This well drilled by Cactus Drilling Corp. of Texas in January of 1970 as the Pan American State #1-B. D/A 2-25-70

MUD PROGRAM: Native mud to 9756', starch/drispak/KCL to TD.

BOP PROGRAM: BOP will be installed at the start.

This is an unorthodox location, administrative approval has been requested.

ABOVE SPACE DESCRIBE PROPOSED PROGRAM; IF PROPOSAL IS TO DEEPEN OR PLUG BACK, GIVE DATA ON PRESENT PRODUCTIVE ZONE AND PROPOSED NEW PRODUCTION ZONE. GIVE BLOWOUT PREVENTER PROGRAM, IF ANY.

I hereby certify that the information above is true and complete to the best of my knowledge and belief.

Signed Jerry Sexton Title Regulatory Agent Date 7/28/83

(This space for State Use)

ORIGINAL SIGNED BY JERRY SEXTON

PROVED BY DISTRICT 1 SUPERVISOR TITLE

DATE

AUG 1 1983

CONDITIONS OF APPROVAL, IF ANY:

Production from this well will not be authorized until the unorthodox location has been approved by the Santa Fe office of the OCD.

OIL CONSERVATION DIVISION

STATE OF NEW MEXICO
OIL AND MINERALS DEPARTMENTP. O. BOX 2088
SANTA FE, NEW MEXICO 87501Form C-102
Revised 10-1-78

All distances must be from the outer boundaries of the Section.

YATES PETROLEUM CORP.		Lease PAN AMERICAN "VJ" STATE		Well No. 1
Section N	Section 17	Township 13 SOUTH	Range 33 EAST	County LEA

Footage Location of Well: 330 feet from the SOUTH line and 1652 feet from the WEST line				
Level Elev. 4268'	Producing Formation UPPER PENN	Pool UNDES. BAUM-UPPER PENN	Dedicated Acreage: 160 Acres	

Outline the acreage dedicated to the subject well by colored pencil or hatchure marks on the plat below.

If more than one lease is dedicated to the well, outline each and identify the ownership thereof (both as to working interest and royalty).

If more than one lease of different ownership is dedicated to the well, have the interests of all owners been consolidated by communitization, unitization, force-pooling, etc?

☐ Yes ☐ No If answer is "yes," type of consolidation _____

If answer is "no," list the owners and tract descriptions which have actually been consolidated. (Use reverse side of this form if necessary.) _____

No allowable will be assigned to the well until all interests have been consolidated (by communitization, unitization, forced-pooling, or otherwise) or until a non-standard unit, eliminating such interests, has been approved by the Division.

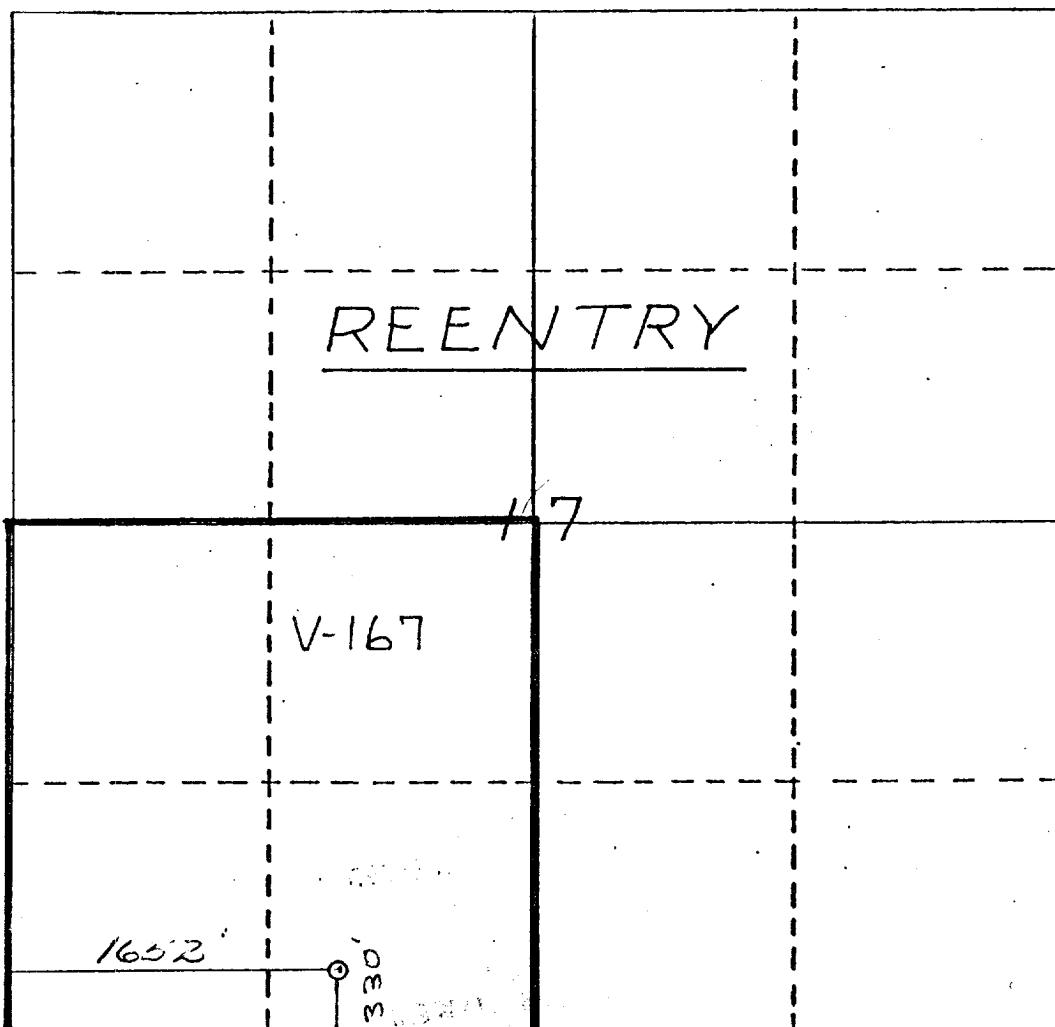

CERTIFICATION

I hereby certify that the information contained herein is true and complete to the best of my knowledge and belief.

Gliserio Rodriguez
Name

GLISERIO RODRIGUEZ

Position

AGENT

Company

YATES PETROLEUM CORP.

Date

7-28-83

I hereby certify that the well location shown on this plat was plotted from field notes of actual surveys made by me or under my supervision, and that the same is true and correct to the best of my knowledge and belief.

REFER TO

Date Surveyed

ORIGINAL PLAT

Registered Professional Engineer
and/or Land Surveyor

Certificate No.

660 80 1320 1680 1940 2310 2640 2000 1500 1000 500 0

Rotating head if necessary
2" Fill up Line

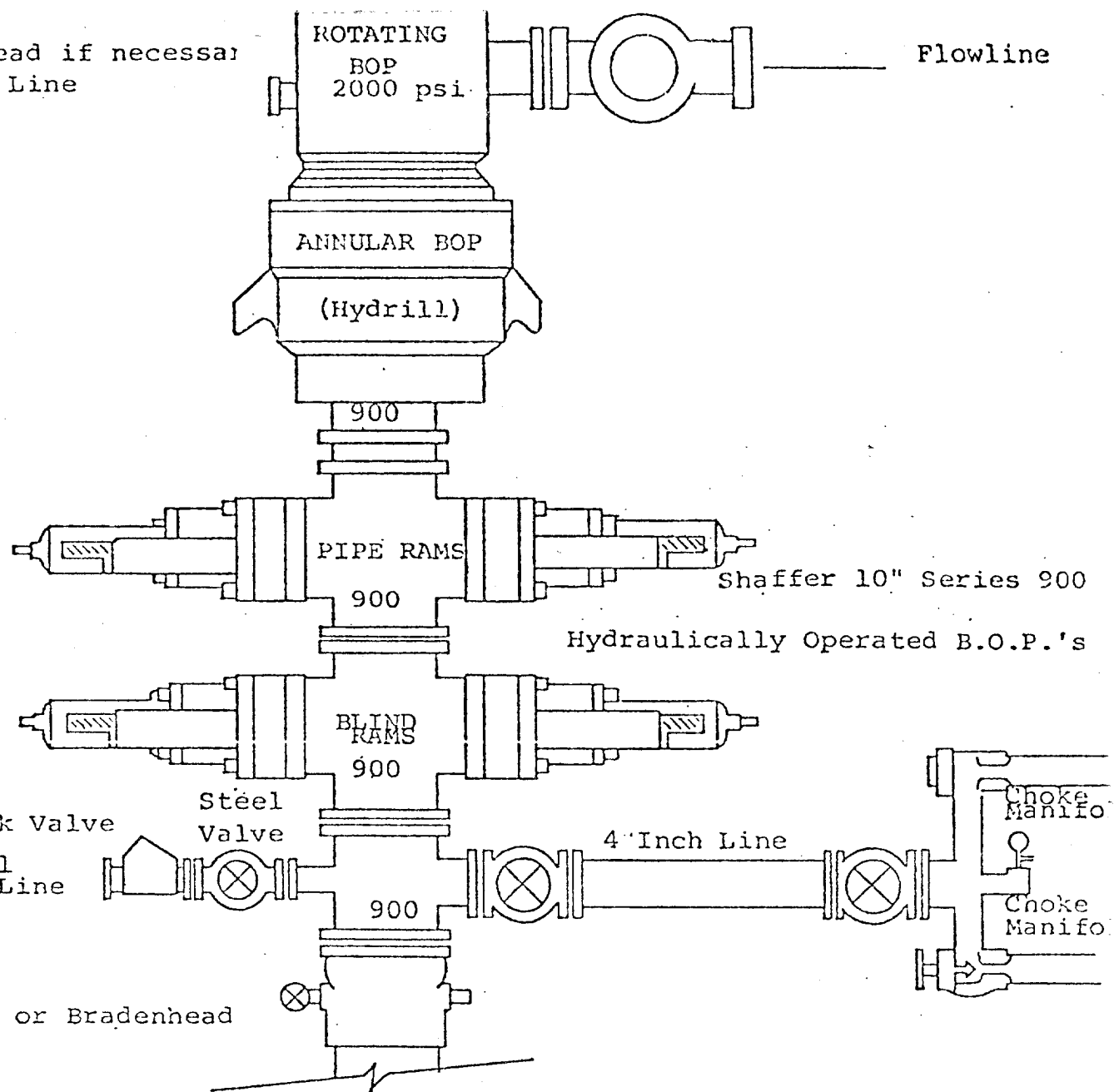

THE FOLLOWING CONSTITUTE MINIMUM BLOWOUT PREVENTER REQUIREMENTS

1. All preventers to be hydraulically operated with secondary manual control installed prior to drilling out from under casing.
2. Choke outlet to be a minimum of 4" diameter.
3. Kill line to be of all steel construction of 2" minimum diameter.
4. All connections from operating manifolds to preventers to be all steel. hole or tube a minimum of one inch in diameter.
5. The available closing pressure shall be at least 15% in excess of that required with sufficient volume to operate the B.O.P.'s.
6. All connections to and from preventer to have a pressure rating equivalent to that of the B.O.P.'s.
7. Inside blowout preventer to be available on rig floor.
8. Operating controls located a safe distance from the rig floor.
9. Hole must be kept filled on trips below intermediate casing.
10. D. P. float must be installed and used below zone of first gas intrusion.

RECEIVED

AUG 1 1983

**O.C.D.
HOBBS OFFICE**