

NO. OF COPIES RECEIVED		
DISTRIBUTION		
SANTAFE		
FILE		
U.S.G.S.		
LAND OFFICE		
OPERATOR		

# NEW MEXICO OIL CONSERVATION COMMISSION

Form C-101  
Revised 1-1-65

5A. Indicate Type of Lease	
STATE <input checked="" type="checkbox"/>	FEE <input type="checkbox"/>
5. State Oil & Gas Lease No. <b>L-523</b>	
7. Unit Agreement Name	
8. Farm or Lease Name <b>State 34</b>	
9. Well No. <b>1</b>	
10. Field and Pool, or Wildcat <b>Undes. Tulk Penn</b>	
12. County <b>Lea</b>	
19. Proposed Depth <b>10,200</b>	19A. Formation <b>Penn</b>
20. Rotary or C.T. <b>Rotary</b>	
21. Elevations (Show whether DF, RT, etc.) <b>4292.8 GR</b>	21A. Kind & Status Plug. Bond <b>Blanket</b>
21B. Drilling Contractor <b>Not let</b>	
22. Approx. Date Work will start <b>Upon approval</b>	

## APPLICATION FOR PERMIT TO DRILL, DEEPEN, OR PLUG BACK

1a. Type of Work	
DRILL <input checked="" type="checkbox"/>	DEEPEN <input type="checkbox"/>
b. Type of Well	
OIL WELL <input checked="" type="checkbox"/>	GAS WELL <input type="checkbox"/>
OTHER <input type="checkbox"/>	
2. Name of Operator <b>Constal States Gas Producing Company</b>	
3. Address of Operator <b>c/o Oil Reports &amp; Gas Services, Box 763, Hobbs, New Mexico 88240</b>	
4. Location of Well	
UNIT LETTER <b>H</b>	LOCATED <b>1980</b> FEET FROM THE <b>North</b> LINE
AND <b>710</b> FEET FROM THE <b>East</b> LINE OF SEC. <b>34</b> TWP. <b>14 S</b> RGE. <b>32 E</b> NMPM	
21. Elevations (Show whether DF, RT, etc.) <b>4292.8 GR</b>	
21A. Kind & Status Plug. Bond <b>Blanket</b>	
21B. Drilling Contractor <b>Not let</b>	
22. Approx. Date Work will start <b>Upon approval</b>	

23.

## PROPOSED CASING AND CEMENT PROGRAM

SIZE OF HOLE	SIZE OF CASING	WEIGHT PER FOOT	SETTING DEPTH	SACKS OF CEMENT	EST. TOP
17	13 3/8	48#	350	350	Circ.
11	8 5/8	24# & 32#	4100	300	3000
7 7/8	5 1/2	17#	10200	200	9200

IN ABOVE SPACE DESCRIBE PROPOSED PROGRAM: IF PROPOSAL IS TO DEEPEN OR PLUG BACK, GIVE DATA ON PRESENT PRODUCTIVE ZONE AND PROPOSED NEW PRODUCTIVE ZONE. GIVE BLOWOUT PREVENTER PROGRAM, IF ANY.

I hereby certify that the information above is true and complete to the best of my knowledge and belief.

Signed *H. L. Smith* Title Agent Date 2/26/70

(This space for State Use)

APPROVED BY *[Signature]* TITLE  DATE MAR 2 1970

CONDITIONS OF APPROVAL, IF ANY:

NEW MEXICO OIL CONSERVATION COMMISSION  
WELL LOCATION AND ACREAGE DEDICATION PLAT

MAR 2 1970

Form C-102  
Supersedes C-128  
Effective 1-1-65

All distances must be from the outer boundaries of the Section.

Operator <b>COASTAL STATES GAS PRODUCING CO.</b>		Lease <b>STATE 34</b>		Well No. <b>1</b>
Unit Letter <b>H</b>	Section <b>34</b>	Township <b>14 SOUTH</b>	Range <b>32 EAST</b>	County <b>LEA</b>
Actual Footage Location of Well: <b>1980</b> feet from the <b>NORTH</b> line and <b>710</b> feet from the <b>EAST</b> line				
Ground Level Elev. <b>4292.8</b>	Producing Formation <b>Penn</b>	Pool <b>Undes. Tulk Penn</b>	Dedicated Acreage: <b>160</b> Acres	

1. Outline the acreage dedicated to the subject well by colored pencil or hachure marks on the plat below.
2. If more than one lease is dedicated to the well, outline each and identify the ownership thereof (both as to working interest and royalty).
3. If more than one lease of different ownership is dedicated to the well, have the interests of all owners been consolidated by communitization, unitization, force-pooling, etc?

☐ Yes ☐ No If answer is "yes," type of consolidation \_\_\_\_\_

If answer is "no," list the owners and tract descriptions which have actually been consolidated. (Use reverse side of this form if necessary.) \_\_\_\_\_

No allowable will be assigned to the well until all interests have been consolidated (by communitization, unitization, forced-pooling, or otherwise) or until a non-standard unit, eliminating such interests, has been approved by the Commission.

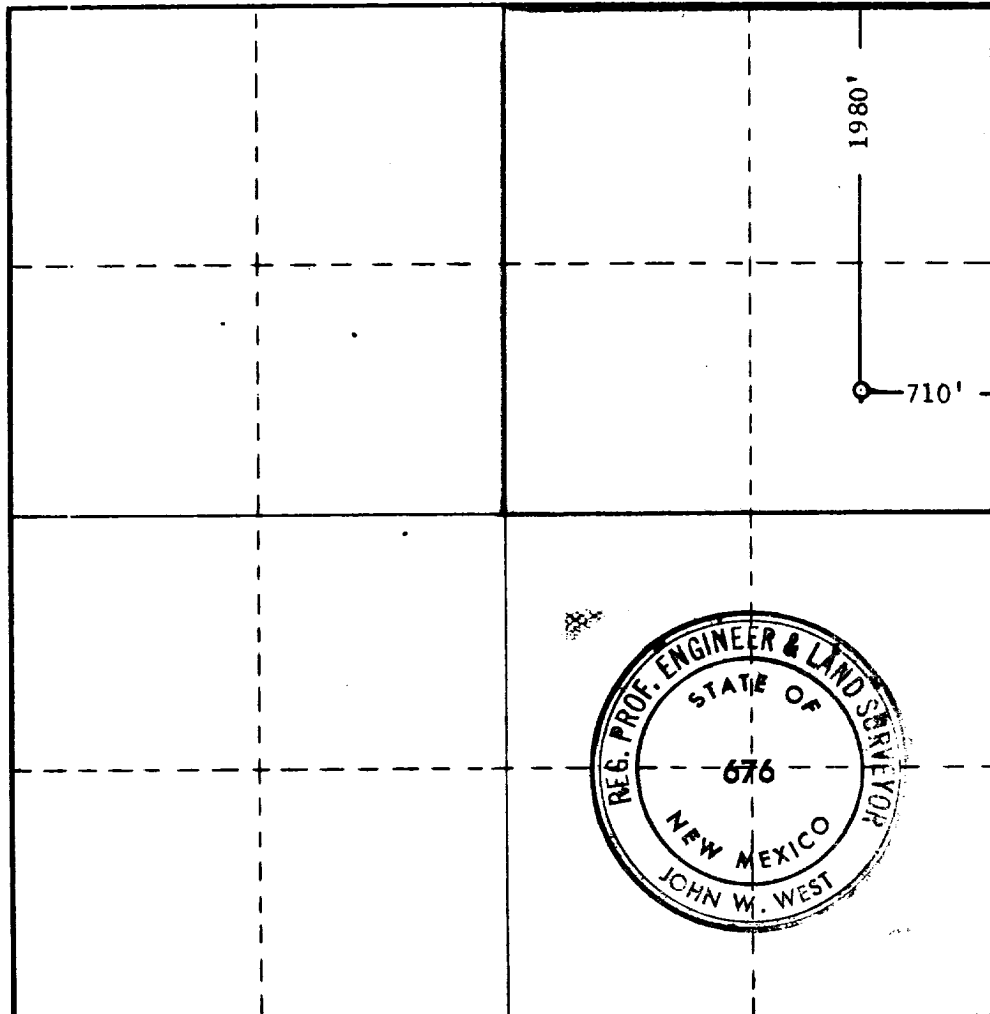

CERTIFICATION

I hereby certify that the information contained herein is true and complete to the best of my knowledge and belief.

Name Wanda Dolles  
Position Agent  
Company Coastal States Gas Prod. Co.  
Date 3/2/70

I hereby certify that the well location shown on this plat was plotted from field notes of actual surveys made by me or under my supervision, and that the same is true and correct to the best of my knowledge and belief.

Date Surveyed FEB. 26, 1970

Registered Professional Engineer and/or Land Surveyor

John W. West  
Certificate No. 676

