

NO. OF COPIES RECEIVED	
DISTRIBUTION	
SANTA FE	
FILE	
U.S.G.S.	
LAND OFFICE	
OPERATOR	

# N. MEXICO OIL CONSERVATION COMMISSION

Form C-101  
Revised 1-1-65

5A. Indicate Type of Lease	
STATE <input checked="" type="checkbox"/>	FEE <input type="checkbox"/>
5. State Oil & Gas Lease No.	
K-5449	

## APPLICATION FOR PERMIT TO DRILL, DEEPEN, OR PLUG BACK

1a. Type of Work				7. Unit Agreement Name	
b. Type of Well DRILL <input type="checkbox"/> DEEPEN <input type="checkbox"/> PLUG BACK <input checked="" type="checkbox"/> OIL WELL <input checked="" type="checkbox"/> GAS WELL <input type="checkbox"/> OTHER <input type="checkbox"/> SINGLE ZONE <input checked="" type="checkbox"/> MULTIPLE ZONE <input type="checkbox"/>				8. Farm or Lease Name	
2. Name of Operator				9. Well No.	
The Superior Oil Company				1	
3. Address of Operator				10. Field and Pool, or Wildcat	
P. O. Box 1900, Midland, Texas 79701				Cerca-Upper Penn	
4. Location of Well UNIT LETTER M LOCATED 660 FEET FROM THE South LINE AND 660 FEET FROM THE West LINE OF SEC. 2 TWP. 14-S RGE. 34-E N.M.P.M.				12. County	
				Lea	
				19. Proposed Depth	
				PBTD: 10,250'	
				19A. Formation	
				Wolfcamp	
				20. History or C.T.	
				Workover Rig	
21. Elevations (Show whether D.F., R.T., etc.)		21A. Kind & Status Plug. Bond		21B. Drilling Contractor	
KB: 4128'		Blanket		Unknown	
				22. Approx. Date Work will start	
				Nov. 10, 1974	

23.

## PROPOSED CASING AND CEMENT PROGRAM

SIZE OF HOLE	SIZE OF CASING	WEIGHT PER FOOT	SETTING DEPTH	SACKS OF CEMENT	EST. TOP
15"	11-3/4"		400'	520	Surface
11"	8-5/8"		4,500'	775	2050'
7-7/8"	5-1/2"		10,600'	200	9650'

We propose to set a wireline bridge plug at approximately 10,250' to blank off Penn perfs 10,500'-10,519'. Perforate Wolfcamp Zone from 10,173'-10,182'. Run tubing and swab well to determine entry prior to acidizing with 500 gallons 15% MCA acid.

This well is temporarily abandoned in the Penn Zone. We will attempt to complete in the Wolfcamp Zone.

IN ABOVE SPACE DESCRIBE PROPOSED PROGRAM; IF PROPOSAL IS TO DEEPEN OR PLUG BACK, GIVE DATA ON PRESENT PRODUCTIVE ZONE AND PROPOSED NEW PRODUCTIVE ZONE. GIVE BLOWOUT PREVENTER PROGRAM, IF ANY.

I hereby certify that the information above is true and complete to the best of my knowledge and belief.

Signed T. D. Clay T. D. Clay Title Petroleum Engineer Date Oct. 30, 1974

(This space for State Use)

APPROVED BY [Signature] TITLE CHIEF DATE

CONDITIONS OF APPROVAL, IF ANY:

NEW MEXICO OIL CONSERVATION COMMISSION  
WELL LOCATION AND ACREAGE DEDICATION PLAT

Form C-102  
Supersedes C-128  
Effective 1-1-65

All distances must be from the outer boundaries of the Section.

Operator <b>THE SUPERIOR OIL CO.</b>			Lease <b>STATE "H"</b>		Well No. <b>1</b>
Unit Letter <b>M</b>	Section <b>2</b>	Township <b>14 SOUTH</b>	Range <b>34 EAST</b>	County <b>LEA</b>	

Actual Footage Location of Well:

**660** feet from the **SOUTH** line and **660** feet from the **WEST** line

Ground Level Elev. <b>4107.8</b>	Producing Formation <b>Geologic</b> Objective: <b>Upper Penn</b>	Pool <b>Wildcat - Undesignated</b>	Dedicated Acreage: <b>Statewide 40</b> Acres
-------------------------------------	--	---------------------------------------	---

1. Outline the acreage dedicated to the subject well by colored pencil or hachure marks on the plat below.
2. If more than one lease is dedicated to the well, outline each and identify the ownership thereof (both as to working interest and royalty).
3. If more than one lease of different ownership is dedicated to the well, have the interests of all owners been consolidated by communitization, unitization, force-pooling, etc?

State Lease K-5449 covers SW/4

☐ Yes ☒ No If answer is "yes," type of consolidation Section 2-14S-34E and no communitization required.

If answer is "no," list the owners and tract descriptions which have actually been consolidated. (Use reverse side of this form if necessary.) \_\_\_\_\_

No allowable will be assigned to the well until all interests have been consolidated (by communitization, unitization, forced-pooling, or otherwise) or until a non-standard unit, eliminating such interests, has been approved by the Commission.

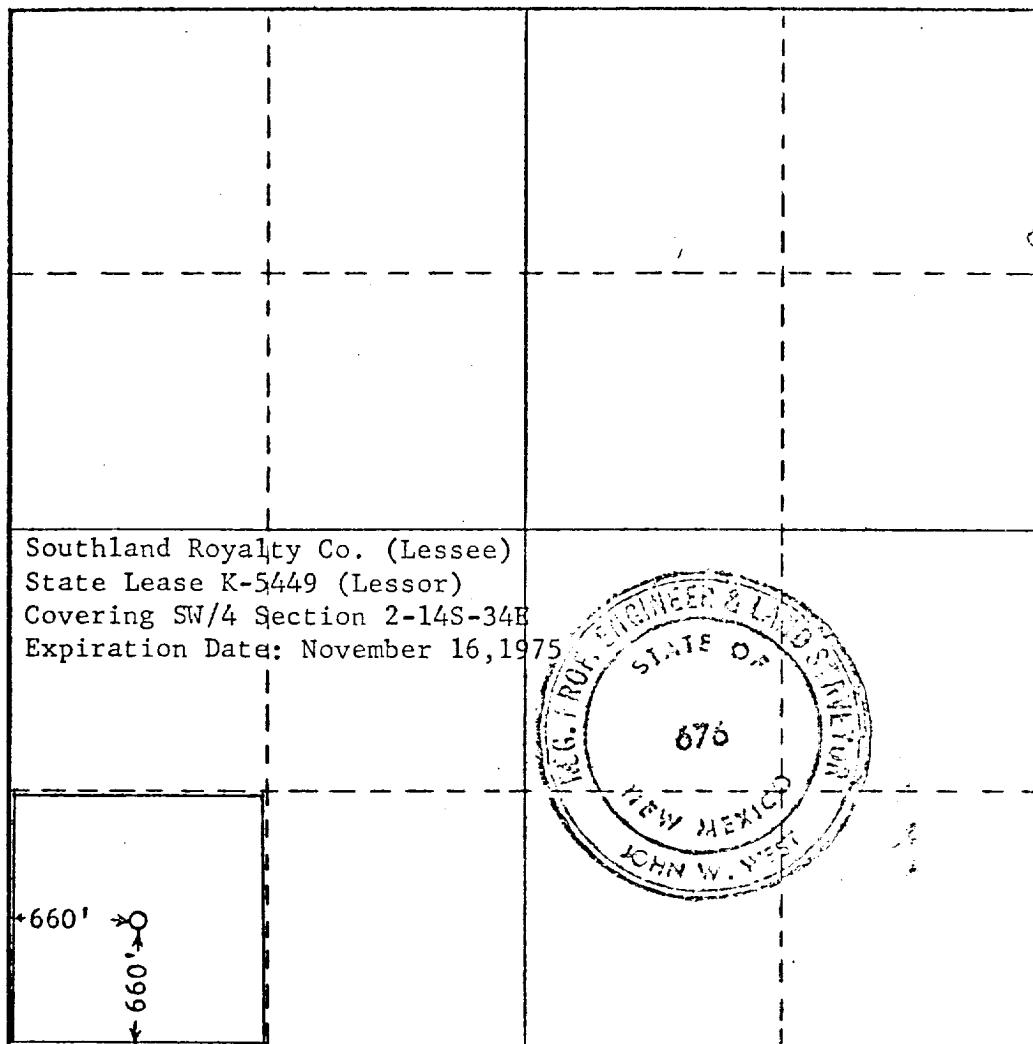

**CERTIFICATION**

I hereby certify that the information contained herein is true and complete to the best of my knowledge and belief.

Name

**T. D. Clay**

Position

**Production Engineer**

Company

**The Superior Oil Company**

Date

**January 8, 1971**

I hereby certify that the well location shown on this plat was plotted from field notes of actual surveys made by me or under my supervision, and that the same is true and correct to the best of my knowledge and belief.

Date Surveyed

**JANUARY 7, 1971**

Registered Professional Engineer and/or Land Surveyor

Certificate No.

**676**