

NO. OF COPIES RECEIVED	
DISTRIBUTION	
SANTA FE	
FILE	
U.S.G.S.	
LAND OFFICE	
OPERATOR	

# NEW MEXICO OIL CONSERVATION COMMISSION

Form C-101  
Revised 1-1-65

5A. Indicate Type of Lease  
STATE ☐ FEE ☒

5. State Oil & Gas Lease No.

## APPLICATION FOR PERMIT TO DRILL, DEEPEN, OR PLUG BACK

1a. Type of Work DRILL <input checked="" type="checkbox"/> DEEPEN <input type="checkbox"/> PLUG BACK <input type="checkbox"/>		7. Unit Agreement Name
b. Type of Well OIL WELL <input checked="" type="checkbox"/> GAS WELL <input type="checkbox"/> OTHER <input type="checkbox"/> SINGLE ZONE <input type="checkbox"/> MULTIPLE ZONE <input checked="" type="checkbox"/>		8. Farm or Lease Name <b>Griffin</b>
2. Name of Operator <b>J.M. Huber Corporation</b>		9. Well No. <b>I</b>
3. Address of Operator <b>1900 Wilco Building, Midland, Texas 79701</b>		10. Field and Pool, or Wildcat <b>Wildcat</b>
4. Location of Well UNIT LETTER <b>A</b> LOCATED <b>660</b> FEET FROM THE <b>North</b> LINE AND <b>660</b> FEET FROM THE <b>East</b> LINE OF SEC. <b>4</b> TWP. <b>14S</b> RGE. <b>36E</b> NMPM		12. County <b>Lea</b>
19. Proposed Depth <b>11,400'</b>		19A. Formation <b>Canyon</b>
20. Rotary or C.T. <b>Rotary</b>		
21. Elevations (Show whether DF, RT, etc.)	21A. Kind & Status Plug. Bond <b>Blanket</b>	21B. Drilling Contractor <b>Unknown</b>
22. Approx. Date Work will start <b>5/27/1971</b>		

## PROPOSED CASING AND CEMENT PROGRAM

SIZE OF HOLE	SIZE OF CASING	WEIGHT PER FOOT	SETTING DEPTH	SACKS OF CEMENT	EST. TOP
17-1/2	13-3/8	48 & 54	400	350	Circ.
12-1/4	9-5/8	36 & 40	4,600	450	3000'
8-3/4	7	23 & 26	11,400	500	8000'

THIS COPIED TO BE RETURNED  
24 HOURS AFTER TO THE  
CASING.

APPROVAL VALID  
FOR 90 DAYS UNLESS  
DRILLING COMMENCED,

EXPIRES 8-19-71

IN ABOVE SPACE DESCRIBE PROPOSED PROGRAM: IF PROPOSAL IS TO DEEPEN OR PLUG BACK, GIVE DATA ON PRESENT PRODUCTIVE ZONE AND PROPOSED NEW PRODUCTIVE ZONE. GIVE BLOWOUT PREVENTER PROGRAM, IF ANY.

I hereby certify that the information above is true and complete to the best of my knowledge and belief.

Signed Floyd E. Meade Title District Production Supt. Date May 17, 1971

(This space for State Use)

APPROVED BY [Signature] TITLE SUPERVISOR DISTRICT : DATE MAY 19 1971

CONDITIONS OF APPROVAL, IF ANY:

RECEIVED

MAY 1 1971

OIL CONSERVATION COMM.  
HOBBS, N. M.

**NEW MEXICO OIL CONSERVATION COMMISSION  
WELL LOCATION AND ACREAGE DEDICATION PLAT**

Form C-102  
Supersedes C-128  
Effective 1-1-65

All distances must be from the outer boundaries of the Section.

Operator <b>J. M. HUBER CORP.</b>			Lease <b>GRIFFIN</b>		Well No. <b>1</b>
Unit Letter <b>A</b>	Section <b>4</b>	Township <b>14 SOUTH</b>	Range <b>36 EAST</b>	County <b>LEA</b>	
Actual Footage Location of Well: <b>660</b> feet from the <b>NORTH</b> line and <b>660</b> feet from the <b>EAST</b> line					
Ground Level Elev.	Producing Formation <b>Canyon</b>		Pool <b>Wildcat</b>		Dedicated Acreage: <b>40</b> Acres

1. Outline the acreage dedicated to the subject well by colored pencil or hachure marks on the plat below.
2. If more than one lease is dedicated to the well, outline each and identify the ownership thereof (both as to working interest and royalty).
3. If more than one lease of different ownership is dedicated to the well, have the interests of all owners been consolidated by communitization, unitization, force-pooling, etc?

☐ Yes    ☐ No    If answer is "yes," type of consolidation \_\_\_\_\_

If answer is "no," list the owners and tract descriptions which have actually been consolidated. (Use reverse side of this form if necessary.) \_\_\_\_\_

No allowable will be assigned to the well until all interests have been consolidated (by communitization, unitization, forced-pooling, or otherwise) or until a non-standard unit, eliminating such interests, has been approved by the Commission.

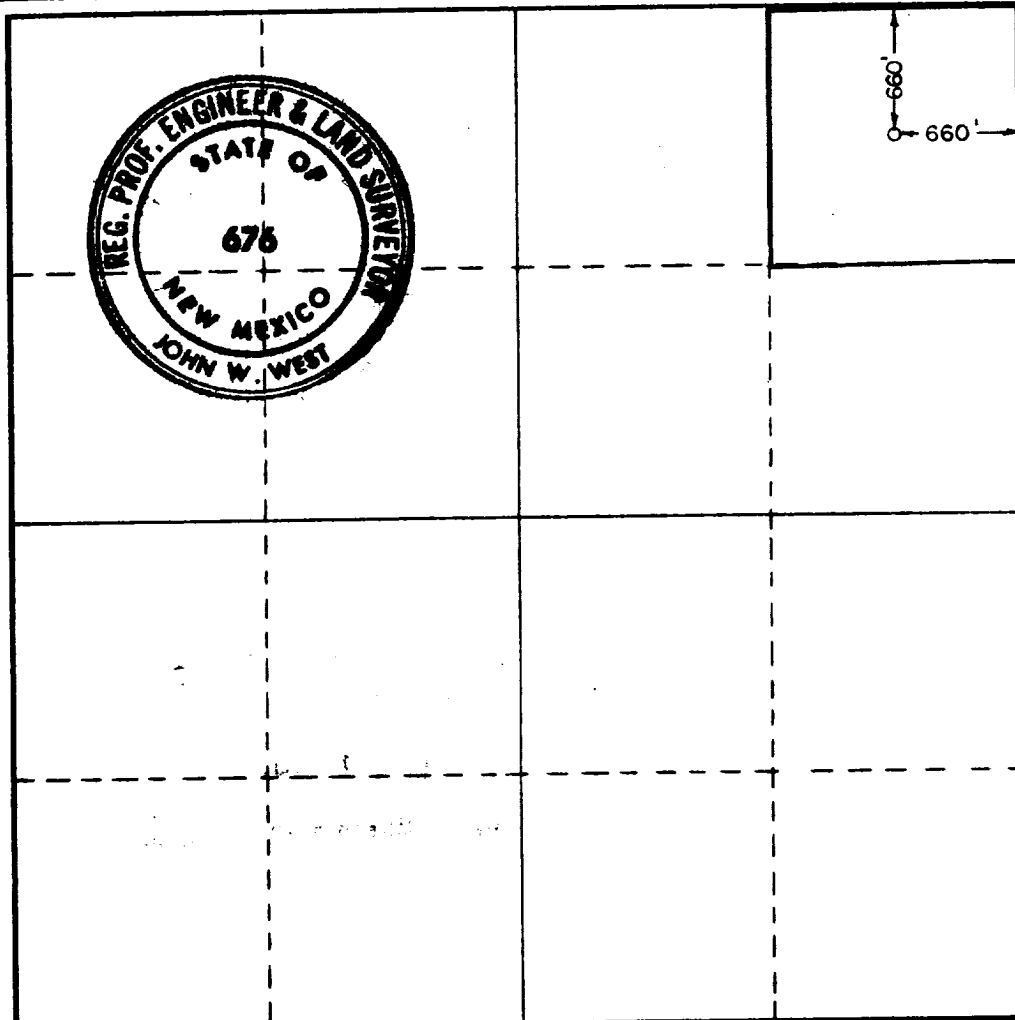

**CERTIFICATION**

I hereby certify that the information contained herein is true and complete to the best of my knowledge and belief.

*Floyd L. Meade*

Name  
**Floyd L. Meade**  
Position  
**District Prod. Supt.**  
Company  
**J.M. Huber Corporation**  
Date  
**May 17, 1971**

I hereby certify that the well location shown on this plat was plotted from field notes of actual surveys made by me or under my supervision, and that the same is true and correct to the best of my knowledge and belief.

Date Surveyed  
**MAY 13, 1971**  
Registered Professional Engineer and/or Land Surveyor

*John W. West*  
Certificate No. **676**

RECEIVED

MAY 10 1971

OIL CONSERVATION COMM.  
HOBBS, N. M.

173