

N.S. OF COPIES RECEIVED	
DISTRIBUTION	
SANTA FE	
FILE	
U.S.G.S.	
LAND OFFICE	
OPERATOR	

NEW MEXICO OIL CONSERVATION COMMISSION

Form C-101
Revised 1-1-65

5A. Indicate Type of Lease STATE <input checked="" type="checkbox"/> FEE <input type="checkbox"/>
5. State Oil & Gas Lease No. K4671
7. Unit Agreement Name
8. Farm or Lease Name State 1-21
9. Well No. 1
10. Field and Pool, or Wildcat Wildcat
12. County Lea
19. Proposed Depth 11,200
19A. Formation Pennsylvanian
20. Rotary or C.T. Rotary
21. Elevations (Show whether DP, RT, etc.) 4330.5 gr
21A. Kind & Status Plug. Bond Blanket
21B. Drilling Contractor Moran Drilling Co.
22. Approx. Date Work will start 5-18-71

APPLICATION FOR PERMIT TO DRILL, DEEPEN, OR PLUG BACK

1a. Type of Work b. Type of Well OIL WELL <input type="checkbox"/> GAS WELL <input type="checkbox"/> OTHER <input type="checkbox"/> DRILL <input checked="" type="checkbox"/> DEEPEN <input type="checkbox"/> PLUG BACK <input type="checkbox"/> SINGLE ZONE <input checked="" type="checkbox"/> MULTIPLE ZONE <input type="checkbox"/>	2. Name of Operator Meadco Properties, Ltd.	3. Address of Operator 407 West Wall Midland, Texas	4. Location of Well UNIT LETTER M LOCATED 660 FEET FROM THE South LINE AND 660 FEET FROM THE West LINE OF SEC. 21 TWP. 14 RGE. 32 NMPM
23. PROPOSED CASING AND CEMENT PROGRAM			

SIZE OF HOLE	SIZE OF CASING	WEIGHT PER FOOT	SETTING DEPTH	SACKS OF CEMENT	EST. TOP
17 1/2"	13 3/8"	H-40 48#	400'	350XX	cir
11"	8 5/8"	24# & 32#	4000'	400XX	1100'
17 7/8"	4 1/2"	N-80	11,200'	1000XX	8500'

APPROVED BY
EXPIRES 5-19-71

1338

IN ABOVE SPACE DESCRIBE PROPOSED PROGRAM; IF PROPOSAL IS TO DEEPEN OR PLUG BACK, GIVE DATA ON PRESENT PRODUCTIVE ZONE AND PROPOSED NEW PRODUCTIVE ZONE. GIVE BLOWOUT PREVENTER PROGRAM, IF ANY.

I hereby certify that the information above is true and complete to the best of my knowledge and belief.

Signed Bill C. Coker Title Owner Date 5-13-71

(This space for State Use)

APPROVED BY [Signature] TITLE SUPERVISOR DATE MAY 19 1971

CONDITIONS OF APPROVAL, IF ANY:

RECEIVED

MAY 10 1971

OIL CONSERVATION COMM.
HOBBS, N. M.

100-11-1A

NEW MICO OIL CONSERVATION COMMISSION
WELL LOCATION AND ACREAGE DEDICATION PLAT

Form C-102
Supersedes C-128
Effective 1-1-65

All distances must be from the outer boundaries of the Section.

Operator MEADCO PROPERTIES, LTD.			Lease STATE /-21		Well No. 1
Unit Letter M	Section 21	Township 14 SOUTH	Range 32 EAST	County LEA	
Actual Footage Location of Well: 660 feet from the SOUTH line and 660 feet from the WEST line					
Ground Level Elev. 4330.5	Producing Formation Pennsylvanian		Pool Wildcat	Dedicated Acreage: 160 40 Acres	

1. Outline the acreage dedicated to the subject well by colored pencil or hachure marks on the plat below.
2. If more than one lease is dedicated to the well, outline each and identify the ownership thereof (both as to working interest and royalty).
3. If more than one lease of different ownership is dedicated to the well, have the interests of all owners been consolidated by communitization, unitization, force-pooling, etc?

☐ Yes ☐ No If answer is "yes," type of consolidation _____

If answer is "no," list the owners and tract descriptions which have actually been consolidated. (Use reverse side of this form if necessary.) _____

No allowable will be assigned to the well until all interests have been consolidated (by communitization, unitization, forced-pooling, or otherwise) or until a non-standard unit, eliminating such interests, has been approved by the Commission.

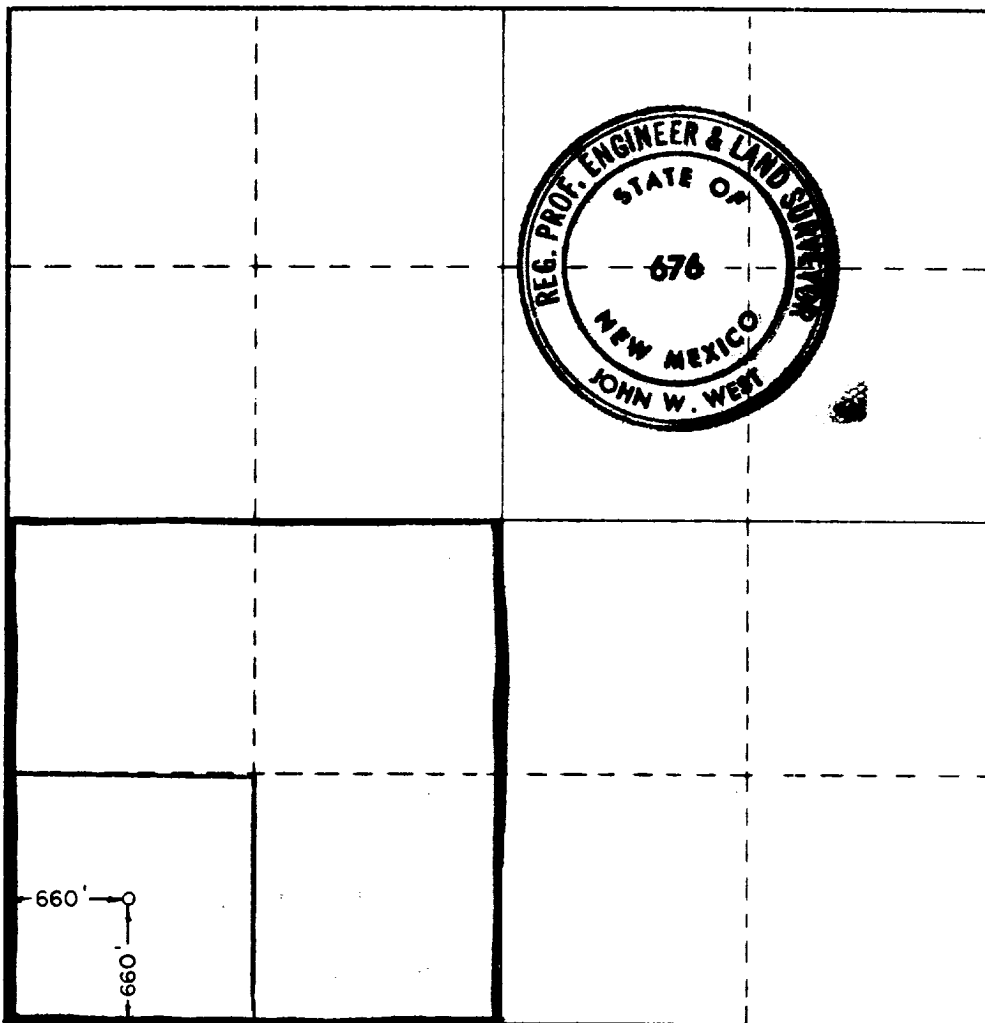

CERTIFICATION

I hereby certify that the information contained herein is true and complete to the best of my knowledge and belief.

Name: John W. West
Position: Owner

Company: Meadco Properties, Ltd.

Date: 5-17-71

I hereby certify that the well location shown on this plat was plotted from field notes of actual surveys made by me or under my supervision, and that the same is true and correct to the best of my knowledge and belief.

Date Surveyed: MAY 12, 1971

Registered Professional Engineer and/or Land Surveyor

John W. West
Certificate No. **676**

0 330 660 990 1320 1650 1980 2310 2640 2970 3300 3630 3960 4290 4620 4950 5280 5610 5940 6270 6600

113

RECEIVED

MAY 1 1971

OIL CONSERVATION COMM.
HOBBS, N. M.