

NO. OF COPIES RECEIVED	
DISTRIBUTION	
SANTA FE	
FILE	
U.S.G.S.	
LAND OFFICE	
OPERATOR	

NEW MEXICO OIL CONSERVATION COMMISSION

Form C-101
Revised 1-1-65

5A. Indicate Type of Lease	
STATE <input type="checkbox"/>	FEE <input checked="" type="checkbox"/>

5. State Oil & Gas Lease No.

APPLICATION FOR PERMIT TO DRILL, DEEPEN, OR PLUG BACK

1a. Type of Work		7. Unit Agreement Name	
b. Type of Well DRILL <input checked="" type="checkbox"/> DEEPEN <input type="checkbox"/> PLUG BACK <input type="checkbox"/> OIL WELL <input checked="" type="checkbox"/> GAS WELL <input type="checkbox"/> OTHER <input type="checkbox"/> SINGLE ZONE <input type="checkbox"/> MULTIPLE ZONE <input type="checkbox"/>		8. Farm or Lease Name J. A. Foster	
2. Name of Operator Skelly Oil Company		9. Well No. 1	
3. Address of Operator P. O. Box 1351, Midland, Texas 79701		10. Field and Pool, or Wildcat Undesignated McDonald Penn	
4. Location of Well UNIT LETTER I LOCATED 660 FEET FROM THE East LINE AND 1980' FEET FROM THE South LINE OF SEC. 4 TWP. 14S RGE. 36E NMPM		12. County Lea	
19. Proposed Depth 10,500'		19A. Formation Cisco Reef	
20. Rotary or C.T. Rotary			
21. Elevations (Show whether DE, RT, etc.) Unknown		21A. Kind & Status Plug, Bond Blanket Bond #1253688 \$100,000	
21B. Drilling Contractor Hondo Drilling Co.		22. Approx. Date Work will start Immediately	

23. w/ Fed. Ins. Co. PROPOSED CASING AND CEMENT PROGRAM

SIZE OF HOLE	SIZE OF CASING	WEIGHT PER FOOT	SETTING DEPTH	SACKS OF CEMENT	EST. TOP
17"	13-3/8"	54.50#	425'	450	Surface
11"	8-5/8"	32#	4600'	2000	Surface
7-7/8"	5-1/2"	17 & 20#	10,500'	400	8600'

The pump and plug process will be used in cementing all strings of casing and cement will be circulated to surface on the 13-3/8" and 8-5/8" casing. The 5-1/2" will be perforated at approximately 10,480-10,500' and will be stimulated. BOP will be installed and tested to 1500 psi, on the surface casing. Mud program will be brine water to intermediate casing point and fresh water mud approximately 9# 36 Viscosity water loss 10 FC 2/32, 4% oil.

8-22-72

IN ABOVE SPACE DESCRIBE PROPOSED PROGRAM: IF PROPOSAL IS TO DEEPEN OR PLUG BACK, GIVE DATA ON PRESENT PRODUCTIVE ZONE AND PROPOSED NEW PRODUCTIVE ZONE. GIVE BLOWOUT PREVENTER PROGRAM, IF ANY.

I hereby certify that the information above is true and complete to the best of my knowledge and belief.

Signed (Signed) C. J. LOVE Title District Production Manager Date May 19, 1972

(This space for State Use)

APPROVED BY [Signature] TITLE SUPERVISOR DISTRICT I DATE MAY 22 1972

CONDITIONS OF APPROVAL, IF ANY:

RECEIVED

MAY 22 1972

OIL CONSERVATION COMM.
HOBBS, N. M.

NOV 14 1971

NEW MEXICO OIL CONSERVATION COMMISSION
WELL LOCATION AND ACREAGE DEDICATION PLAT

Form C-102
Supersedes C-128
Effective 1-1-65

All distances must be from the outer boundaries of the Section.

Operator SKELLY OIL COMPANY		Lease J. A. FOSTER		Well No. 1
Unit Letter I	Section 4	Township 14 SOUTH	Range 36 EAST	County LEA
Actual Footage Location of Well: 1980 feet from the SOUTH line and 660 feet from the EAST line				
Ground Level Elev. 3948'	Producing Formation Cisco Reef	Pool Undesignated McDonald Penn	Dedicated Acreage: 40 Acres	

1. Outline the acreage dedicated to the subject well by colored pencil or hachure marks on the plat below.
2. If more than one lease is dedicated to the well, outline each and identify the ownership thereof (both as to working interest and royalty).
3. If more than one lease of different ownership is dedicated to the well, have the interests of all owners been consolidated by communitization, unitization, force-pooling, etc?

☐ Yes ☐ No If answer is "yes," type of consolidation _____

If answer is "no," list the owners and tract descriptions which have actually been consolidated. (Use reverse side of this form if necessary.) _____

No allowable will be assigned to the well until all interests have been consolidated (by communitization, unitization, forced-pooling, or otherwise) or until a non-standard unit, eliminating such interests, has been approved by the Commission.

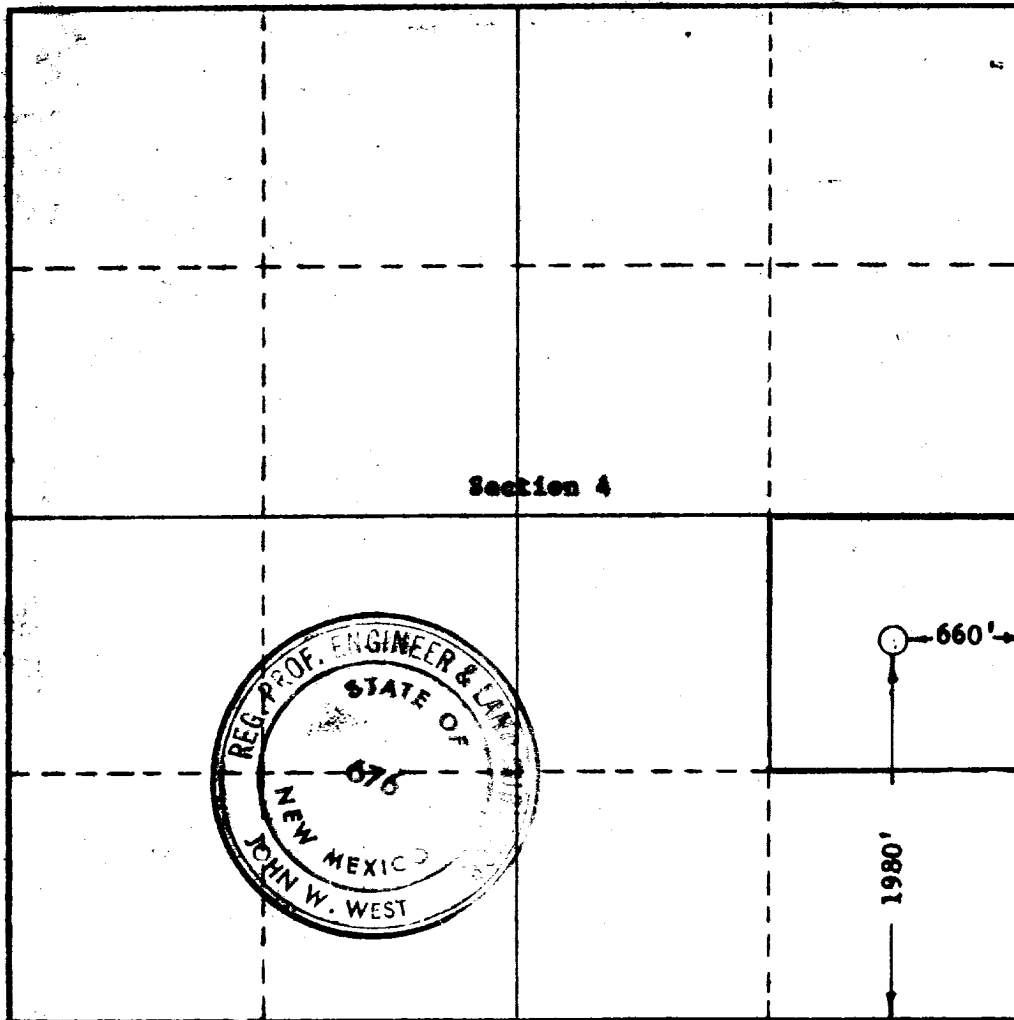

CERTIFICATION

I hereby certify that the information contained herein is true and complete to the best of my knowledge and belief.

Name **J. E. Avant**
Position **District Administrative Coord.**

Company **Skelly Oil Company**

Date **May 20, 1972**

I hereby certify that the well location shown on this plat was plotted from field notes of actual surveys made by me or under my supervision, and that the same is true and correct to the best of my knowledge and belief.

Date Surveyed
MAY 19, 1972

Registered Professional Engineer
and/or Land Surveyor

John W. West
Certificate No. **676**



