

NO. OF COPIES RECEIVED	
DISTRIBUTION	
SANTA FE	
FILE	
U.S.G.S.	
LAND OFFICE	
OPERATOR	

NEW MEXICO OIL CONSERVATION COMMISSION

Form C-101
Revised 1-1-65

5A. Indicate Type of Lease STATE <input checked="" type="checkbox"/> FEE <input type="checkbox"/>
5. State Oil & Gas Lease No. E-6386
7. Unit Agreement Name
8. Farm or Lease Name Cabot State
9. Well No. 1
10. Field and Pool, or Wildcat Wildcat
12. County Lea
18. Proposed Depth 12,500
19A. Formation Devonian
20. Rotary or C.T. Rotary
21. Elevations (Show whether DE, RT, etc.) 4344 SL
21A. Kind & Status Plug, Bond One Well Plugging
21B. Drilling Contractor
22. Approx. Date Work will start June 15, 1973

APPLICATION FOR PERMIT TO DRILL, DEEPEN, OR PLUG BACK			
1a. Type of Work DRILL <input checked="" type="checkbox"/> DEEPEN <input type="checkbox"/> PLUG BACK <input type="checkbox"/>			
b. Type of Well OIL WELL <input checked="" type="checkbox"/> GAS WELL <input type="checkbox"/> OTHER <input type="checkbox"/> SINGLE ZONE <input checked="" type="checkbox"/> MULTIPLE ZONE <input type="checkbox"/>			
2. Name of Operator C. E. Juni			
3. Address of Operator 2104 North "H" Street, Midland, Texas 79701			
4. Location of Well UNIT LETTER H LOCATED 600 FEET FROM THE East LINE AND 1000 FEET FROM THE North LINE OF SEC. 20 TWP. 13 N RGE. 20 E NMPM			
23. PROPOSED CASING AND CEMENT PROGRAM			

SIZE OF HOLE	SIZE OF CASING	WEIGHT PER FOOT	SETTING DEPTH	SACKS OF CEMENT	EST. TOP
17 1/2	12 5/8	54.5	200	400	6190
11 5/8	8 5/8	24-25-26	4000	300	5900
7 7/8	4 1/2	11.6 & 13.50	12300	400	12000

IN ABOVE SPACE DESCRIBE PROPOSED PROGRAM: IF PROPOSAL IS TO DEEPEN OR PLUG BACK, GIVE DATA ON PRESENT PRODUCTIVE ZONE AND PROPOSED NEW PRODUCTIVE ZONE. GIVE BLOWOUT PREVENTER PROGRAM, IF ANY.

I hereby certify that the information above is true and complete to the best of my knowledge and belief.

Signed C. E. Juni Title Operator Date June 14, 1973

(This space for State Use)

APPROVED BY John A. Ranyard TITLE _____ DATE _____

CONDITIONS OF APPROVAL, IF ANY:

RECEIVED

JUL 1 1978

U.S. CONSERVATION COMMISSION
HONOLULU, HAWAII

**NEW MEXICO OIL CONSERVATION COMMISSION
WELL LOCATION AND ACREAGE DEDICATION PLAT**

Form C-102
Supersedes C-128
Effective 1-1-65

All distances must be from the outer boundaries of the Section.

Operator C. H. JUNI			Lease CABOT STATE		Well No. 1
Unit Letter H	Section 29	Township 13 SOUTH	Range 32 EAST	County LEA	
Actual Footage Location of Well: <div style="display: flex; justify-content: space-between;"> 1980 feet from the NORTH line and 660 feet from the EAST line </div>					
Ground Level Elev. 4344	Producing Formation DEVONIAN	Pool WILDCAT	Dedicated Acreage: 40.80 Acres		

1. Outline the acreage dedicated to the subject well by colored pencil or hatchure marks on the plat below.
2. If more than one lease is dedicated to the well, outline each and identify the ownership thereof (both as to working interest and royalty).
3. If more than one lease of different ownership is dedicated to the well, have the interests of all owners been consolidated by communitization, unitization, force-pooling, etc?

☐ Yes ☐ No If answer is "yes," type of consolidation _____

If answer is "no," list the owners and tract descriptions which have actually been consolidated. (Use reverse side of this form if necessary.) _____

No allowable will be assigned to the well until all interests have been consolidated (by communitization, unitization, forced-pooling, or otherwise) or until a non-standard unit, eliminating such interests, has been approved by the Commission.

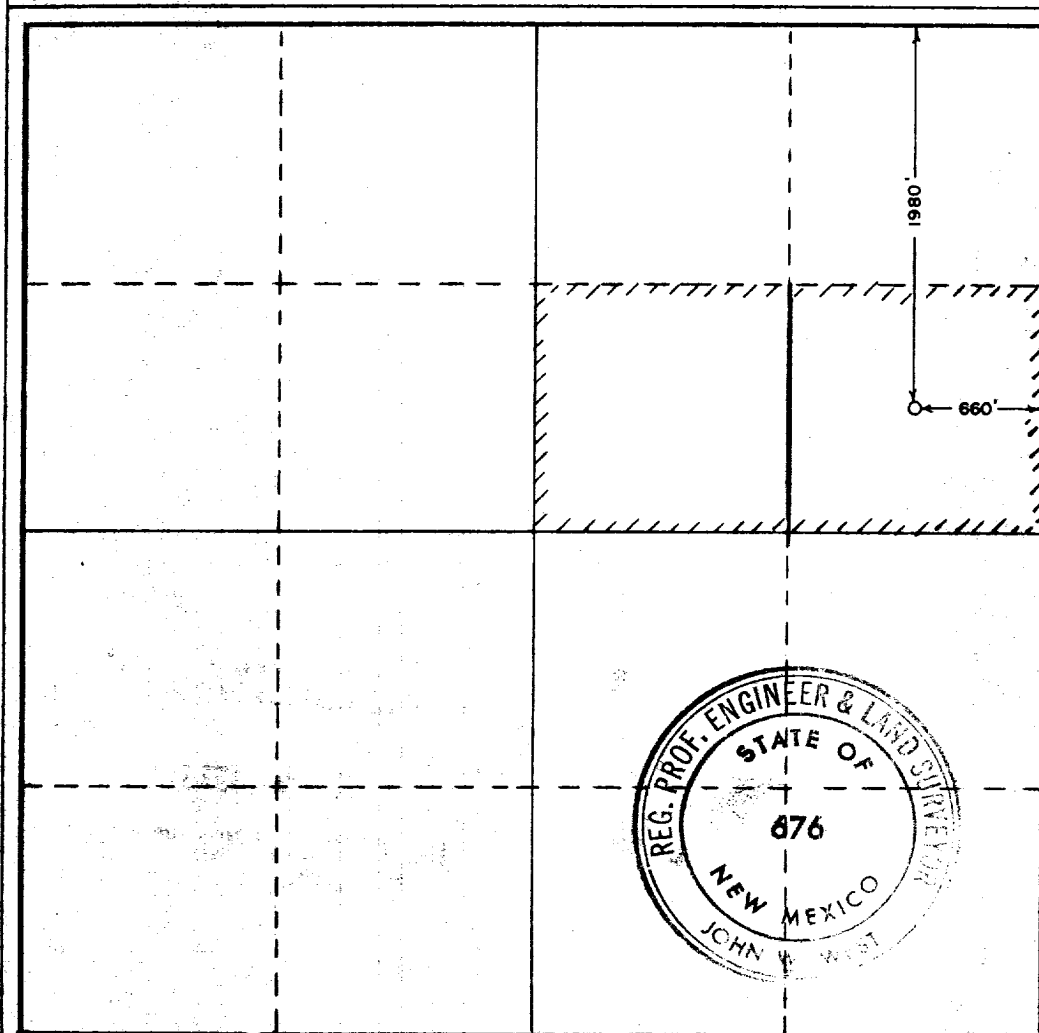

CERTIFICATION

I hereby certify that the information contained herein is true and complete to the best of my knowledge and belief.

C. H. Juni
 Name **C. H. JUNI**
 Position **OPERATOR**
 Company **C. H. JUNI**
 Date **JUNE 14, 1973**

I hereby certify that the well location shown on this plat was plotted from field notes of actual surveys made by me or under my supervision, and that the same is true and correct to the best of my knowledge and belief.

Date Surveyed **JUNE 9, 1973**
 Registered Professional Engineer and/or Land Surveyor
John W West
 Certificate No. **676**



RECEIVED

JUN 14 1973

OIL CONSERVATION CO. INC.
MOBILE, ALA.

117