

NO. OF COPIES RECEIVED	
DISTRIBUTION	
SANTA FE	
FILE	
U.S.G.S.	
LAND OFFICE	
OPERATOR	

NEW MEXICO OIL CONSERVATION COMMISSION

Form C-101
Revised 1-1-65

5A. Indicate Type of Lease	
STATE <input type="checkbox"/>	FEE <input checked="" type="checkbox"/>
5. State Oil & Gas Lease No.	
7. Unit Agreement Name	
8. Farm or Lease Name	
Craig	
9. Well No.	
1	
10. Field and Pool, or Wildcat	
Wildcat	
12. County	
Lea	
19. Proposed Depth	19A. Formation
13,550'	Devonian
20. Rotary or C.T.	
Rotary	
21. Elevations (Show whether DF, RT, etc.)	21A. Kind & Status Plug, Bond
3906.7' Ground Level	Blanket
21B. Drilling Contractor	22. Approx. Date Work will start
Big West Drilling Co.	April 24, 1974

APPLICATION FOR PERMIT TO DRILL, DEEPEN, OR PLUG BACK

1a. Type of Work	
b. Type of Well	
DRILL <input checked="" type="checkbox"/>	DEEPEN <input type="checkbox"/>
PLUG BACK <input type="checkbox"/>	
OIL WELL <input checked="" type="checkbox"/>	GAS WELL <input type="checkbox"/>
OTHER <input type="checkbox"/>	
SINGLE ZONE <input checked="" type="checkbox"/>	
MULTIPLE ZONE <input type="checkbox"/>	
2. Name of Operator	
J.M. Huber Corporation	
3. Address of Operator	
1900 Wilco Building, Midland, Texas 79701	
4. Location of Well	
UNIT LETTER P	LOCATED 660'
FEET FROM THE South LINE	
AND 660	FEET FROM THE East
LINE OF SEC. 21 TWP. 12S RGE. 37E NMPM	

23. PROPOSED CASING AND CEMENT PROGRAM

SIZE OF HOLE	SIZE OF CASING	WEIGHT PER FOOT	SETTING DEPTH	SACKS OF CEMENT	EST. TOP
17-1/2"	13-3/8"	48#	400'	400	Circulate
12-1/4"	9-5/8"	36#	4,500'	350	Est. 3000'
8-3/4"	5-1/2"	15.5 & 17#	13,550'	600	Est. 10,000'

Drill 17½" hole to 400', set 13-3/8" 48#, H-40, ST&C casing. Cement with 400 sx Class "C" cement circulated to surface. Install 13-3/8" x 12" 600 Series Casinghead. W.O.C. 18 hours. Test 13-3/8" casing to 1000 psi. Drill 12¼" hole to 4500', set 9-5/8" 36#, K-55, ST&C casing. Cement with 350 sx Class "C" cement. Run temperature survey 8 hours after plug is down. W.O.C. 18 hours. Install Secondary Seal, 12" 600 Series x 10" 900 Series Casing Spool. Nipple up BOP, Hydril and Rotating Head. Test BOP's and 9-5/8" casing to 2000 psi. Drill 8-3/4" hole to T.D. of 13,550'. Log and evaluate all DST's to determine feasibility of running 5½" 15.5#, K-55, 17#, K-55 and S-95 production casing.

APPROVAL VALID
FOR 90 DAYS UNLESS
DRILLING COMMENCED,

EXPIRES 7-18-74

IN ABOVE SPACE DESCRIBE PROPOSED PROGRAM: IF PROPOSAL IS TO DEEPEN OR PLUG BACK, GIVE DATA ON PRESENT PRODUCTIVE ZONE AND PROPOSED NEW PRODUCTIVE ZONE. GIVE BLOWOUT PREVENTER PROGRAM, IF ANY.

I hereby certify that the information above is true and complete to the best of my knowledge and belief.

Signed James R. Sutherland Title District Production Manager Date April 16, 1974

(This space for State Use)

APPROVED BY [Signature] TITLE SUPERVISOR DISTRICT I DATE APR 17 1974

CONDITIONS OF APPROVAL, IF ANY:

NEW MEXICO OIL CONSERVATION COMMISSION
WELL LOCATION AND ACREAGE DEDICATION PLAT

Form C-102
Supersedes C-128
Effective 1-1-65

All distances must be from the outer boundaries of the Section.

Operator J. M. HUBER CORP.			Lease CRAIG		Well No. 1
Unit Letter P	Section 21	Township 12 SOUTH	Range 37 EAST	County LEA	
Actual Footage Location of Well: 660 feet from the SOUTH line and 660 feet from the EAST line					
Ground Level Elev. 3906.7	Producing Formation DEVONIAN		Pool WILDCAT	Dedicated Acreage: 80 Acres	

1. Outline the acreage dedicated to the subject well by colored pencil or hatchure marks on the plat below.
2. If more than one lease is dedicated to the well, outline each and identify the ownership thereof (both as to working interest and royalty).
3. If more than one lease of different ownership is dedicated to the well, have the interests of all owners been consolidated by communitization, unitization, force-pooling, etc?

☒ Yes ☐ No If answer is "yes," type of consolidation **FORCED POOLING**

NMOCC CASE NO. 5195

If answer is "no," list the owners and tract descriptions which have actually been consolidated. (Use reverse side of this form if necessary.) _____

No allowable will be assigned to the well until all interests have been consolidated (by communitization, unitization, forced-pooling, or otherwise) or until a non-standard unit, eliminating such interests, has been approved by the Commission.

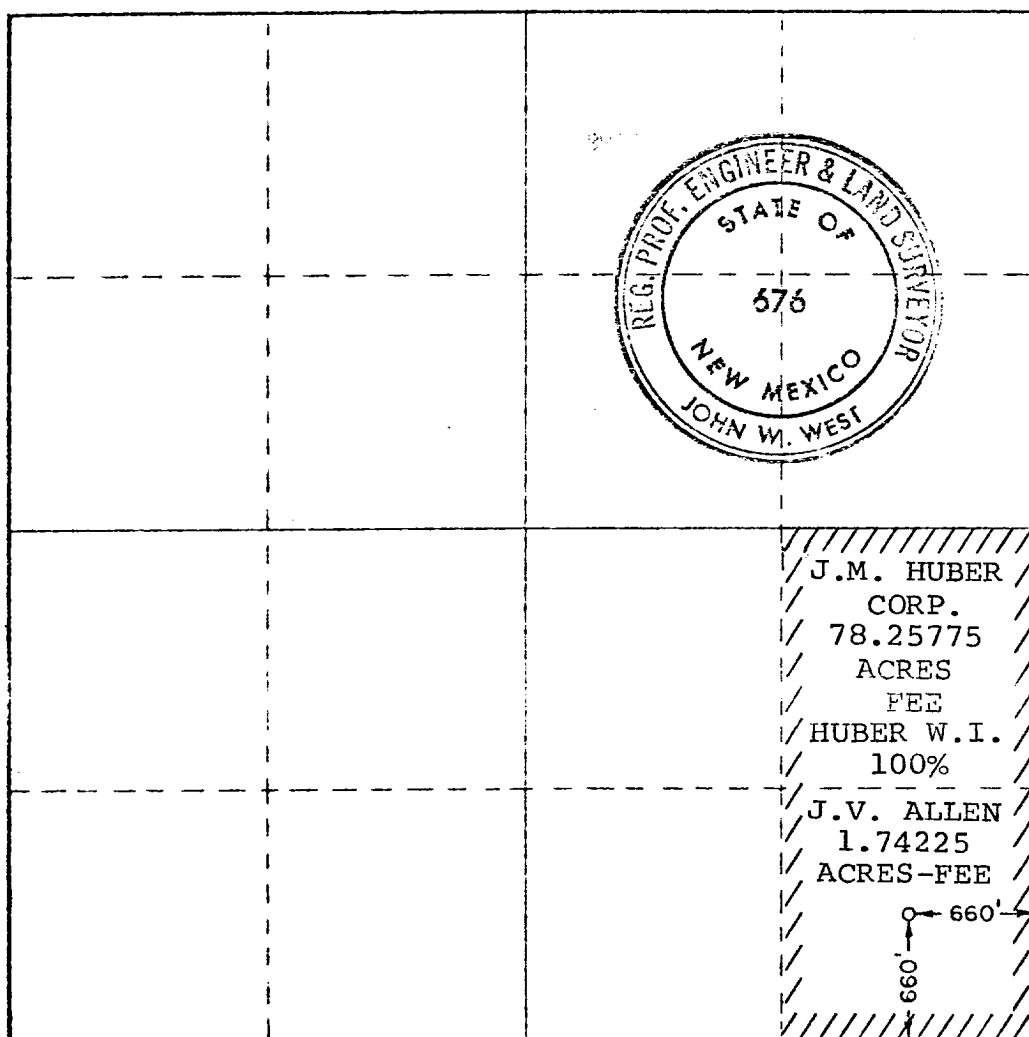

CERTIFICATION

I hereby certify that the information contained herein is true and complete to the best of my knowledge and belief.

James R. Sutherland

Name
James R. Sutherland

Position
District Prod. Manager

Company
J.M. Huber Corporation

Date
April 15, 1974

I hereby certify that the well location shown on this plat was plotted from field notes of actual surveys made by me or under my supervision, and that the same is true and correct to the best of my knowledge and belief.

Date Surveyed
APRIL 11, 1974

Registered Professional Engineer and/or Land Surveyor

John W. West
Certificate No. **676**

