

NO. OF COPIES RECEIVED	
DISTRIBUTION	
SANTA FE	
FILE	
U.S.G.S.	
LAND OFFICE	
OPERATOR	

# NEW MEXICO OIL CONSERVATION COMMISSION

Form C-101  
Revised 1-1-65

5A. Indicate Type of Lease	
STATE <input type="checkbox"/>	FEE <input checked="" type="checkbox"/>
5. State Oil & Gas Lease No.	

## APPLICATION FOR PERMIT TO DRILL, DEEPEN, OR PLUG BACK

1a. Type of Work		7. Unit Agreement Name	
b. Type of Well OIL WELL <input checked="" type="checkbox"/> GAS WELL <input type="checkbox"/> OTHER <input type="checkbox"/>		8. Farm or Lease Name Huber-Griffin	
2. Name of Operator Samedan Oil Corporation		9. Well No. 1	
3. Address of Operator 2207 Wilco Building, Midland, Texas 79701		10. Field and Pool, or Wildcat McDonald (Wolfcamp)	
4. Location of Well UNIT LETTER B LOCATED 660 FEET FROM THE North LINE AND 1750 FEET FROM THE East LINE OF SEC. 4 TWP. 14-S RGE. 36-E NMPM		12. County Lea	
19. Proposed Depth 10,500'		19A. Formation Wolfcamp	
20. Rotary or C.T. Rotary		21. Elevations (Show whether DF, RT, etc.) 3949.9' G.L.	
21A. Kind & Status Plug. Bond Blanket O.K.		21B. Drilling Contractor MGF Drilling Company	
22. Approx. Date Work will start 11-1-74			

### PROPOSED CASING AND CEMENT PROGRAM

SIZE OF HOLE	SIZE OF CASING	WEIGHT PER FOOT	SETTING DEPTH	SACKS OF CEMENT	EST. TOP
17 1/2"	12 3/4"	34	470'	Circ. to surface	
11"	8 5/8"	24 & 34	470'	100 sx.	
7 7/8"	5 1/2"	17	10,500'	250 sx.	

Plan to drill and run casing; as outlined above. (GUTs may be run on any formation indicating production during the drilling stage.) If production is indicated, will complete in productive zone(s) according to Rules and Regulations of New Mexico Oil Conservation Commission. All pipe-setting operations will be conducted according to requirements of the proper authorities.

APPROVAL VALID  
FOR 10 DAYS UNLESS  
DRILLING COMMENCED,

EXPIRES 1-23-75

IN ABOVE SPACE DESCRIBE PROPOSED PROGRAM: IF PROPOSAL IS TO DEEPEN OR PLUG BACK, GIVE DATA ON PRESENT PRODUCTIVE ZONE AND PROPOSED NEW PRODUCTIVE ZONE. GIVE BLOWOUT PREVENTER PROGRAM, IF ANY.

I hereby certify that the information above is true and complete to the best of my knowledge and belief.

Signed William S. McCuen Title Production Superintendent Date 10-21-74

(This space for State Use)  
APPROVED BY [Signature] TITLE \_\_\_\_\_ DATE \_\_\_\_\_  
CONDITIONS OF APPROVAL, IF ANY:

NEW MEXICO OIL CONSERVATION COMMISSION  
WELL LOCATION AND ACREAGE DEDICATION PL

Revised 10/1/73  
Supersedes 10/1/73  
11/1/73

All distances must be from the outer boundaries of the Section

Samedan Oil Corporation			Huber Griffin		
Tract Letter <b>B</b>	Section <b>4</b>	Range <b>14 South</b>	Range <b>36 East</b>	Lea	
Actual Survey Location of Well					
<b>660</b>		feet from the <b>North</b>	line and	<b>1750</b>	feet from the <b>East</b>
Ground surface elev <b>3949.9</b>		Production formation <b>Wolfcamp</b>		Acres <b>McDonald (Wolfcamp) 40</b>	

- 1 Outline the acreage dedicated to the subject well by colored pencil or hatchure marks on the plat below
- 2 If more than one lease is dedicated to the well outline each and identify the ownership there of (state as to who is interest and royalty).
- 3 If more than one lease of different ownership is dedicated to the well, have the interests of all owners been consolidated by communitization, unitization, forced-pooling, etc?

☐ Yes ☐ No If answer is "yes," type of consolidation \_\_\_\_\_

If answer is "no," list the owners and tract descriptions which have actually been consolidated (if so reverse side of this form if necessary.) \_\_\_\_\_

No allowable will be assigned to the well until all interests have been consolidated (by communitization, unitization, forced-pooling, or otherwise) or until a non-standard unit, eliminating such interests, has been approved by the Commission.

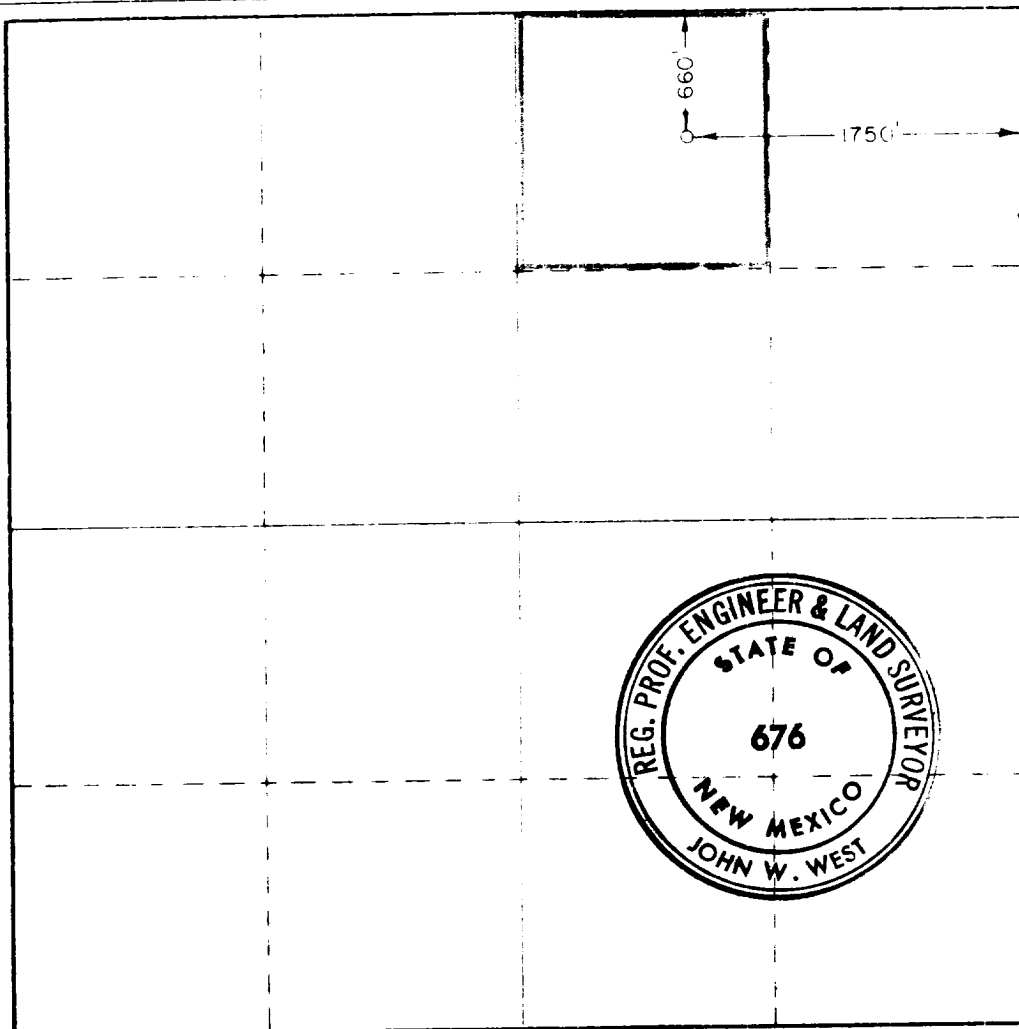

CERTIFICATION

I hereby certify that the information contained herein is true and complete to the best of my knowledge and belief.

*William S. McCuen*

William S. McCuen

Prod. Supt,

Samedan Oil Corporation

10-21-74

I hereby certify that the well location shown on this plat was plotted from field notes of actual surveys made by me or under my supervision and that the same is true and correct to the best of my knowledge and belief.

Date of Survey

October 18, 1974

Registered Professional Engineer and Land Surveyor

*John W. West*

Certificate No.

676

0 330 660 990 1320 1650 1980 2310 2640 2970 3300 3630 3960 4290 4620 4950 5280 5610 5940 6270 6600